

**Request for Service**

Select Language ▼

[Sign in](#), or [create an account](#) to receive updates on your request.

We will remember what you've entered here

**Details** | Location | Contact Info

If you don't find your topic within the following drop down menu select 'OTHER'.

Type of Issue \*

Search or select a type ▼

- ▶ Stormwater
- ▶ Street Lights
- ▼ Suggest a Project
  - Add A Flashing Crosswalk
  - Add A New Crosswalk
  - Transportation Project
  - Television - Kirkland Channels

6" SOLID WHITE LI  
1' FROM EDGE OF  
PAVEMENT (100')

**Q: Can on-street parking be eliminated to make room for bike lanes?**

A: Possibly. The Neighborhood Safety Program is a possible process.

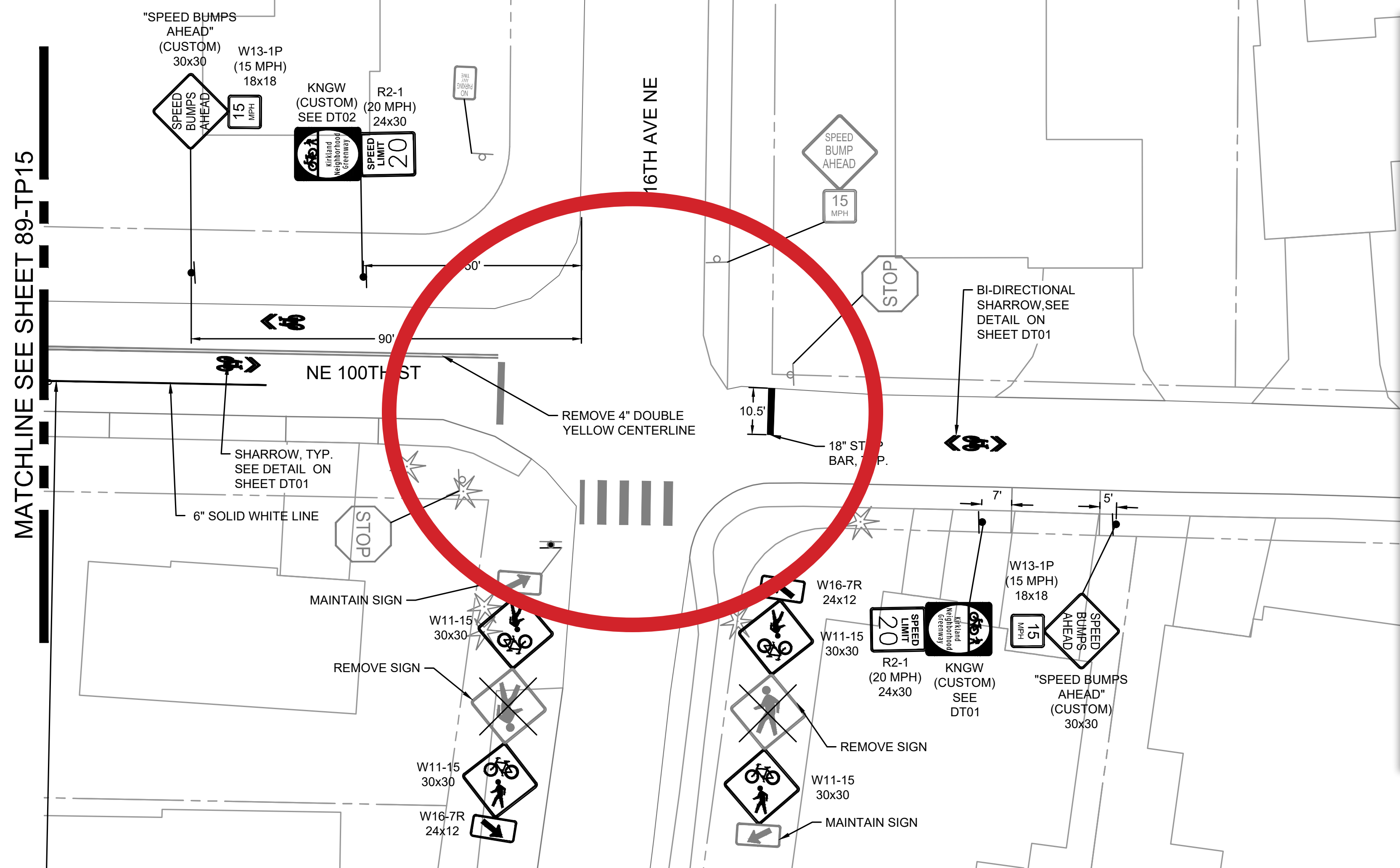

### Request for Service

Select Language ▼

[Sign in](#), or [create an account](#) to receive updates on your request.

We will remember what you've entered here

Details Location Contact Info

If you don't find your topic within the following drop down menu select 'OTHER'.

Type of Issue \*

Search or select a type ▼

- Stormwater
- Street Lights
- Suggest a Project
  - Add A Flashing Crosswalk
  - Add A New Crosswalk
  - Transportation Project
  - Television - Kirkland Channels

**Q: Could we get a four-way stop at the intersection of Northeast 100th Street and 116th Avenue Northeast?**

**A:** Possibly, but requires transportation engineering analysis.



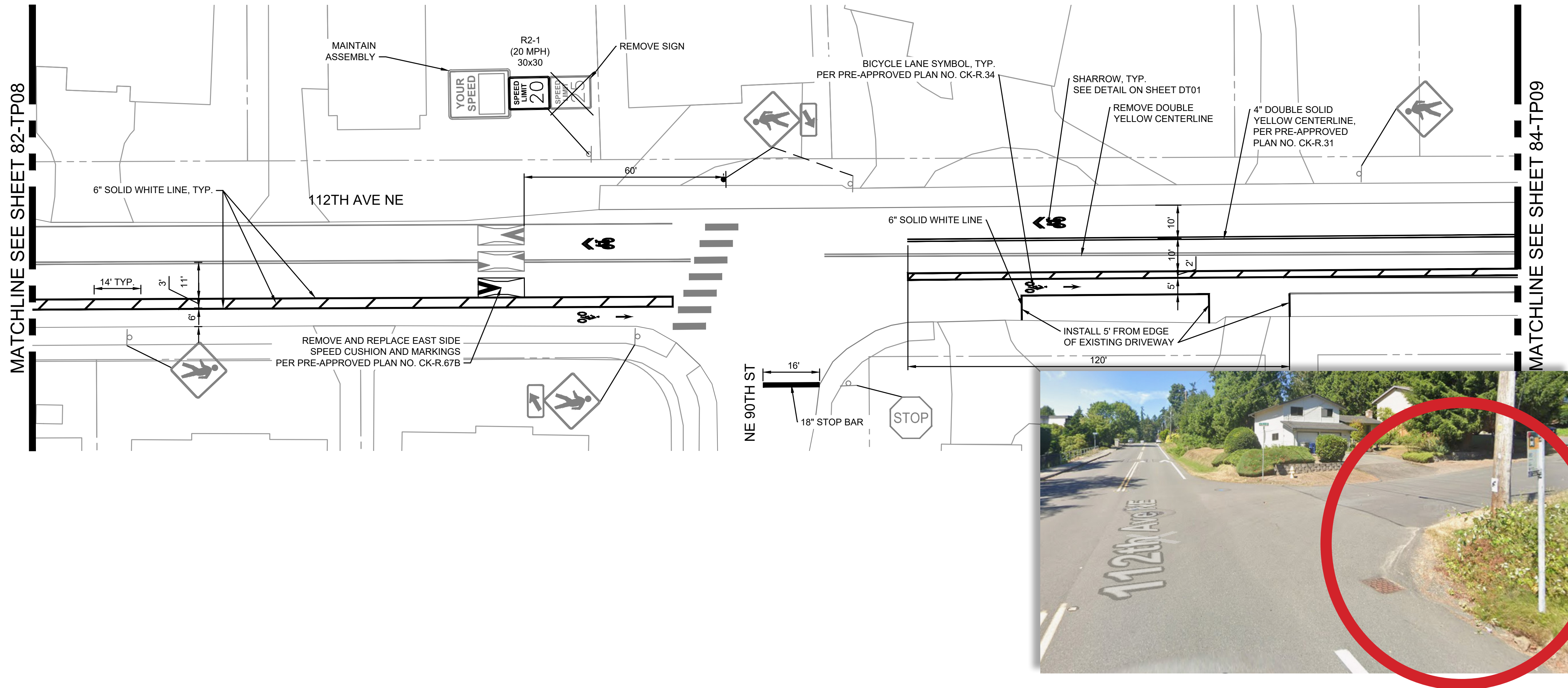

**Q: Why does the center-lane shift at Northeast 90th Street?**

A: To minimize the bicycle lane's conflict with a catch-basin and bus stop.

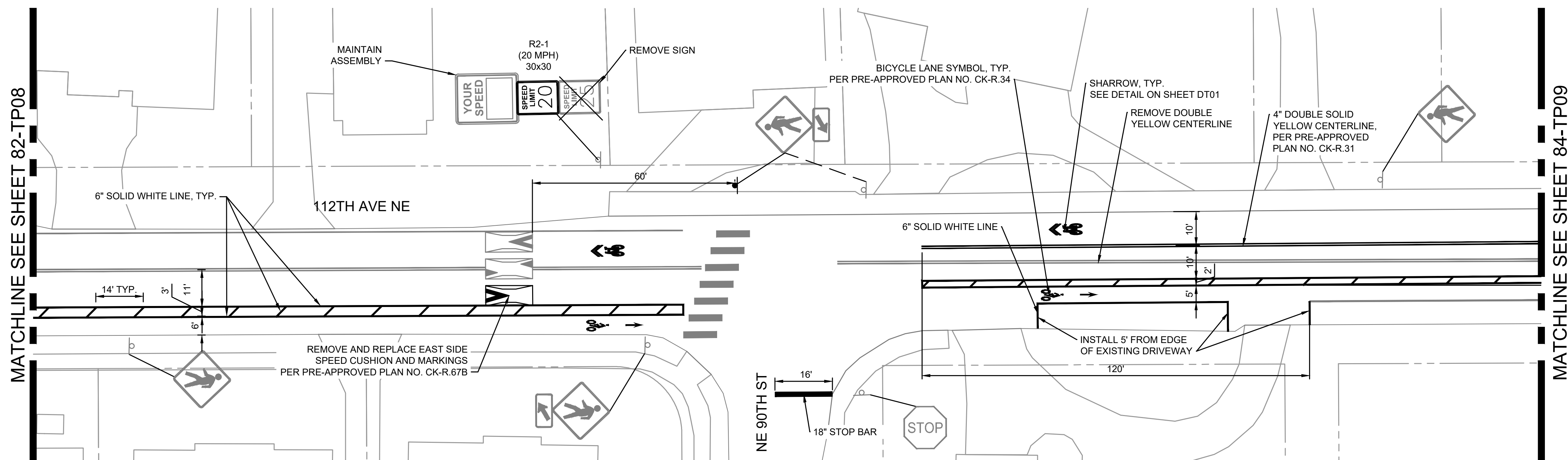

**Q1: Can bike lanes be better?** *(provide physical barrier & prevent swerving)*

A: Yes! Delineators or extruded curb could provide a physical buffer and prevent cars from swerving around speed cushions.

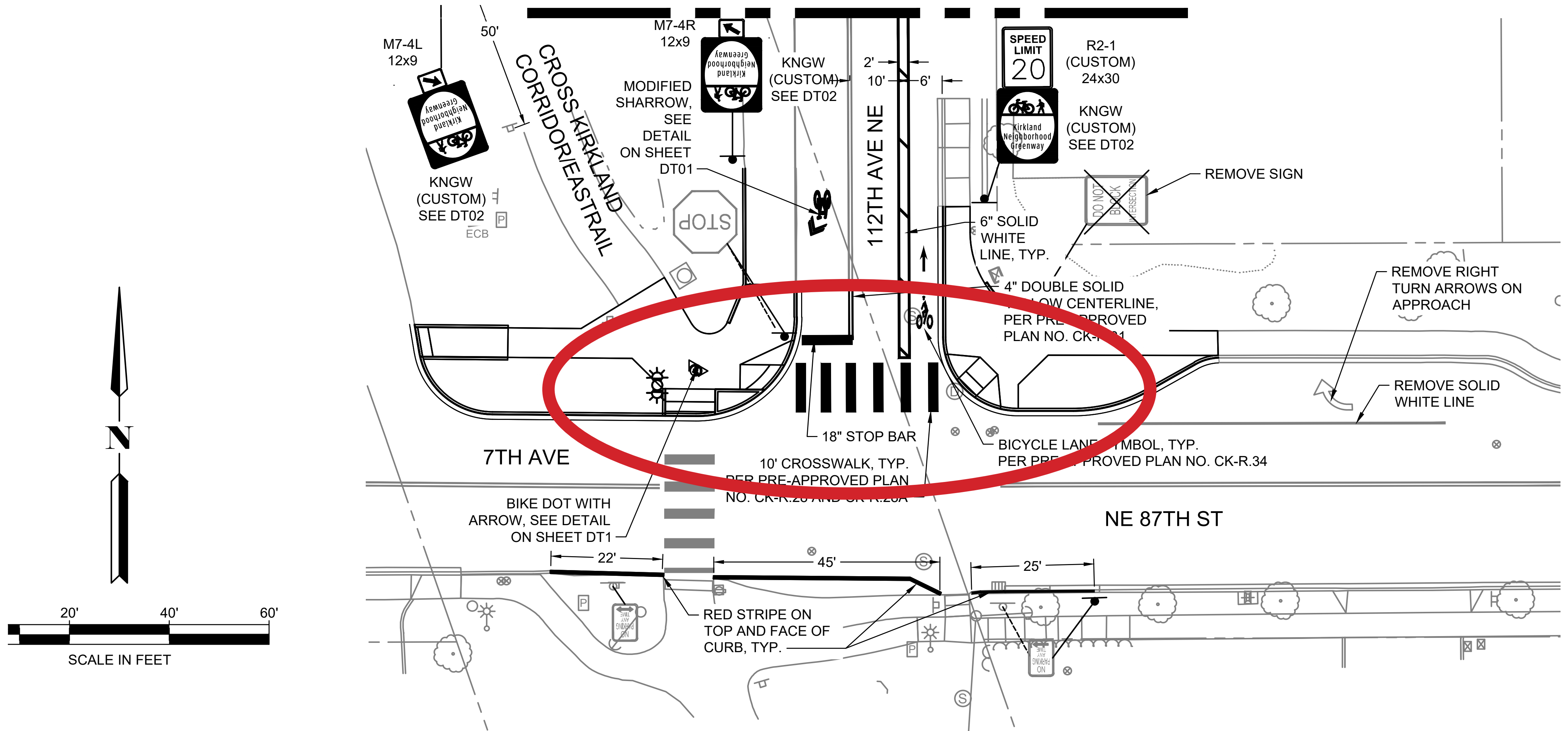

**Q: Do we get a crosswalk?**

**A: Yes!**



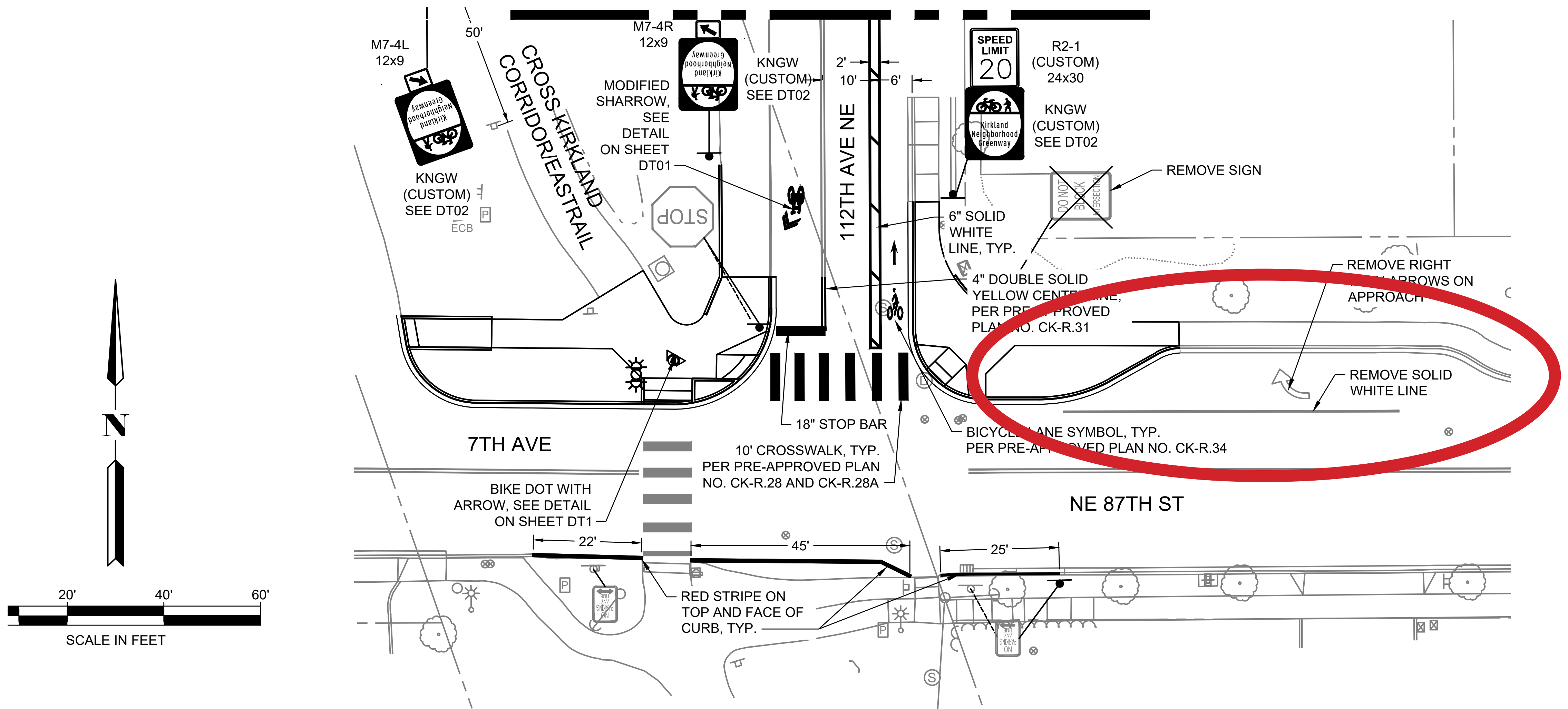

**Q: What will happen to right-turn lane on northeast corner?**

**A: Parking!**

A: Technically, yes, but you've got a lot of work to do.

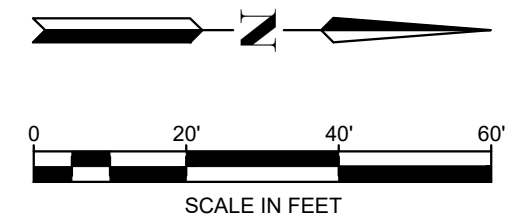

- ### **CHANNELIZATION AND SIGNING NOTES:**
1. ALL EXISTING PAVEMENT MARKINGS IN CONFLICT WITH PROPOSED MARKINGS TO BE REMOVED UNLESS OTHERWISE NOTED ON PLANS.
  2. ALL DIMENSIONS ARE IN FEET, UNLESS OTHERWISE NOTED.
  3. FIELD VERIFICATION OF DIMENSIONS IS REQUIRED PRIOR TO INSTALLATION
  4. SEE G SHEET SERIES FOR GENERAL NOTES AND LEGEND.
  5. SEE DT SHEET SERIES FOR PAVEMENT MARKING AND SIGNAGE DETAILS.
  6. SEE CD SHEET SERIES FOR TREE PROTECTION, TREE AND VEGETATION TRIMMING
  7. SEE PV SHEET SERIES FOR PAVING AND GRADING PLANS.
  8. SEE GW SHEET SERIES FOR OVERVIEW PLANS SHOWING SITE PREPARATION, CHANNELIZATION AND SIGNAGE NOT INCLUDED ON THE SP AND CH PLANS .
  9. SIGN AND SYMBOL MARKING LOCATIONS SHALL BE VERIFIED BY THE ENGINEER PRIOR TO INSTALLATION. LOCATIONS SHOWN ARE APPROXIMATE ONLY. ACTUAL LOCATIONS SHALL BE DETERMINED IN THE FIELD BASED ON CONDITIONS. SIGNS SHALL NOT BE PLACED TO CONFLICT WITH DRIVEWAYS, UTILITIES, OR VEGETATION. SIGNS SHALL NOT BE PLACED WHERE SIGHT LINES TO THE SIGN ARE BLOCKED BY TREES.
  10. SIGNS NOTED "TO BE REMOVED" SHALL INCLUDE REMOVAL AND SALVAGE OF SIGN AND POST PER SPECIFICATIONS UNLESS OTHERWISE NOTED.
  11. REPLACE ALL R2-25 "25 SPEED LIMIT" SIGNS WITH R2-20 "20 SPEED LIMIT" SIGNS ALONG THE STORES TO SHORES NEIGHBORHOOD GREENWAYS ROUTES.
  12. SEE SPECIFICATIONS FOR TREE AND VEGETATION TRIMMING REQUIREMENTS. FIELD ADJUSTMENTS MAY BE REQUIRED BY CITY OF KIRKLAND FOLLOWING SIGN INSTALLATION (TYP).

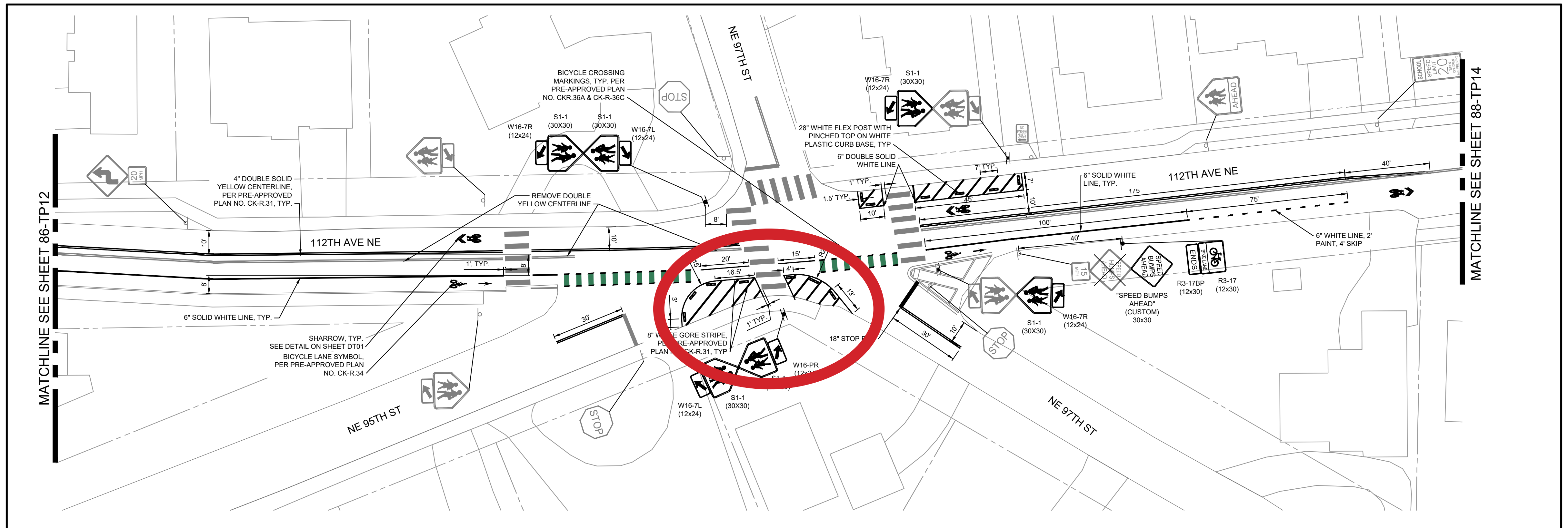

**Q: What's the purpose of bump-out at Northeast 95th Street?**

A: Five-way intersection, slows people down, shortens crossing.