

25 CENTRAL WAY, SUITE 400  
KIRKLAND, WA 98033  
P: 425.216.4051  
WWW.ATWELL.COM

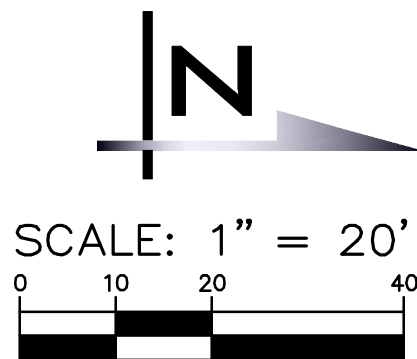

### Pedestrian Pathway Sketch (4/8/2025)

- Remove invasive plants, debris, refuse, discarded materials.
- Prune trees to create a 7' high pedestrian clearance
- Maintain all trees greater than 6" dia.
- Cover with 6" of Wood Chips

- = City of Kirkland standard plan wood bollard per CK-R-61

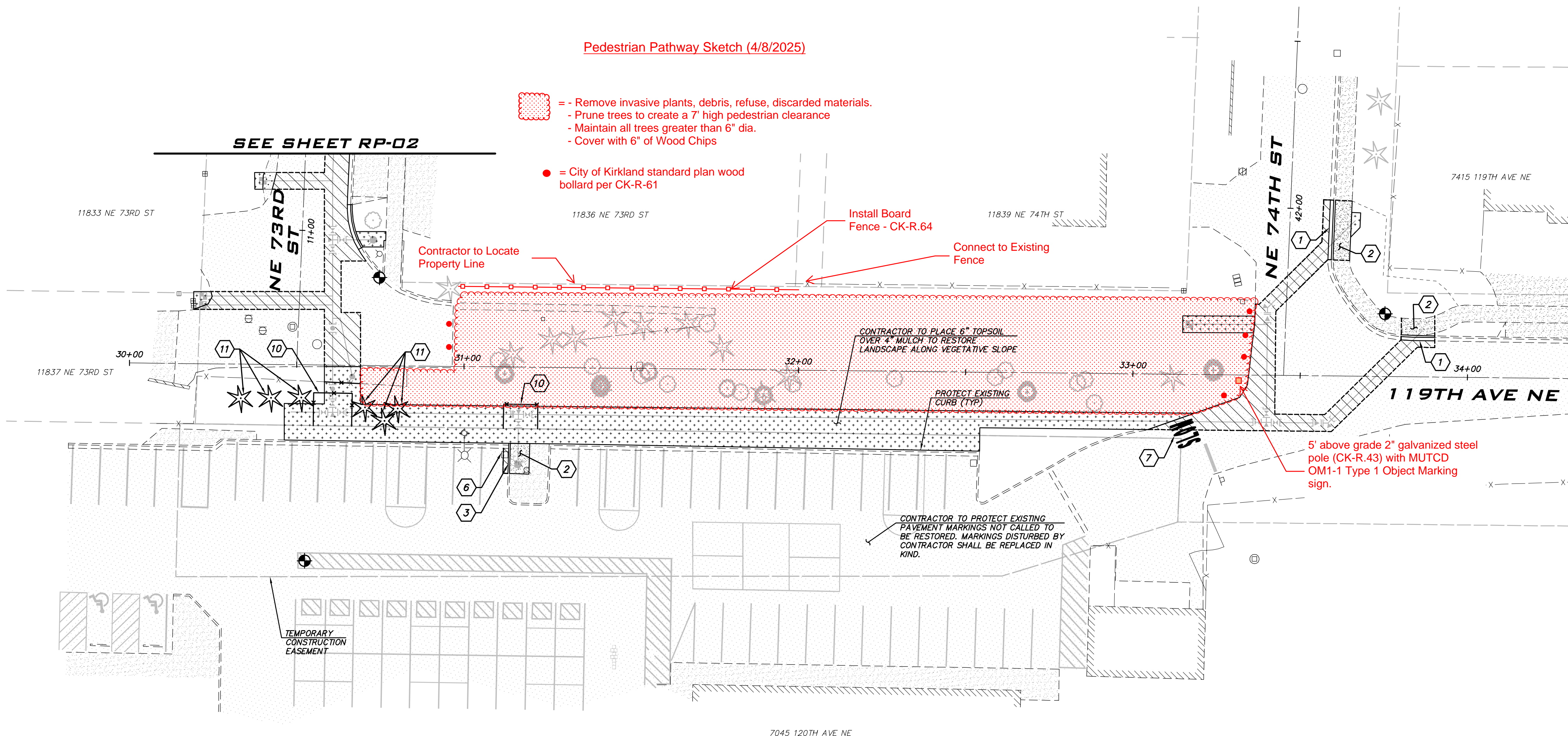

### NOTES

- CEMENT CONCRETE CURB & GUTTER TYPE A PER COK STD PLAN CK-R.17. REPLACE TO THE NEAREST JOINT. MINIMUM 2" WIDE HMA PATCH.
- CEMENT CONCRETE SIDEWALK PER COK STD PLAN CK-R.23. REPLACE TO THE NEAREST JOINT.
- CEMENT CONCRETE CURB TYPE E-2 PER COK STD PLAN CK-R.18. REPLACE TO THE NEAREST JOINT. CURB TO BE PAINTED TO MATCH ORIGINAL CONDITIONS. CONTRACTOR TO VERIFY & RECORD EXISTING PAINT MARKINGS PRIOR TO REMOVAL.
- REPLACE EXISTING GRAVEL TO ORIGINAL CONDITION.
- REPLACE STORM MANHOLE CASTING PER COK STD PLAN CK-D.18.A.
- ADJUST EXISTING CATCH BASIN OR MANHOLE TO GRADE PER COK STD PLAN CK-D.11.
- RESTORE PAVEMENT MARKINGS IN ORIGINAL LOCATION. CONTRACTOR TO FIELD VERIFY & RECORD ORIGINAL TYPE AND LOCATION OF MARKINGS PRIOR TO REMOVAL.
- INSTALL GRAVITY BLOCK WALL PER DETAIL SHOWN ON SHEET DT-03. INSTALL UNDERDRAIN DAYLIGHT AT END OF WALL IF DIRECTED BY CITY INSPECTOR. CITY INSPECTOR TO DETERMINE HEIGHT OF WALL REQUIRED IN THE FIELD.
- PROTECT EXISTING FENCE. REMOVE AND REPLACE FENCE PER COK STD PLAN CK-R.51A ONLY AS NECESSARY TO INSTALL IMPROVEMENTS. IF APPLICABLE, NOTIFY PROPERTY OWNER PRIOR TO REMOVAL.
- INSTALL 5' TALL BLACK CHAIN LINK FENCE PER COK STD PLAN CK-5.51A. FENCE SHALL HAVE BLACK SLATS INSTALLED. ALIGN EASTERN POSTS FOR FUTURE FENCE INSTALLATION.
- TREE TO BE REPLACED IN KIND. CITY FIELD INSPECTOR TO DETERMINE FINAL LOCATION.

### RESTORATION NOTES

- THE LOCATION OF THE PAVEMENT RESTORATION SHOWN IS APPROXIMATE ONLY AND THE EXACT LOCATION SHALL BE AS DIRECTED BY THE CITY CONSTRUCTION INSPECTOR DURING CONSTRUCTION.
- CONTRACTOR IS RESPONSIBLE FOR BARRICADES AND SIGNS OR OTHER NOTIFICATIONS AS APPROPRIATE IN ORDER TO ENSURE THAT RESIDENTS REMOVE VEHICLES OR OTHER OBSTRUCTIONS FROM THE ROAD PRIOR TO PAVEMENT RESTORATION.
- ADJUST ALL NEW AND EXISTING CASTINGS WITHIN ASPHALT PATCHES TO GRADE PER CITY STANDARD DETAILS.
- CONTRACTOR TO SAWCUT TRENCHES PRIOR TO EXCAVATION. MAKE SEPARATE SAWCUT MIN. 1' WIDTH PATCHING ALONG TRENCH PER COK STD PLAN CK-R.12.
- LIMIT IMPACTS TO LANDSCAPING. RESTORATION LIMITS SHOWN ARE APPROXIMATE AND WILL BE INCREASED TO CAPTURE ALL LOCATIONS IMPACTED BY CONTRACTOR ACTIVITY. RESTORE DISTURBED VEGETATIVE AREAS AND GRADE SLOPE TO MATCH ADJACENT SLOPE. PLACE MINIMUM 2" TOPSOIL AND SEED UNLESS OTHERWISE NOTED ON THE PROJECT PLANS.
- CONTRACTOR TO STAKE THE WEST PROPERTY LINE OF THE HOLY FAMILY CHURCH AFTER RESTORATION HAS BEEN COMPLETED. REFER TO SP 1-05.4(1) FOR ADDITIONAL INFORMATION.

### LEGEND

- HMA PATCH PLACED IN MAX 3" LIFTS OVER 4" CSTC COMPACTED TO 95%. HMA THICKNESS PER COK STD PLAN CK-R.12.
- CEMENT CONCRETE SIDEWALK OVER 4" CSTC
- GRAVEL
- LANDSCAPE RESTORATION

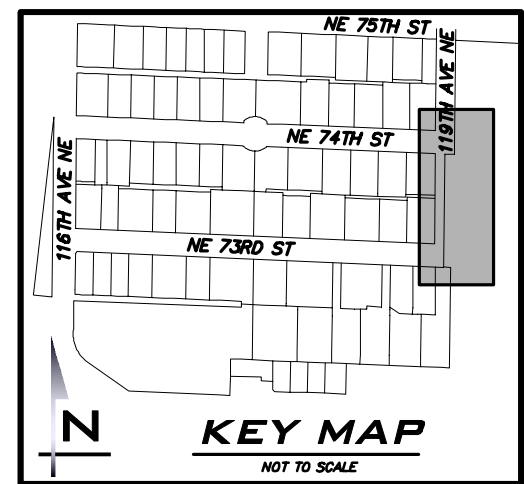

ATWELL JOB # BL23-113



## CITY OF KIRKLAND

DEPARTMENT OF PUBLIC WORKS  
123 FIFTH AVENUE KIRKLAND, WA 98033  
(425) 587-3800 www.kirklandwa.gov

NO.	DATE	BY	APPR.	REVISION



APPROVED BY:

DATE:

KAI POPE, EIT 9/2024  
DESIGNED BY: DATE

CAROL DOGGETT 9/2024  
DRAWN BY: DATE

BRIAN DARROW, PE 9/2024  
CHECKED BY: DATE

## NE 73RD ST WATER MAIN IMPROVEMENT PROJECT

### RESTORATION PLAN - 119TH AVE NE

SHEET:

16 OF 19

SCALE:

AS SHOWN

FILENAME:

RP-03