

SE 1/4 OF THE SW 1/4 OF SECTION 32, TOWNSHIP 26 NORTH, RANGE 5 EAST, W.M.

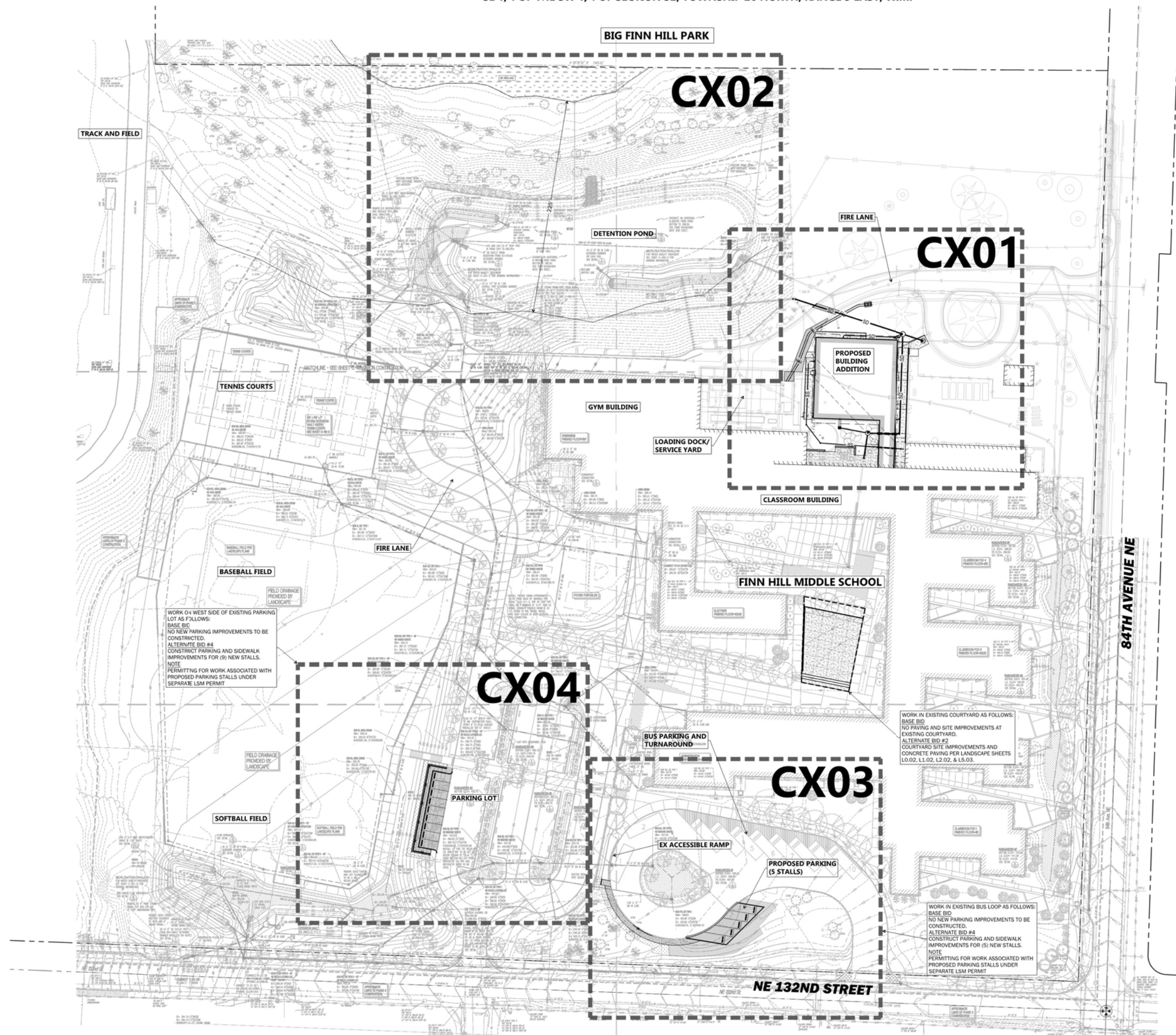

integrus
ARCHITECTURE



**Lake Washington School District No. 414
FINN HILL MIDDLE SCHOOL ADDITION**

8040 NE 132nd St.
KIRKLAND, WA 98034

Date:	04/07/23	
Job No.:	22216.00	
Drawn By:	DJD	
Checked by:	SSE	
Revisions		
#	Date	Description
A	5/12/23	LSM Permit REV 1
B	5/12/23	BLD Permit REV 1

OVERALL
CONTROL PLAN

C010

