

## DRC // OVERALL ROOF PLAN

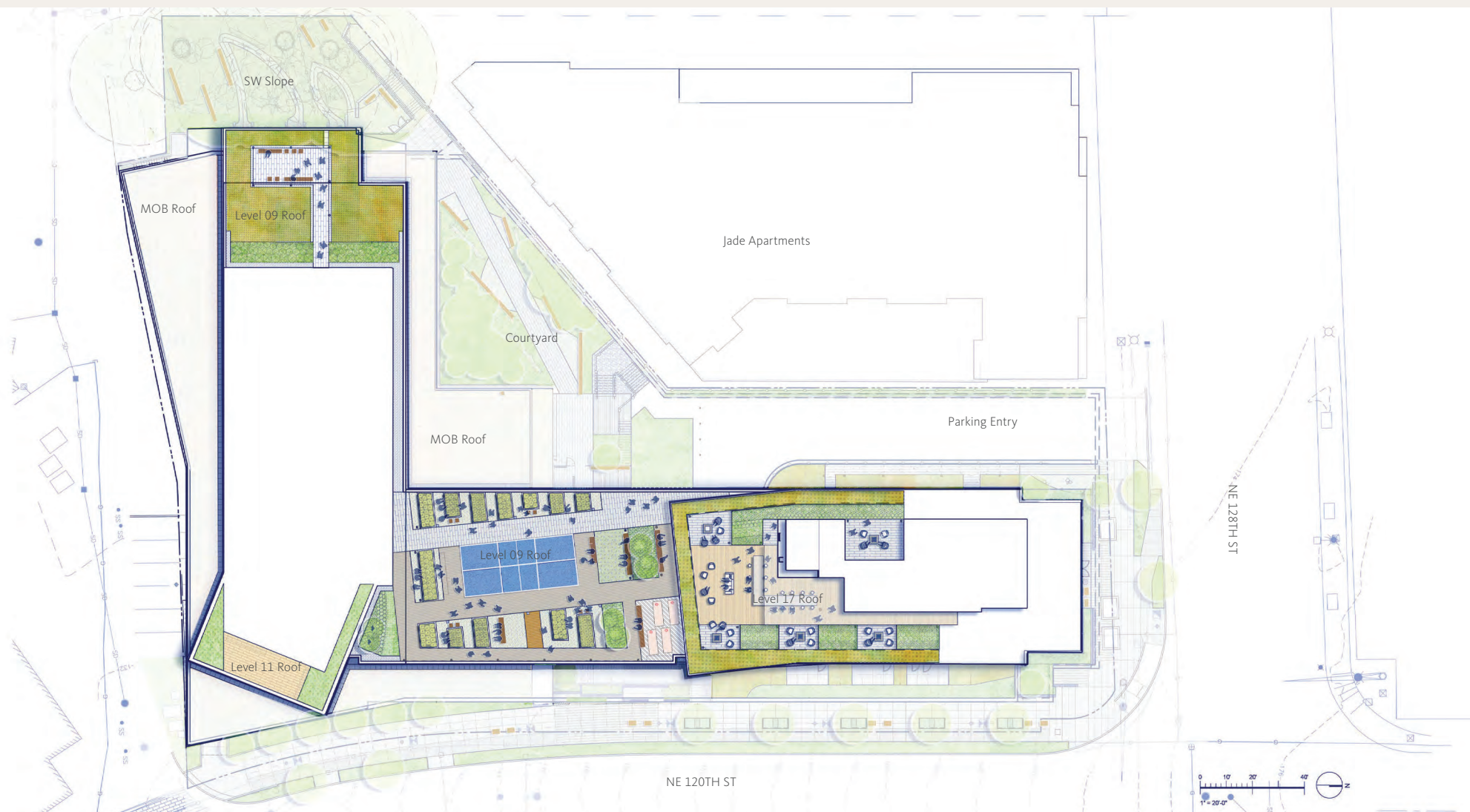

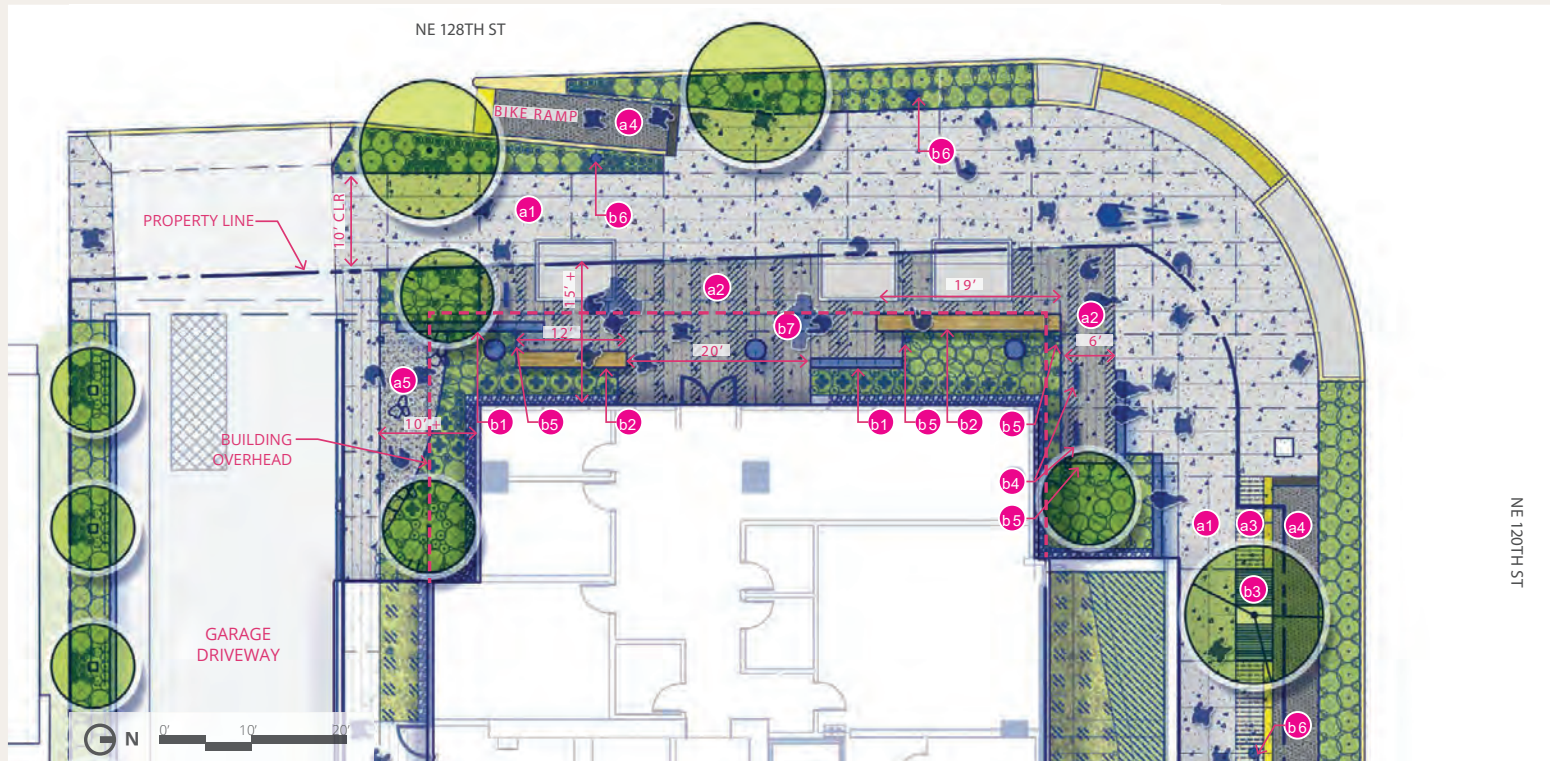

# DRC // STREETSCAPE MATERIALS - 128TH FRONTAGE



## Legend:

### PAVING:

- a1 SIDEWALK - CIP CONC W/ SAW-CUT JOINTS (HEAVY BROOM FINISH)
- a2 BUILDING ENTRY SPECIAL FINISH - CIP CONC W/ SAW-CUT JOINTS (LIGHT/HEAVY SANDBLAST FINISH EQ, INTEGRAL COLOR, & MICA)
- a3 SIDEWALK AMENITY ZONE - CIP CONC W/ SAW-CUT JOINTS (LIGHT BROOM FINISH)
- a4 BIKE LANE - ASPHALT PAVING W/ TACTILE WARNING PERIMETER
- a5 CRUSHED ROCK PAVING

### SITE FURNISHINGS:

- b1 CIP CONC SEATWALL
- b2 TIMBER BENCH
- b3 TREE GRATE
- b4 BIKE RACK
- b5 BOLLARD LIGHT
- b6 CoK STD LIGHT
- b7 FLEXIBLE PLAZA SPACE

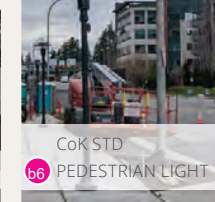
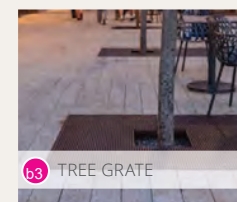
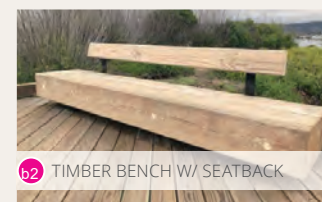
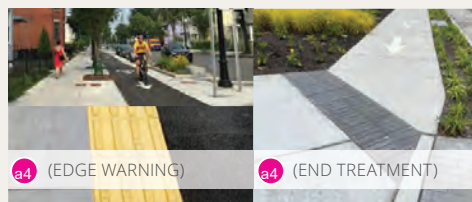
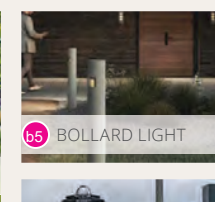
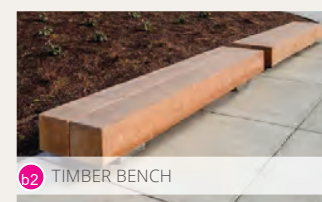



## DRC // STREETSCAPE MATERIALS

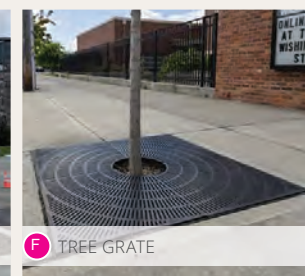
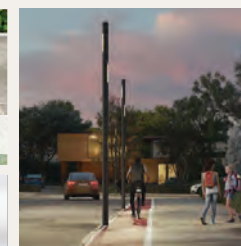
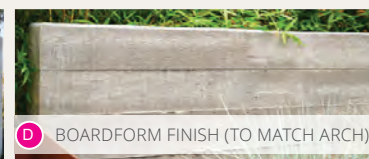
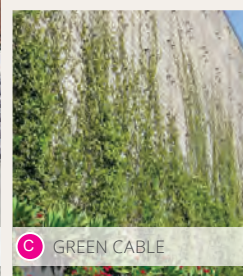
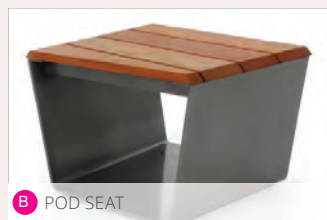
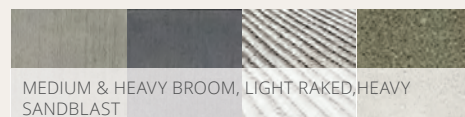
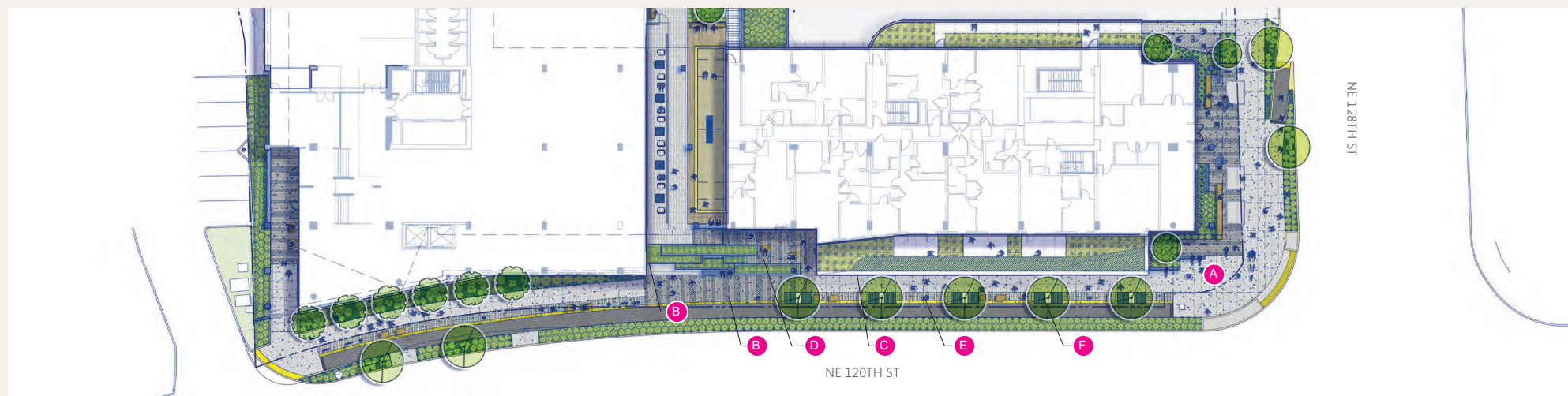



## DRC // STREETSCAPE PLANTING

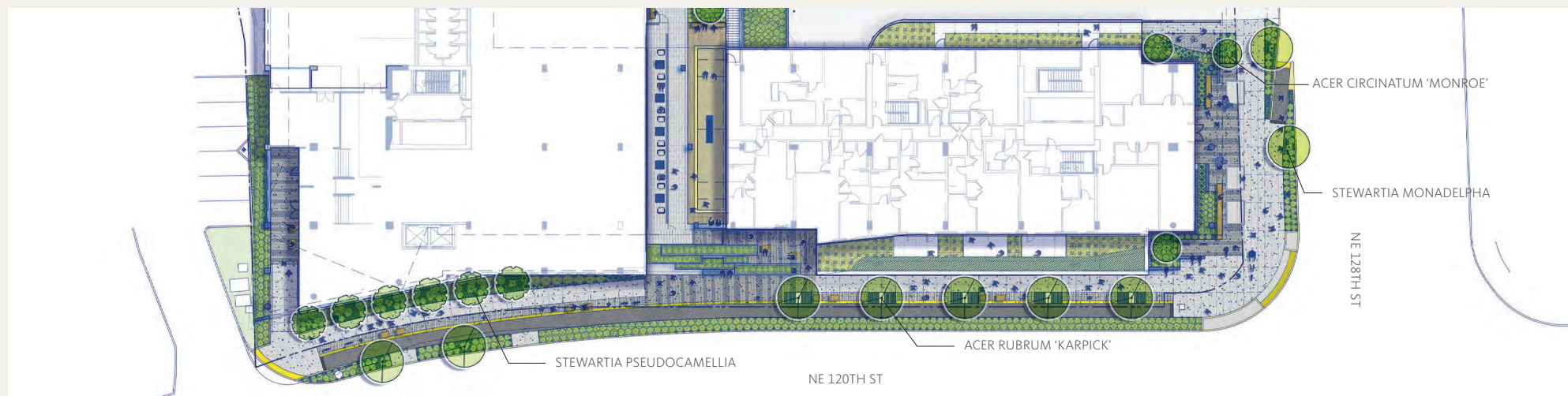

### TREE



STEWARTIA MONADELPHA



ACER RUBRUM 'KARPICK'



ACER CIRCINATUM  
'MONROE'

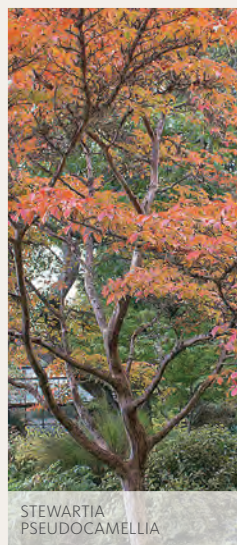

STEWARTIA  
PSEUDOCAMELLIA

### SHRUB

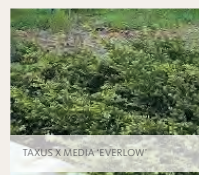

TAXUS X MEDIA 'EVERLOW'

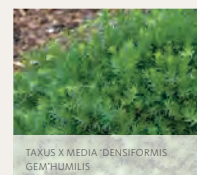

TAXUS X MEDIA 'DENSIFORMIS  
GEM' HUMILIS



PRUNUS LAUROCERASUS 'MOUNT  
VERNON'



SARCOCOCCA HOOKERIANA  
HUMILIS

### FERN



POLYSTICHUM  
MUNIFOLIUM

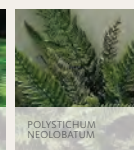

POLYSTICHUM  
NELOBATUM

### GRASS



DESCHAMPSIA  
CESPITOSA



MISCANTHUS  
SINENSIS 'YAKU JIMA'

### GROUNDCOVER



GAULTHERIA  
PROCUMBENS  
'BERRY CASCADE' TM

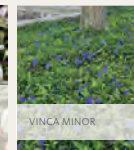

VINCA MINOR



FRAGARIA CHILOENSIS

### NOTE:

1. FINAL SPECIES SUBJECT TO LOCAL AVAILABILITY.
2. ANY REQUIRED ROW SUBSTITUTIONS SHALL BE SELECTED FROM THE CITY OF KIRKLAND APPROVED STREET TREE LIST



## DRC // STREETSCAPE MATERIALS - 120TH MID BLOCK

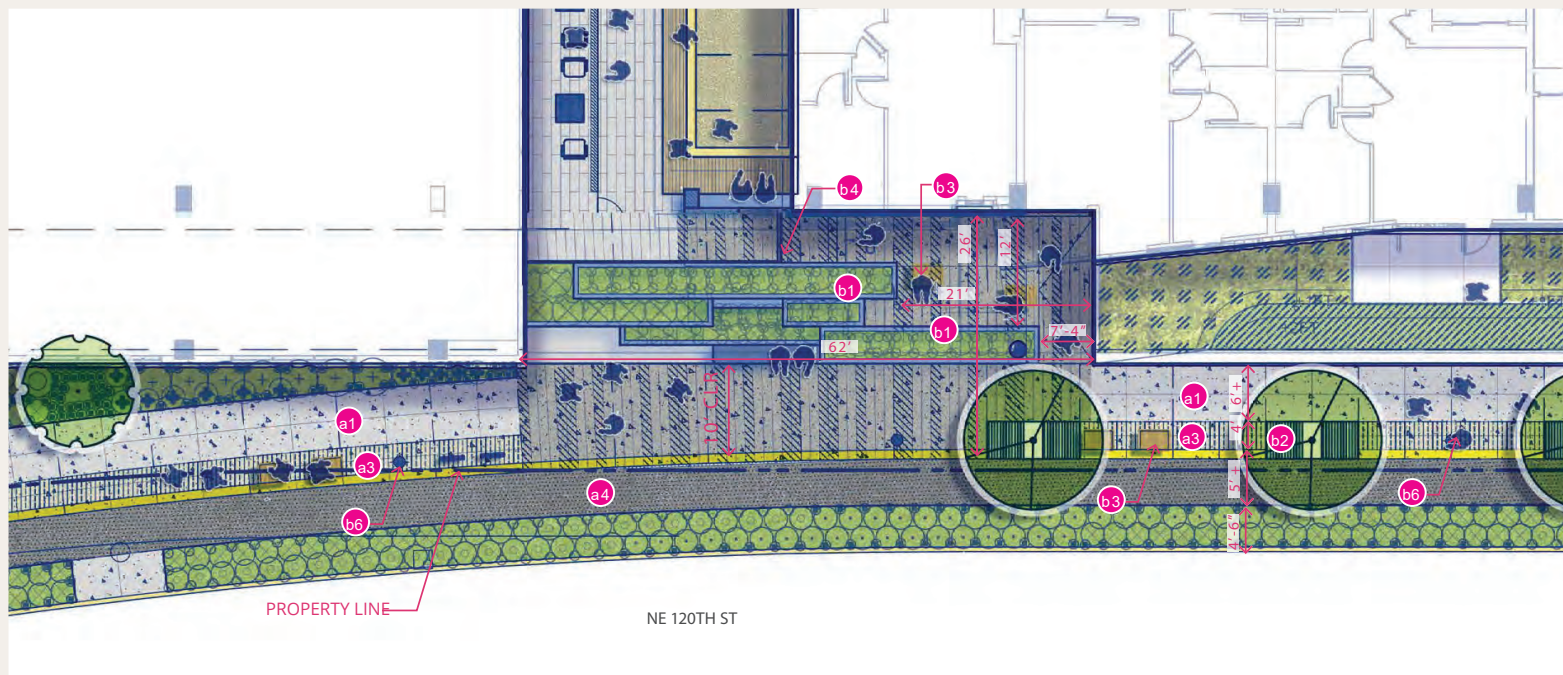

### Legend:

#### PAVING:

- a1** SIDEWALK - CIP CONC W/ SAW-CUT JOINTS (HEAVY BROOM FINISH)
- a2** BUILDING ENTRY SPECIAL FINISH - CIP CONC W/ SAW-CUT JOINTS (HEAVY SANDBLAST FINISH, INTEGRAL COLOR, & SILICA CARBIDE)
- a3** SIDEWALK AMENITY ZONE - CIP CONC W/ SAW-CUT JOINTS (LIGHT BROOM FINISH)
- a4** BIKE LANE - ASPHALT PAVING W/ TACTILE WARNING PERIMETER

#### SITE FURNISHINGS:

- b1** CIP CONC SEATWALL
- b2** TREE GRATE
- b3** WOOD SEAT'S
- b4** GATE PER ARCH.
- b5** BOLLARD LIGHT
- b6** CoK STD PEDESTRIAN LIGHT

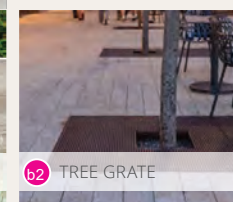
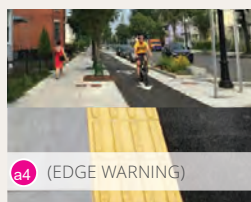
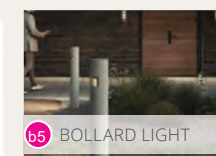
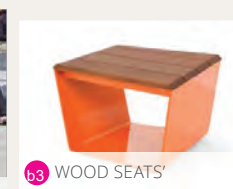
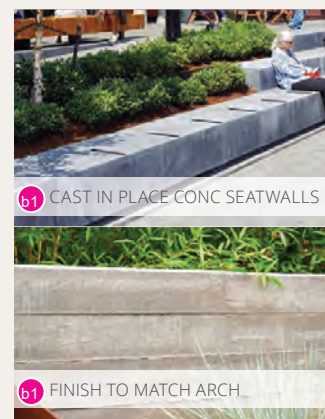
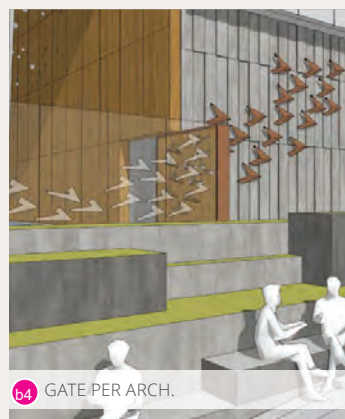
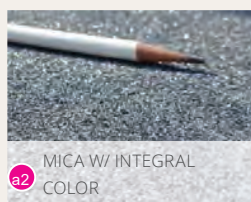



## DRC // STREETSCAPE PLANTING



### TREE

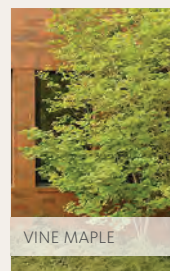

### SHRUB

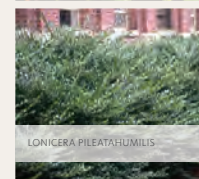
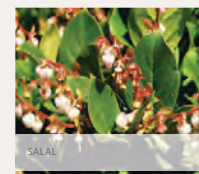
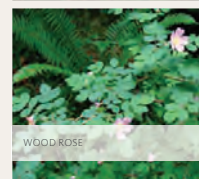

### FERN

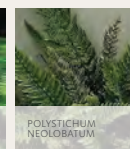

### GROUNDCOVER

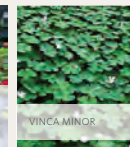

### NOTE:

1. FINAL SPECIES SUBJECT TO LOCAL AVAILABILITY.
2. ANY REQUIRED ROW SUBSTITUTIONS SHALL BE SELECTED FROM THE CITY OF KIRKLAND APPROVED STREET TREE LIST



## DRC // SW CORNER CONNECTION

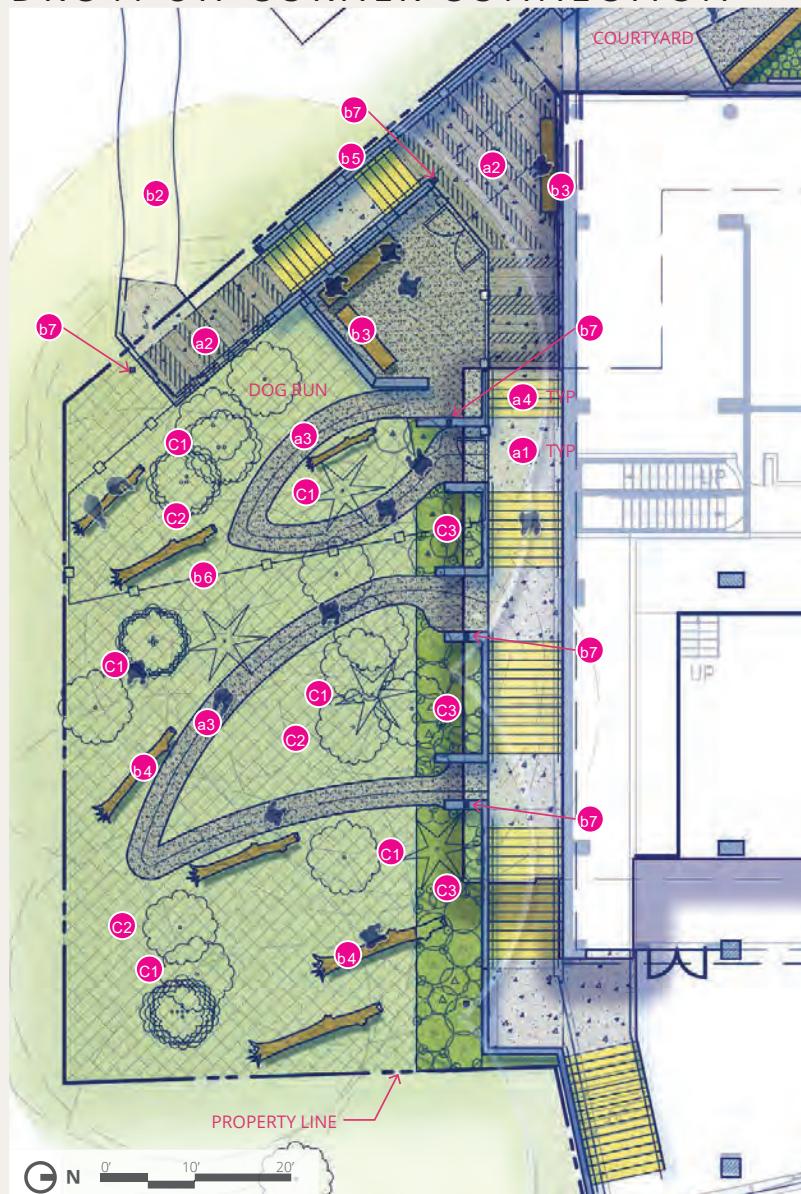

### Legend:

#### PAVING:

- a1 SIDEWALK - CIP CONC W/ SAW-CUT JOINTS (HEAVY BROOM FINISH)
- a2 BUILDING ENTRY SPECIAL FINISH - CIP CONC W/ SAW-CUT JOINTS (HEAVY SANDBLAST FINISH, INTEGRAL COLOR, & SILICA CARBIDE)
- a3 GRAVEL PATH
- a4 SITE STAIR

#### SITE FURNISHINGS:

- b1 CIP CONC SITE WALL
- b2 EXIST PED CONNECTION
- b3 TIMBER BENCH
- b4 SALVAGE NURSE LOG
- b5 GUARDRAIL
- b6 DOGRUNFENCE-4'-2"HT.
- b7 SITE LIGHT POLE

#### LANDSCAPE:

- c1 EXISTING TREES (PRESERVE & PROTECT)
- c2 ARBORIST MULCH AT EXIST ROOTS
- c3 NATIVE SHRUB PLANTINGS

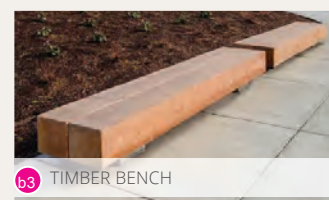
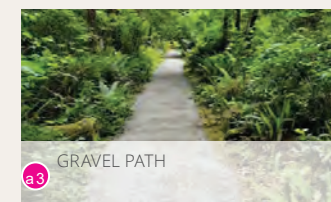
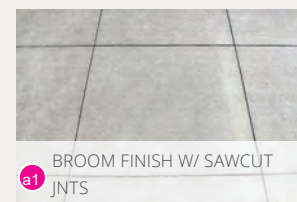
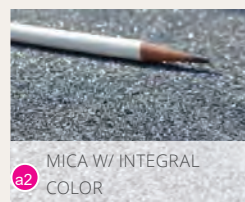



DRC // ROOF LEVEL 09

