

# Arcade / Sidewalk

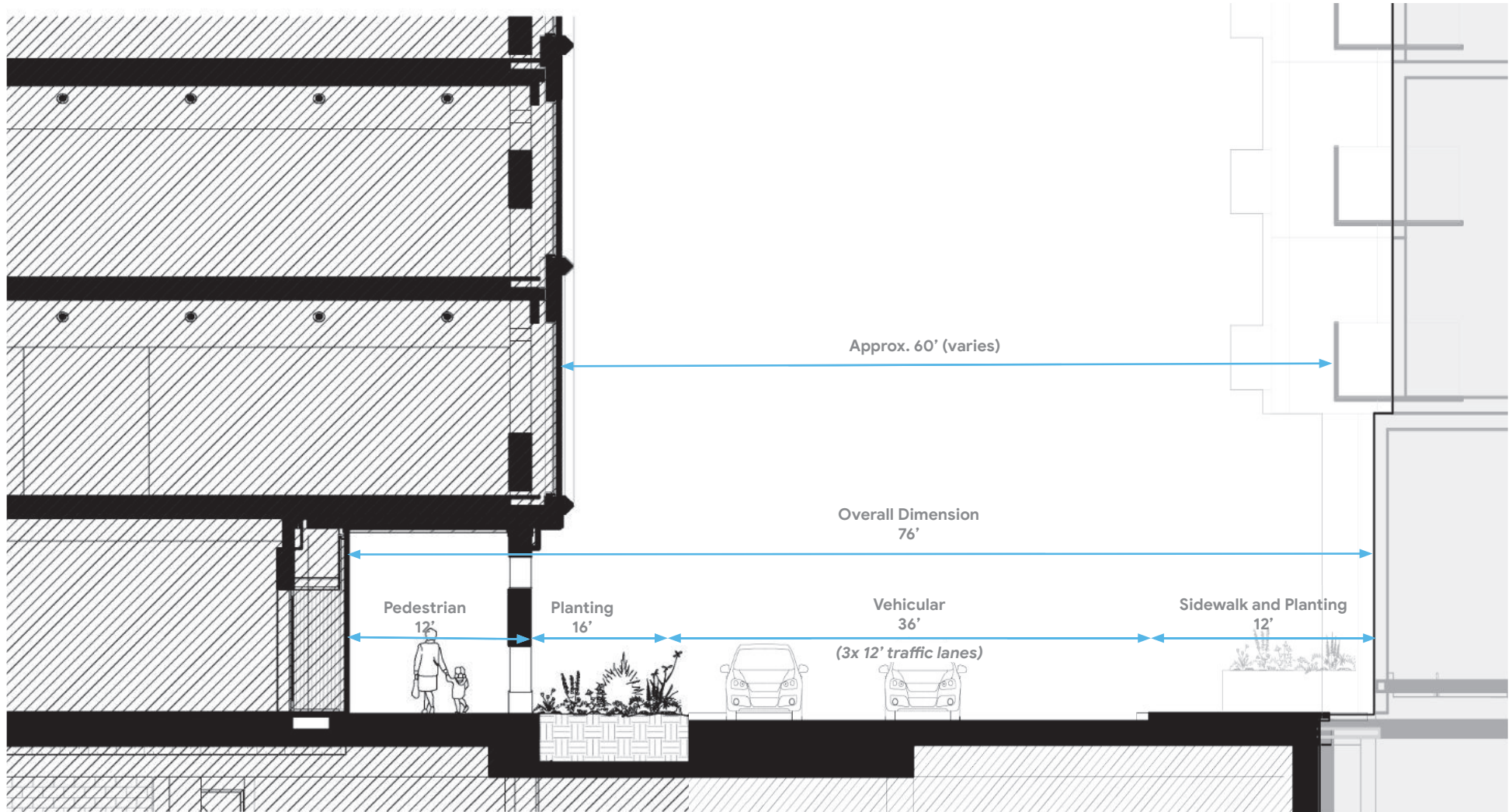

# Fire Lane and Bike Entry

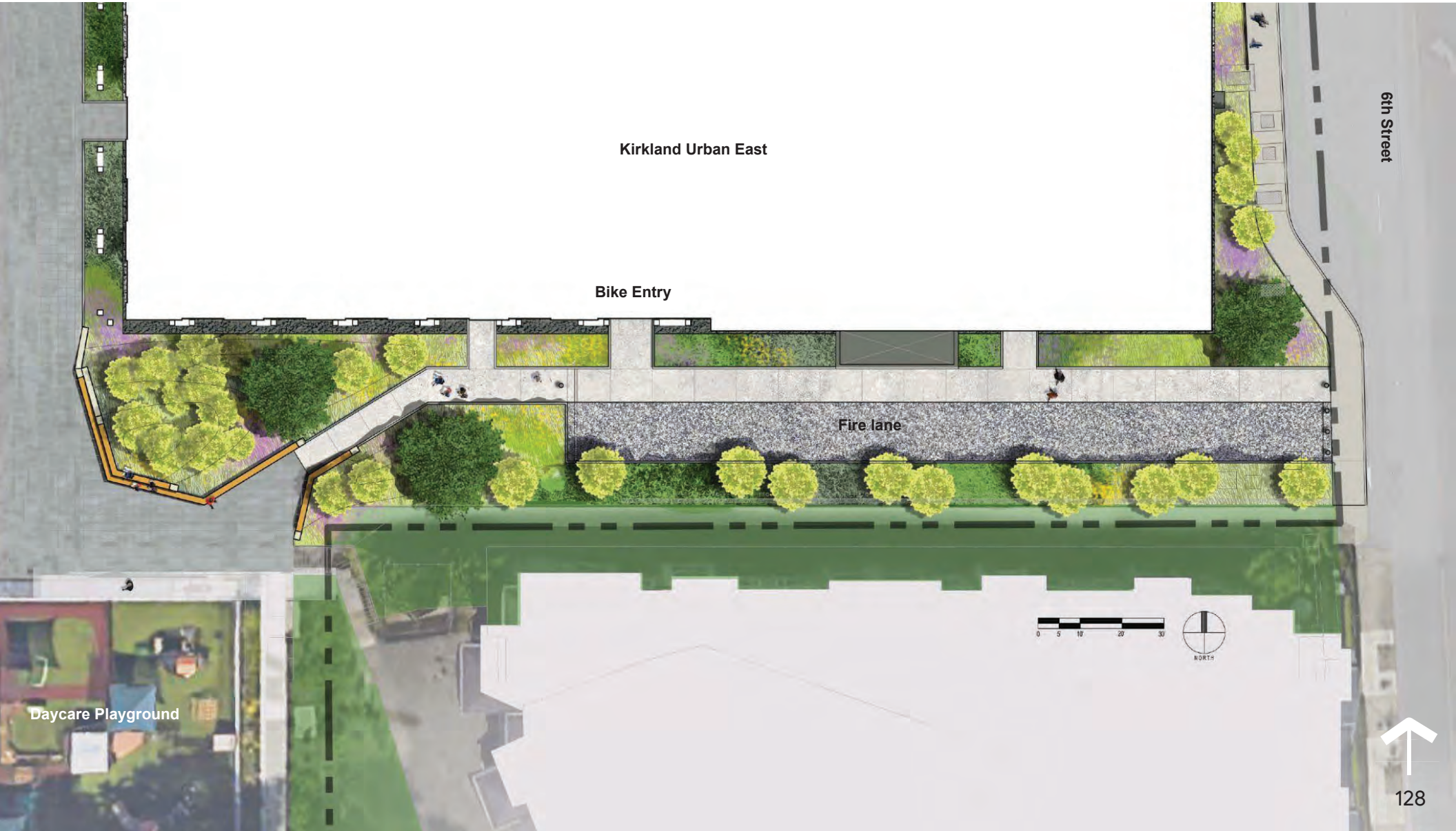

# South Fire Access (Master Plan)

## 9 Parking/Fire Access at 6th Street

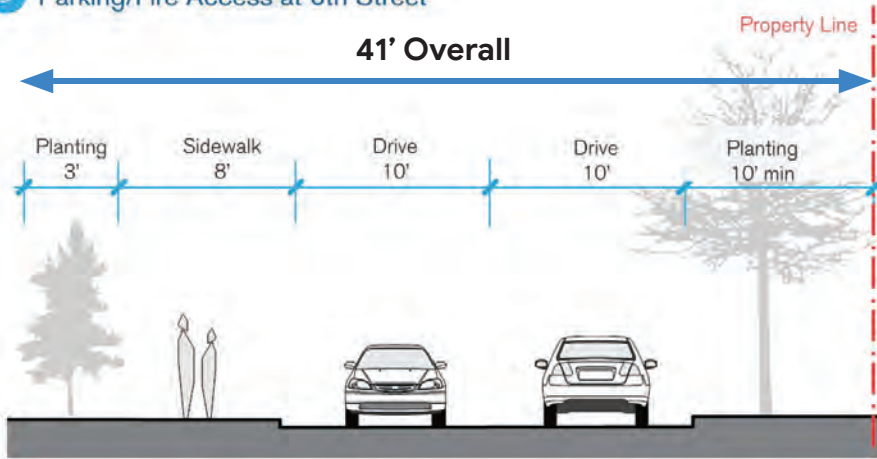

**Masterplan Street Section**  
Car Focused

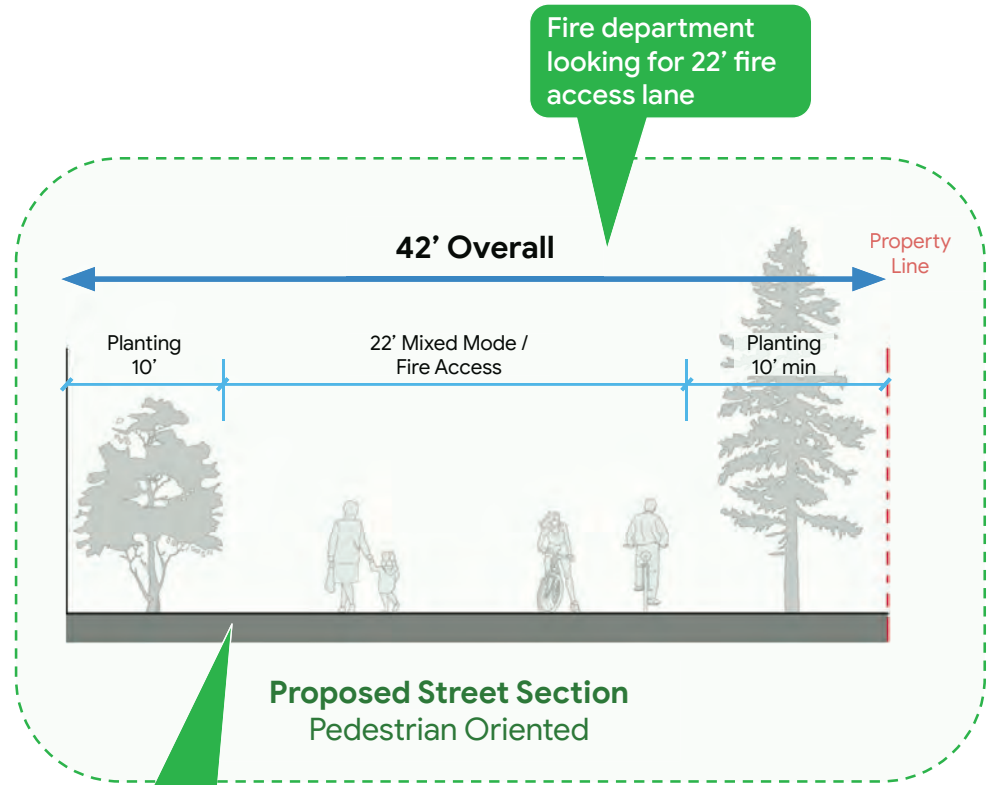
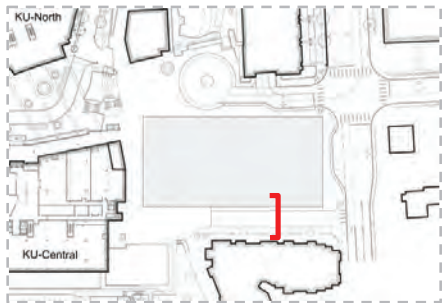

Fire department looking for 22' fire access lane

**Proposed Street Section**  
Pedestrian Oriented

Bollards at 6th Street, No vehicle access except fire (Fire department request)

# Landscape Notes

# Landscape Approach



+



Enhance existing Kirkland Urban places

Maximize connections to local ecology and sustainability

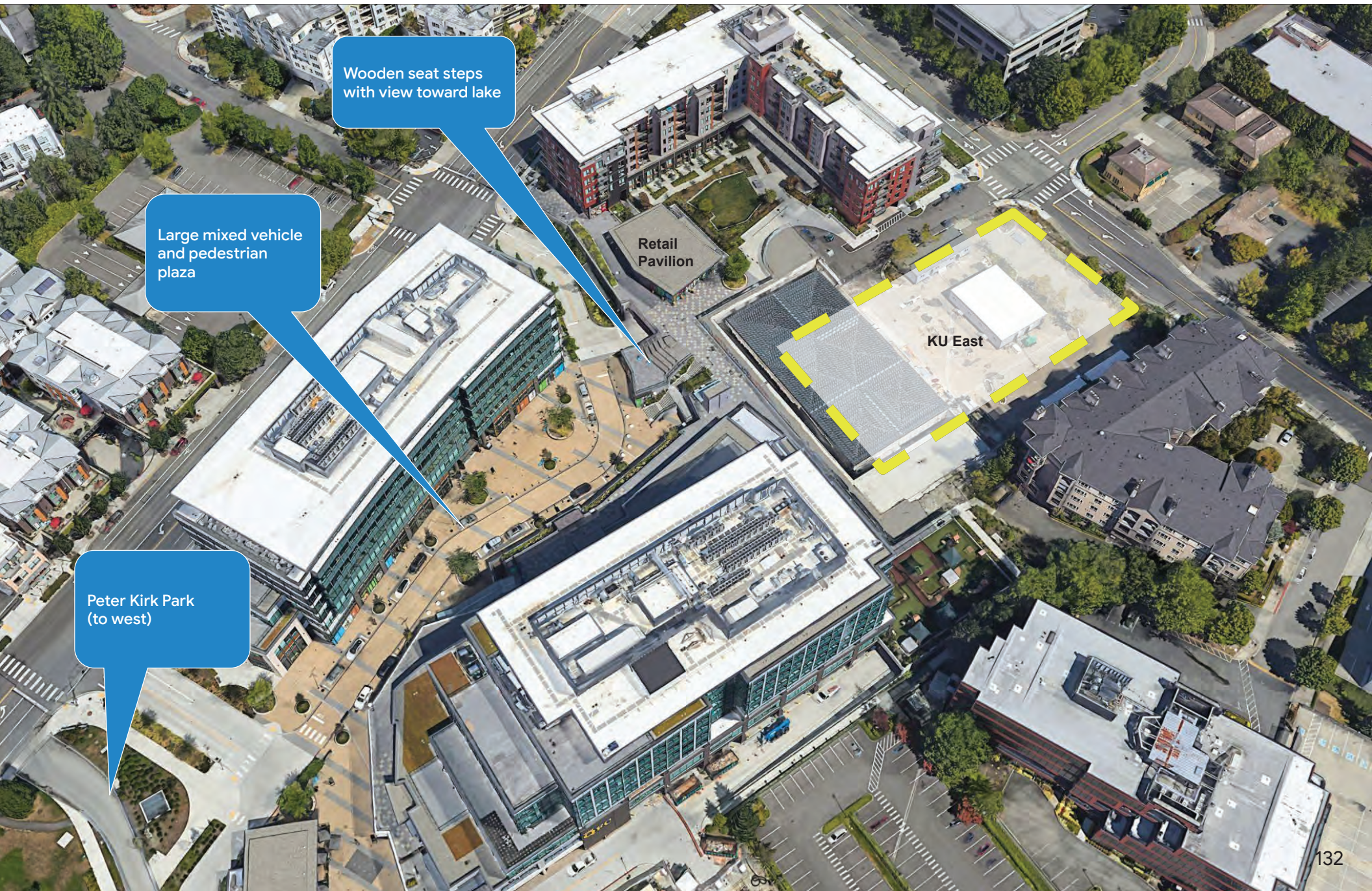

Wooden seat steps  
with view toward lake

Large mixed vehicle  
and pedestrian  
plaza

Peter Kirk Park  
(to west)

Retail  
Pavilion

KU East

# Expand Kirkland Native Ecology



**Larger Landscape:**  
Connect daily experience at KU with the larger bioregional landscape

**Species Interdependence:**  
Plants are food and habitat for co-evolved and interdependent species



**Pioneer Species**  
Early successional species build soil and quickly establish. This is how natural systems work



**Landscape Management:**  
Adaptively support the evolution of the landscape as a dynamic system (not a fixed design)

# Kirkland Urban + Moss Bay

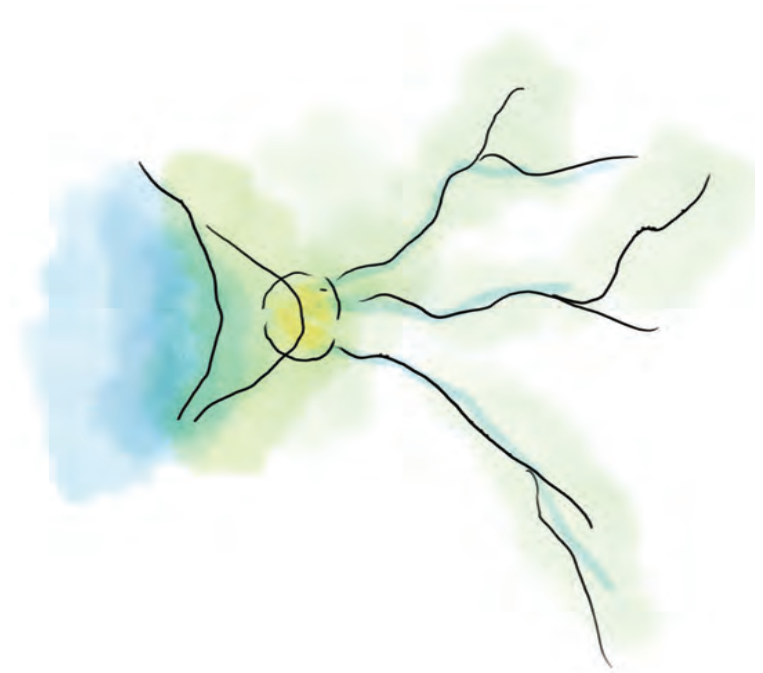
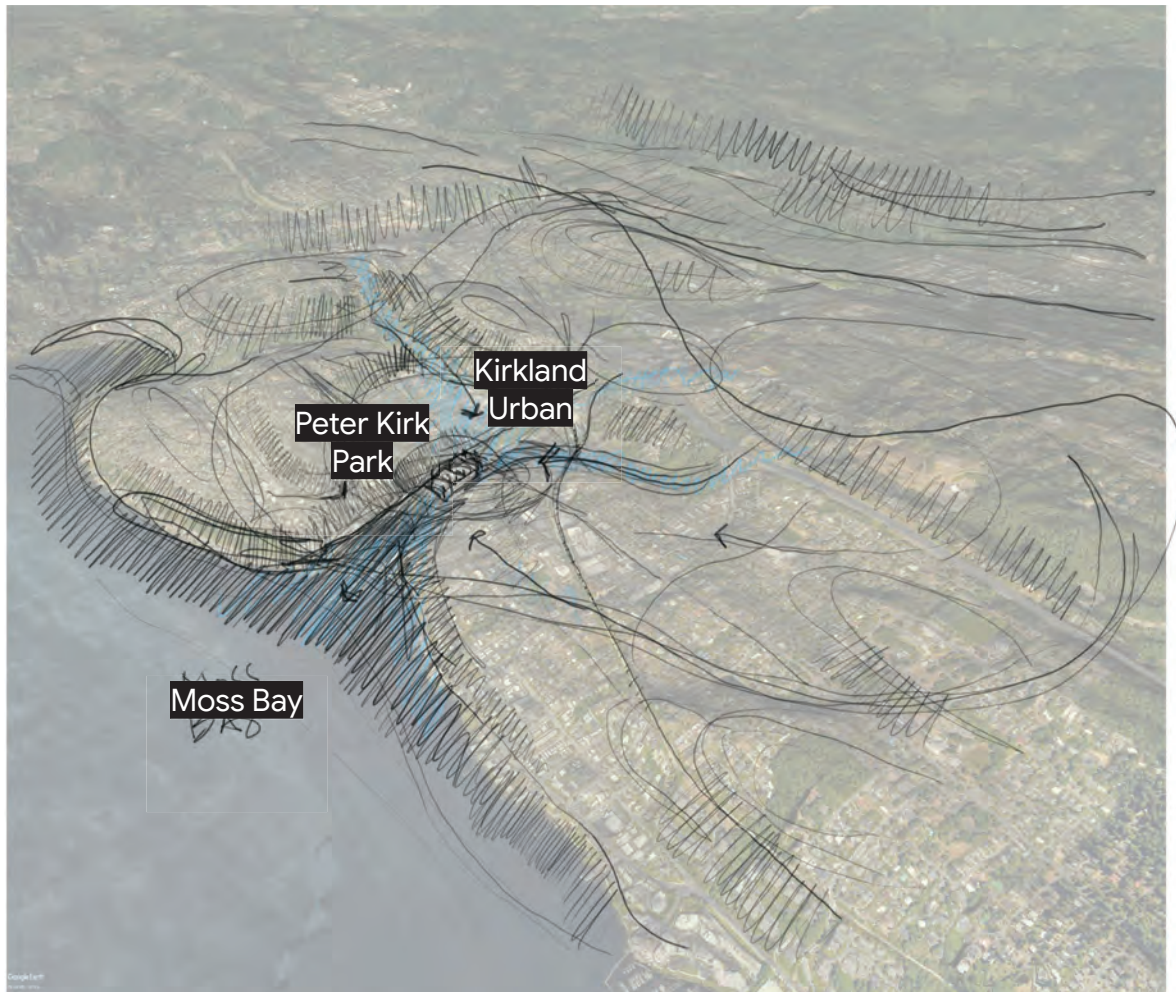

Kirkland Urban sits at the confluence of historic streams and urban connections that lead to Peter Kirk Park and Moss Bay



# Collect and Filter



# Arrival and Plaza - Existing



# Colonnade Section

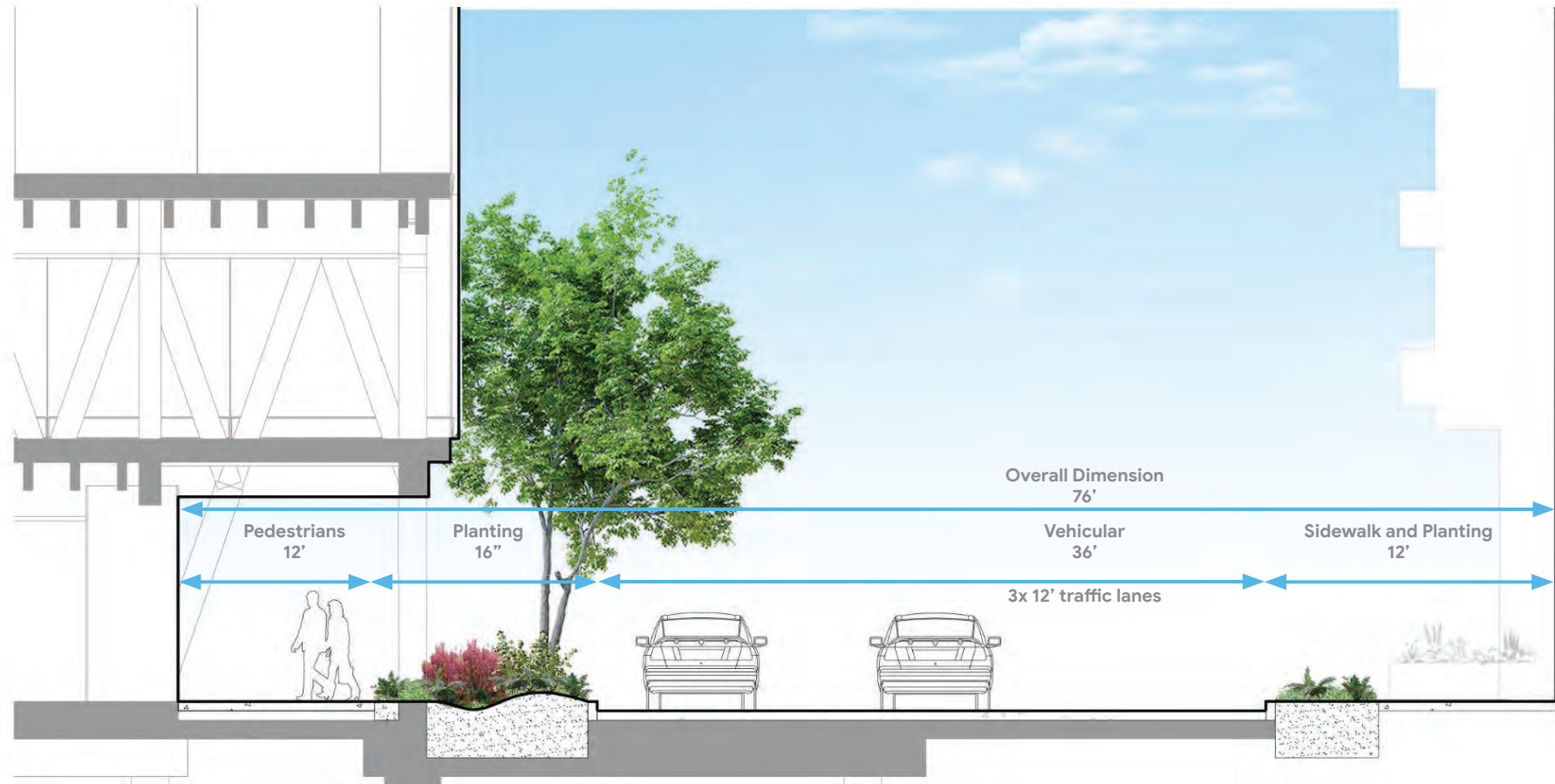

**Proposed Street Section**  
Pedestrian Arcade



# Daycare Connection - Existing

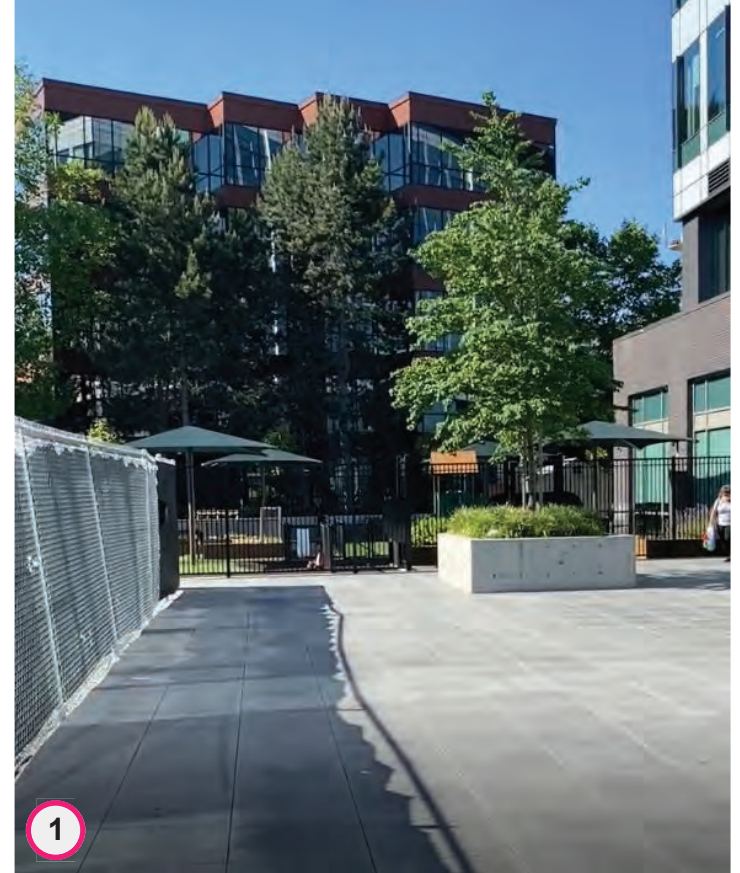
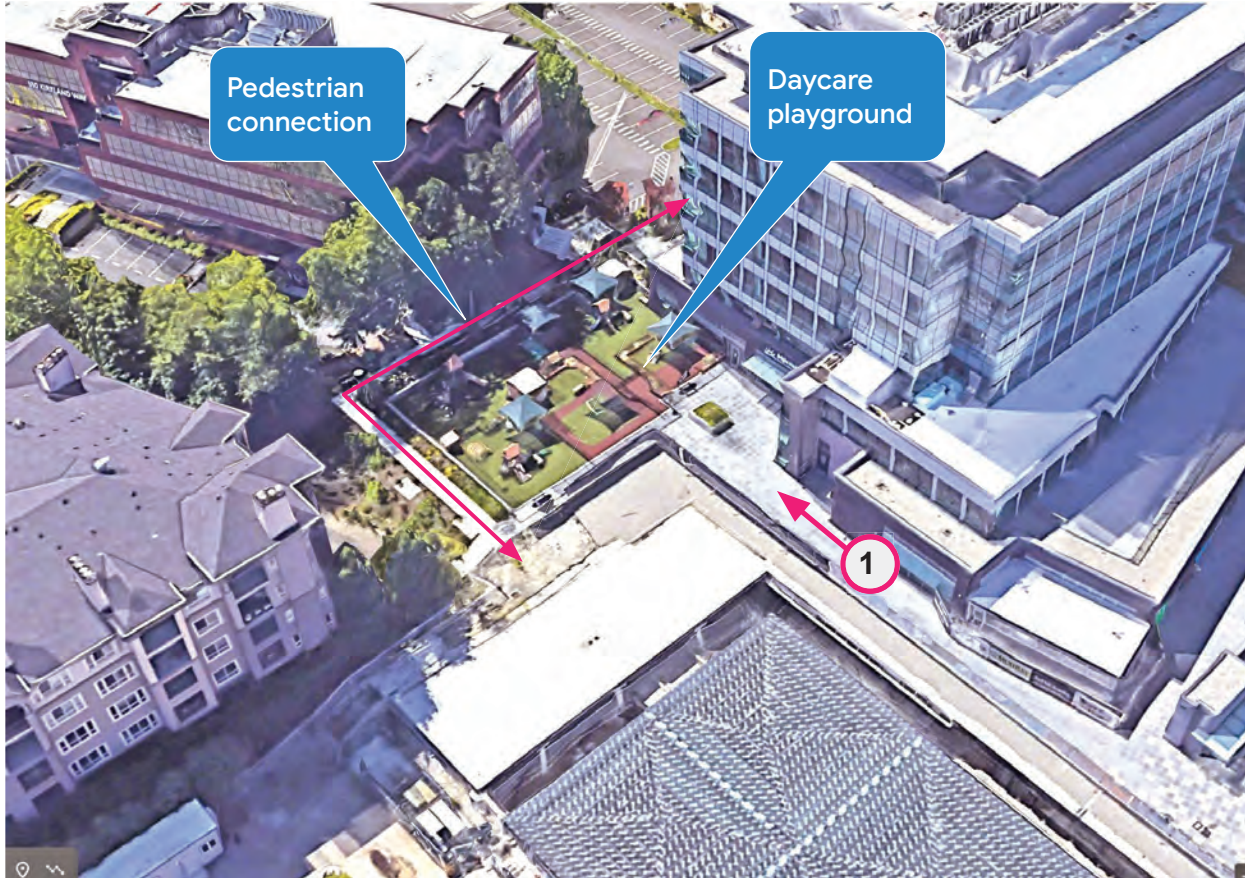

# Fire Lane and Bike Entry



Existing planting along property line south of fire lane

# 6th Street - Existing

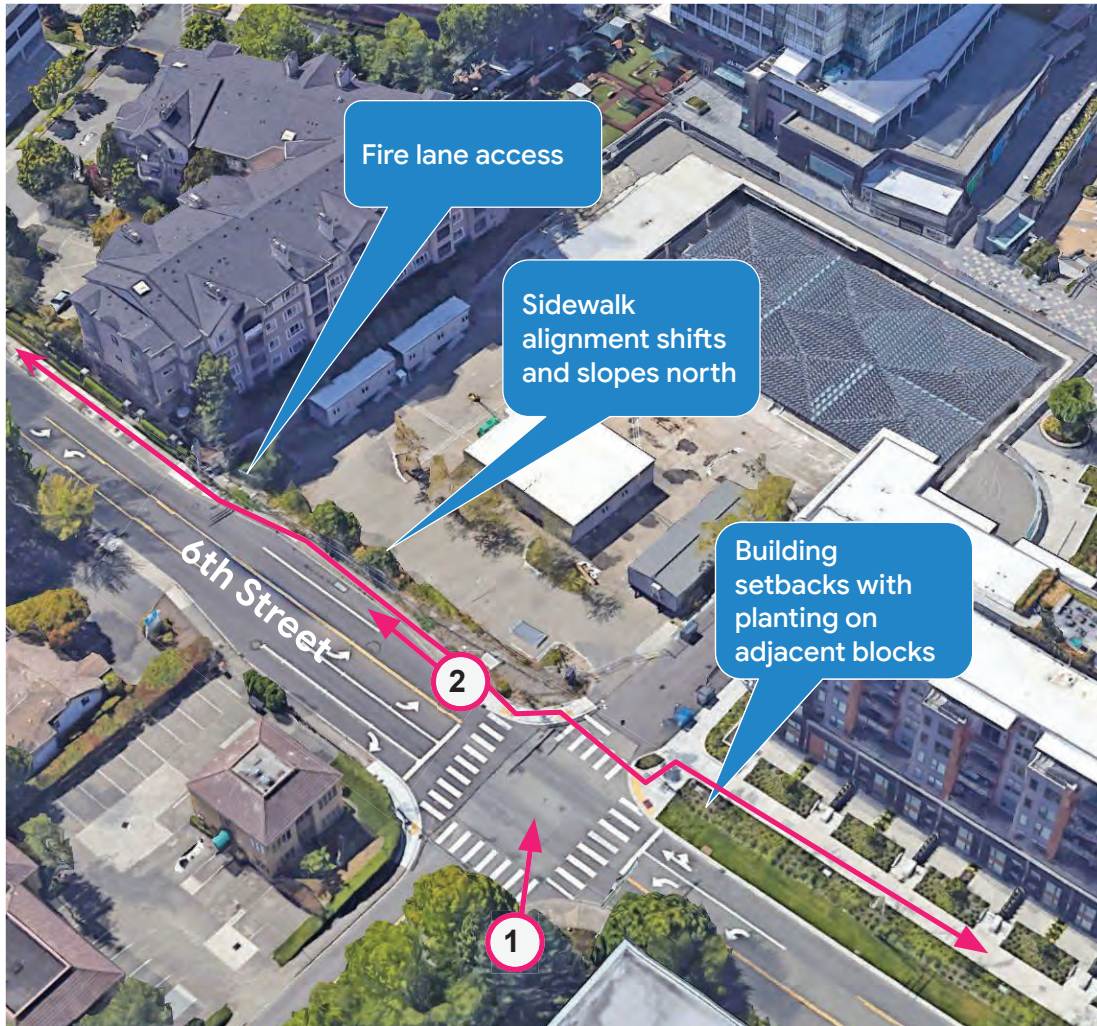

Existing condition looking southwest from 4th Avenue and 6th Street



Existing condition looking south on 6th Street

# Firelane Section

