

- | | |
|---------------------------------|------------------------------------|
| 1 VINE MAPLE | 2 RED BARRENWORT |
| 3 EMERALD SPREADER JAPANESE YEW | 4 COMPACT ESCALLONIA |
| 5 SHENANDOAH SWITCH GRASS | 6 HONORINE JOBERT JAPANESE ANEMONE |

Paseo (Plan + Plant Palette)

15



- | | |
|-------------------------|---------------------------|
| 1 FLOWERING ACCENT TREE | 2 PEDESTRIAN CONNECTIVITY |
| 3 RESIDENTIAL ENTRIES | 4 SIDEWALK |
| 5 TURFGRASS | 6 ENTRY DRIVE |

View 4 - Paseo Looking Northeast

16

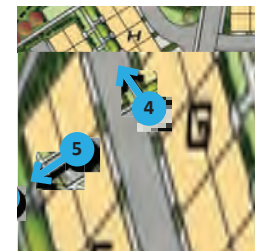

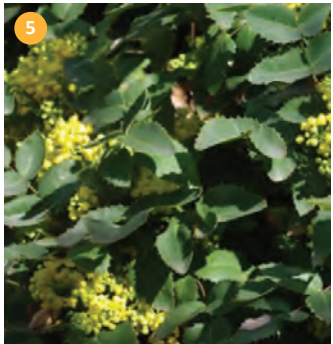

- | | |
|-------------------------------|------------------------------------|
| 1 PRINCESS DIANA SERVICEBERRY | 2 SWEETBOX |
| 3 GULF STREAM HEAVENLY BAMBOO | 4 SHAMROCK INKBERRY HOLLY |
| 5 CREEPING MAHONIA | 6 HONORINE JOBERT JAPANESE ANEMONE |

Paseo (Plan + Plant Palette)

17



- | | |
|-----------------------|-------------------|
| 1 ENTRY DRIVE | 2 VISITOR PARKING |
| 3 RESIDENTIAL ENTRY | 4 PASEO |
| 5 PEDESTRIAN SIDEWALK | 6 AUTO-COURT |

View 5 - Entry Drive Looking Southwest

18





- 1 GABION BASKET GUARDRAIL
- 2 PEDESTRAIN ACCESS TO RESIDENTIAL ENTRIES
- 3 ENTRY DRIVE
- 4 FORBES CREEK BELOW

View 6 - Bridge Looking Southwest

19

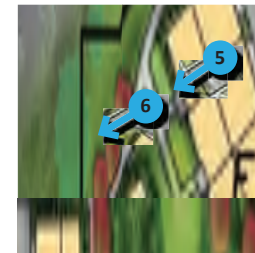

Toll Brothers
America's Luxury Home Builder®



BLUELINE



01-06-2023



- 1 STAR MAGNOLIA
- 3 COMPACT ESCALLONIA
- 5 CLUMPING BAMBOO

- 2 ALL GOLD JAPANESE FOREST GRASS
- 4 EMERALD SPREADER JAPANESE YEW
- 6 SWEETBOX

Paseo (Plan + Plant Palette)

20



- 1 ENTRY DRIVE
- 2 VISITOR PARKING
- 3 RESIDENTIAL ENTRY
- 4 PEDESTRIAN ACCESS TO FORBES CREEK AND CKC
- 5 VISITOR PARKING

View 7 - Entry Drive Looking Northwest

21

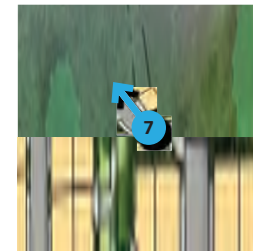



- | | |
|-----------------------|---------------------------------------|
| 1 ENTRY DRIVE | 2 RECREATIONAL AREA AND ACCESS TO CKC |
| 3 RESIDENTIAL ENTRY | 4 AUTO-COURT |
| 5 PEDESTRIAN SIDEWALK | 6 GARAGE |

View 8 - Entry Drive Looking West

22





- 1 ENTRY DRIVE
- 2 TRASH BIN STAGING ON PICK-UP DAY
- 3 RESIDENTIAL ENTRY
- 4 PEDESTRIAN ACCESS TO RESIDENTIAL ENTRIES
- 5 AUTO-COURT

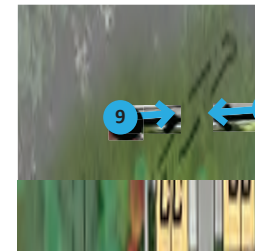

View 9 - Entry Drive Looking East

23

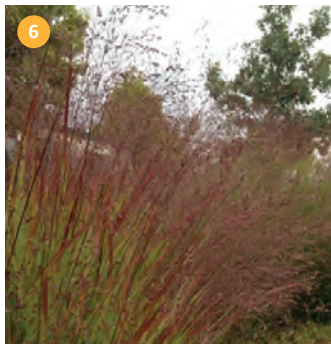

- | | |
|--|--------------------------------------|
| 1 PICKLEBALL COURT | 2 PLAY STRUCTURE - NATURAL MATERIALS |
| 3 PICNIC TABLES - INDUSTRIAL MATERIALS | 4 COMMON WHITE SNOWBERRY |
| 5 CANADA RED CHOKECHERRY | 6 SHENANDOAH SWITCH GRASS |
| 7 PARKING AND MULTI-MODAL PLAZA | 8 CONNECTING TRAIL TO CKC |

West Amenity Space (Plan + Materials/Features)

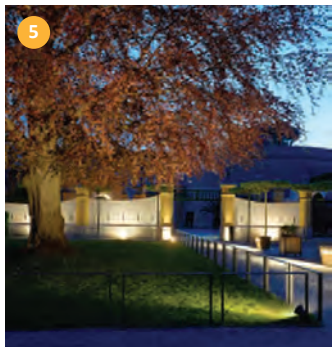
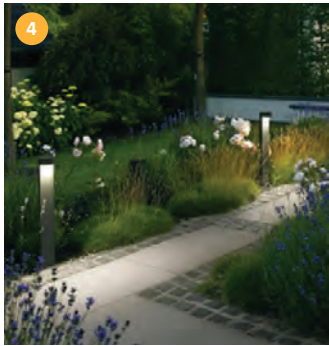
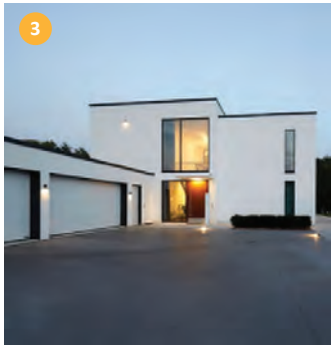

Lighting

- The conceptual lighting plan demonstrates the intent of the project and is not a technical study. The minimum foot candle light levels will be provided per code. All lighting will be shielded to prevent glare and unnecessary light pollution to adjacent properties.
- Roadway scaled lighting will be provide along the entry drive.
- Pedestrian scaled pole lighting will be provided within the amenity space plazas.
- Building lights will be provided at front doors and within the auto-courts.
- Small scaled pedesrain lights will be provide to illuminate pedestrian walkways, plazas, and paseos in which other illumination sources are lacking.
- Accent uplighting for the street trees will provided at the project entry and amenity plazas.
- Project signage shall be lighted for drama and wayfinding.

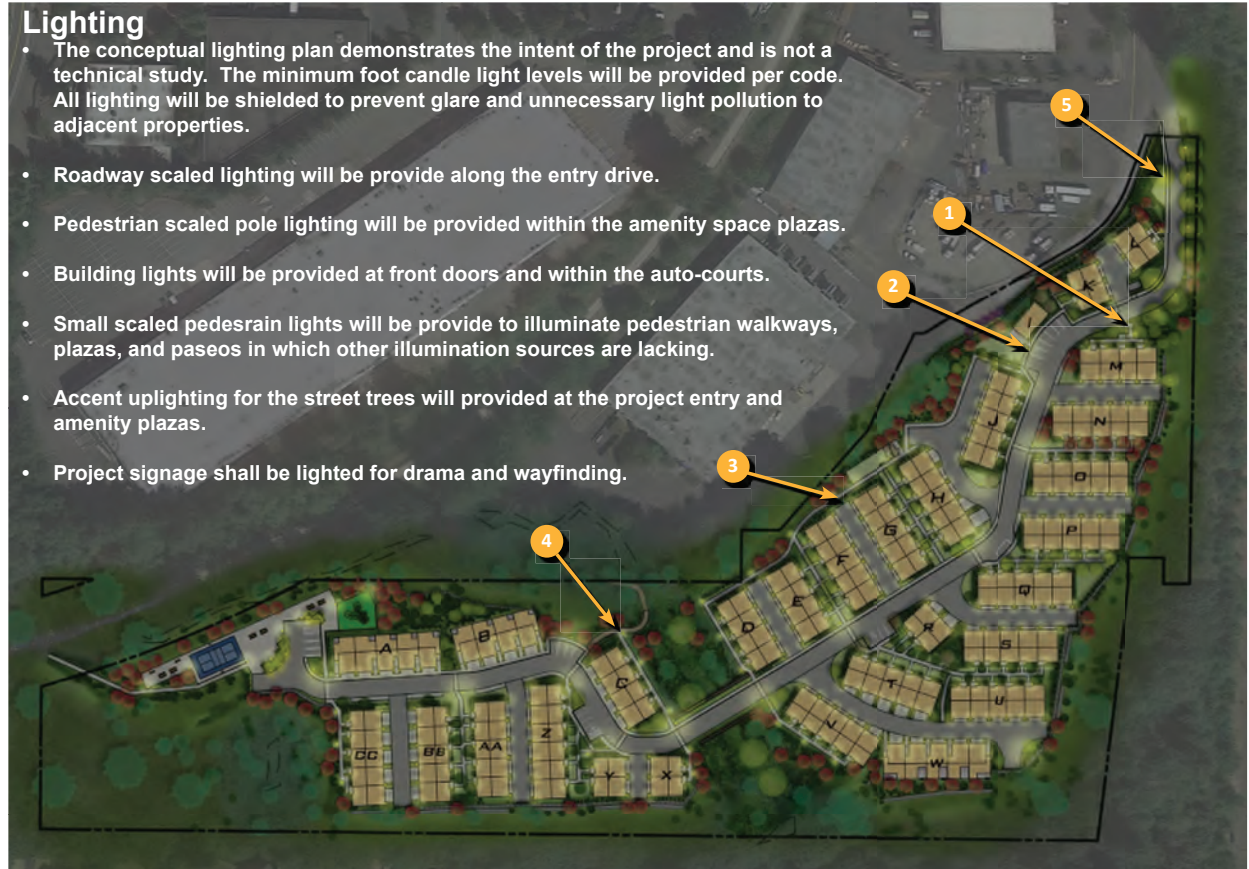

- 1 ENTRY DRIVE LIGHTING
- 3 BUILDING LIGHT SCONE
- 5 ACCENT TREE UPLIGHT

- 2 AMENITY AREA LIGHTING
- 4 SMALL SCALE PEDESTRIAN LIGHT

Schematic Lighting Concept (Plan + Features)

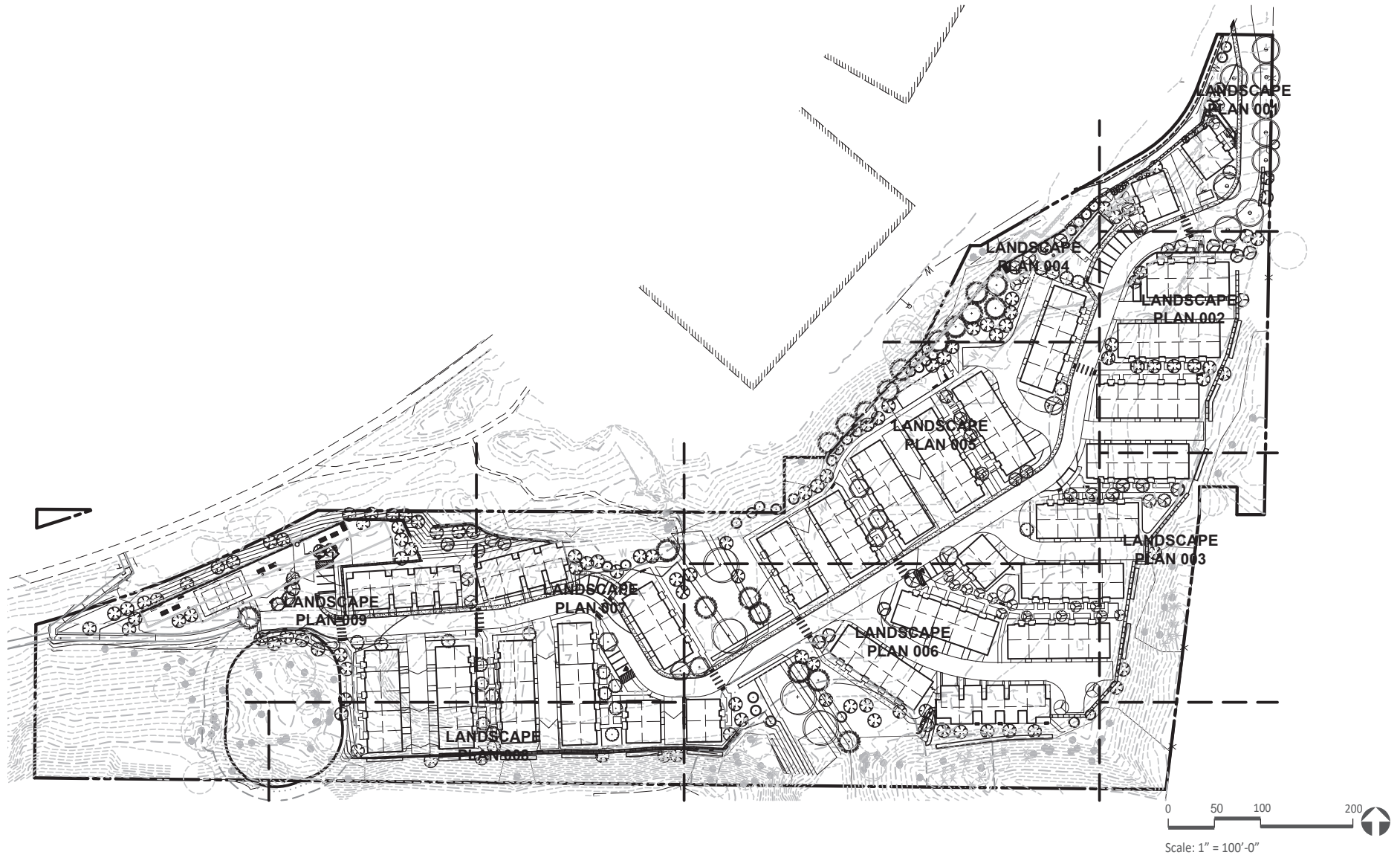

Overall Planting Plan

26

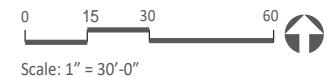
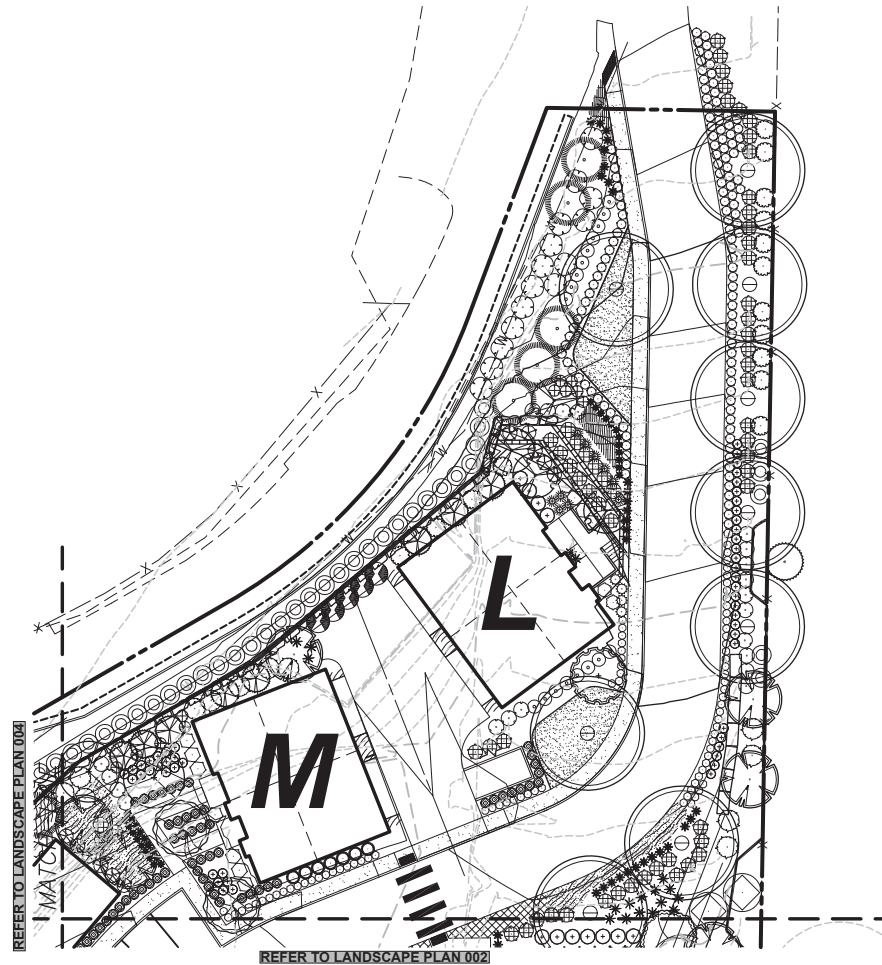

Landscape Plan - 001

27

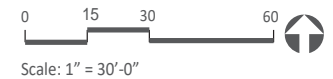
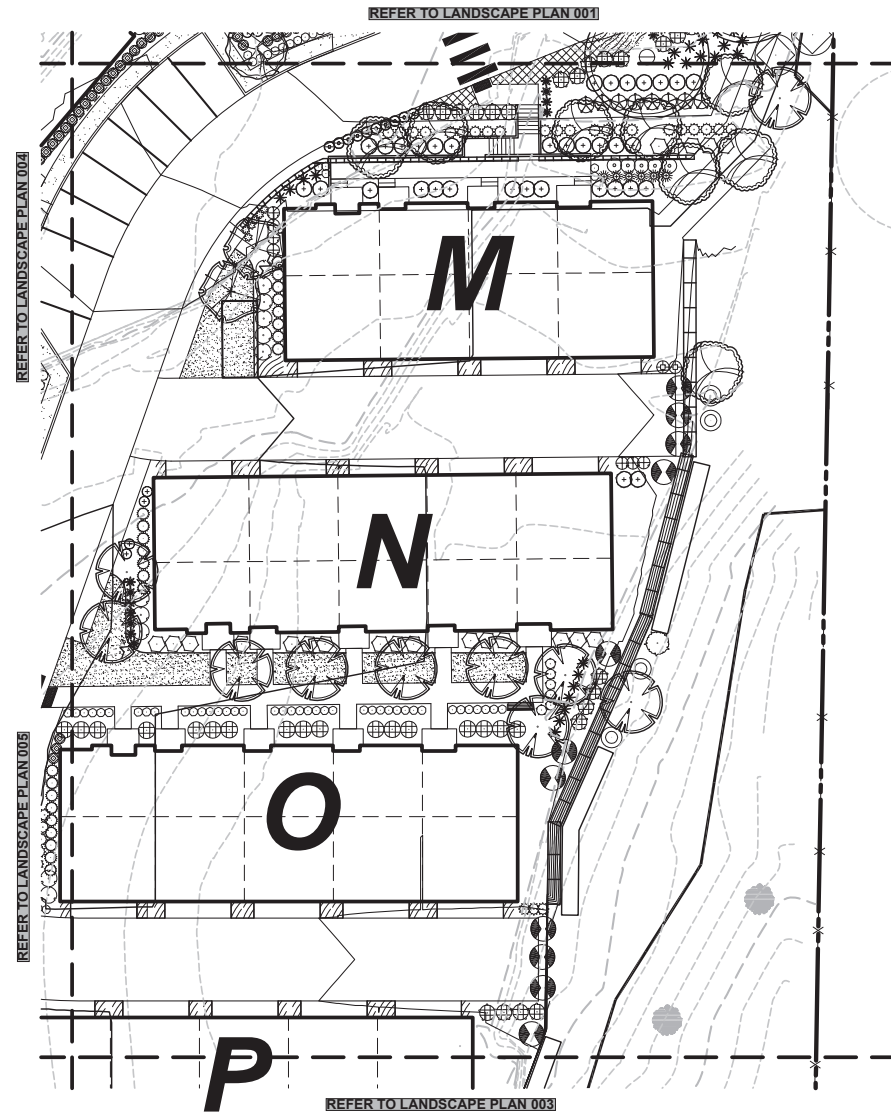

Landscape Plan - 002

28

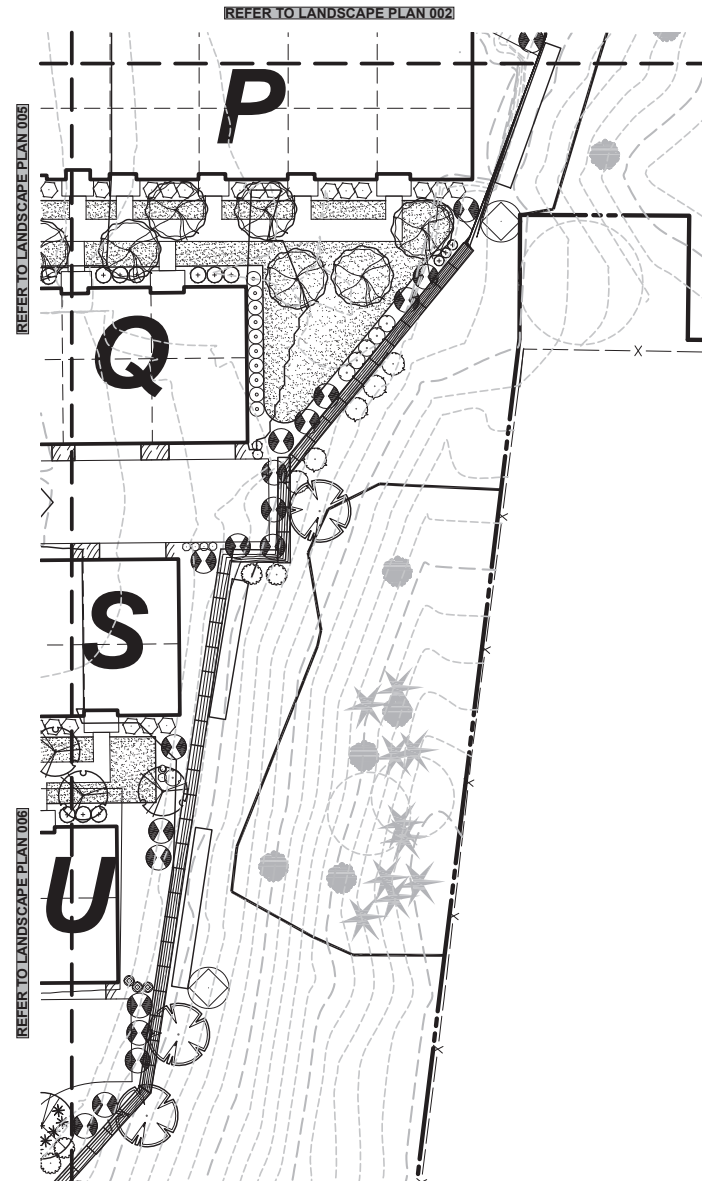

Landscape Plan - 003

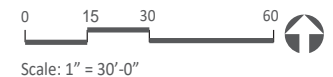

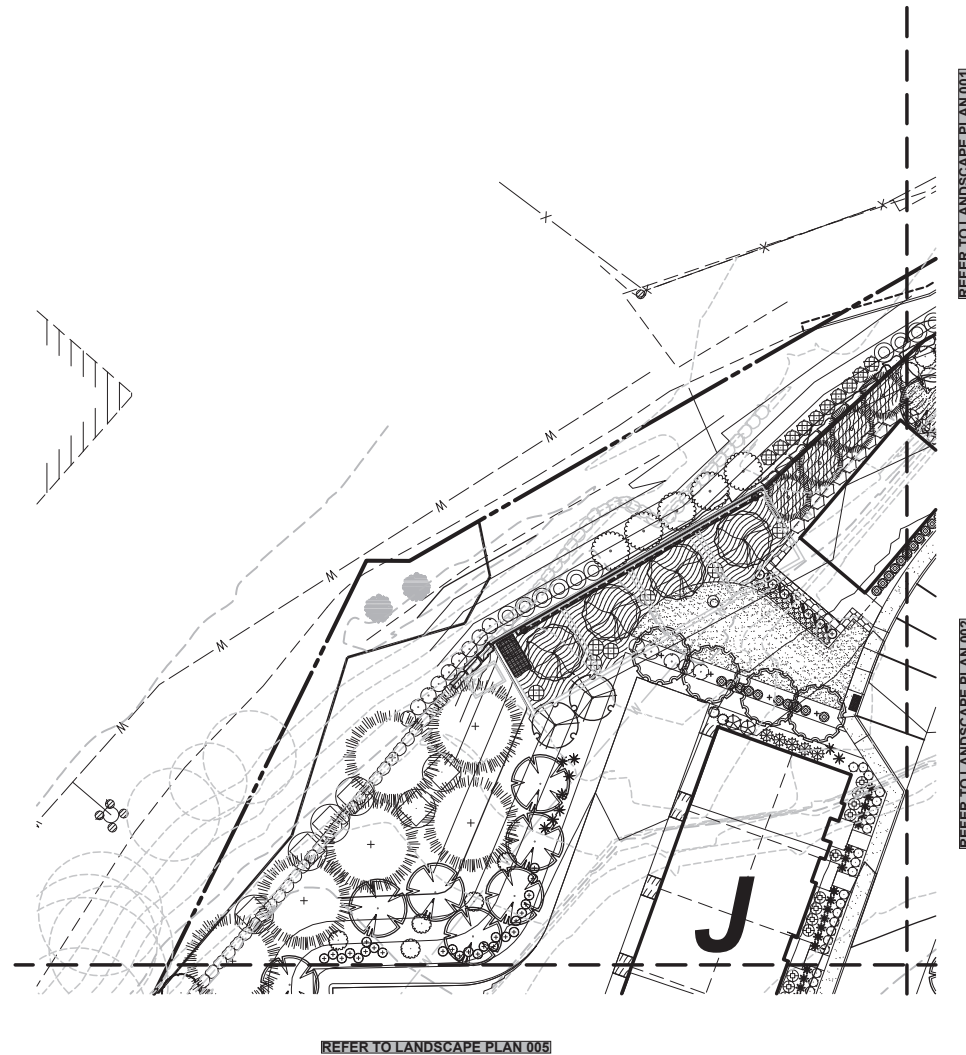

0 15 30 60
Scale: 1" = 30'-0"

Landscape Plan - 004

30