

# CITY OF KIRKLAND



## 2026 STREET OVERLAY PROJECT

JOB NO. 20-26-PW



MAY 28, 2026

STC0060026/STC0060326

### CITY OFFICIALS

KELLI CURTIS	MAYOR
NEAL BLACK	DEPUTY MAYOR
JAY ARNOLD	COUNCIL MEMBER
JOHN TYMCZYSZYN	COUNCIL MEMBER
SHILPA PREM	COUNCIL MEMBER
AMY FALCONE	COUNCIL MEMBER
JON PASCAL	COUNCIL MEMBER
KURT TRIPLETT	CITY MANAGER
JULIE UNDERWOOD	PUBLIC WORKS DIRECTOR
ROB ENGLISH, PE	CAPITAL DIVISION MANAGER

### CONTACT PERSONNEL

NAME	AGENCY	PHONE
WILL DENTON, PE	COK PROJECT ENGINEER	425.587.3872
ROD SMITH	PROJECT INSPECTOR	425.755.6224
EVAN HEIMBUCH	COK FIELD REPRESENTATIVE	425.410.4606
STEVE HOOPES	COK FIELD REPRESENTATIVE	425.623.5086
RIK MAYER	COK FIELD REPRESENTATIVE	206.496.4265
JEANNE COLEMAN	PUGET SOUND ENERGY (GAS/ELECTRIC)	425.480.2925
JAMES MARTIN	COMCAST CABLE	253.508.9127
CHERYL SCHNEIDER	ZIPLY	425.949.0230
KAYVAN FASSNACHT	CENTURYLINK/LUMEN	425.213.9378
RUSTY PERDIEU	ZAYO	706.889.6967
JAMIE LAMB	NORTHSHORE UTILITY DISTRICT	425.521.3722
TOM BAGLEY	NORTHSHORE UTILITY DISTRICT	425.471.8020
CHRISTIAN HOFFMAN	WOODINVILLE WATER DISTRICT	425.487.4142
MITCH SPENCER	KING COUNTY METRO	206.684.2732
LAURA DEGOOYER	LAKE WASH. SCHOOL DISTRICT	425.936.1133
EMERGENCY	NORCOM	911
POLICE MAIN LINE	COK	425.587.3400
FIRE MAIN LINE	COK	425.864.3650
SPILL RESPONSE HOTLINE	COK	425.587.3900
ONE CALL UTILITY LOCATE		800.424.5555
NUD 24/7 EMERGENCY	NUD DUTY PHONE	425.471.3027

### KIRKLAND



### INDEX OF DRAWINGS

SHEET NO.	DESCRIPTION
1	COVER SHEET
2	VICINITY MAP
3	NOTES AND LEGEND
4	DETAILS
5	PAVEMENT REPAIR LOCATIONS
6-7	114TH AVE NE
8	80TH PL NE
9-17	NE 134TH ST - NE 137TH ST
18-21	CURB RAMPS
22-23	TRAFFIC CONTROL DETAILS

May 28, 2026 - 2:16 PM - EMILY - Z:\2025 PROJECTS\25012 - KIRKLAND 2026 OVERLAY\PLANS\25012\_P-VMAP.DWG - Layout Name: 2 VP01

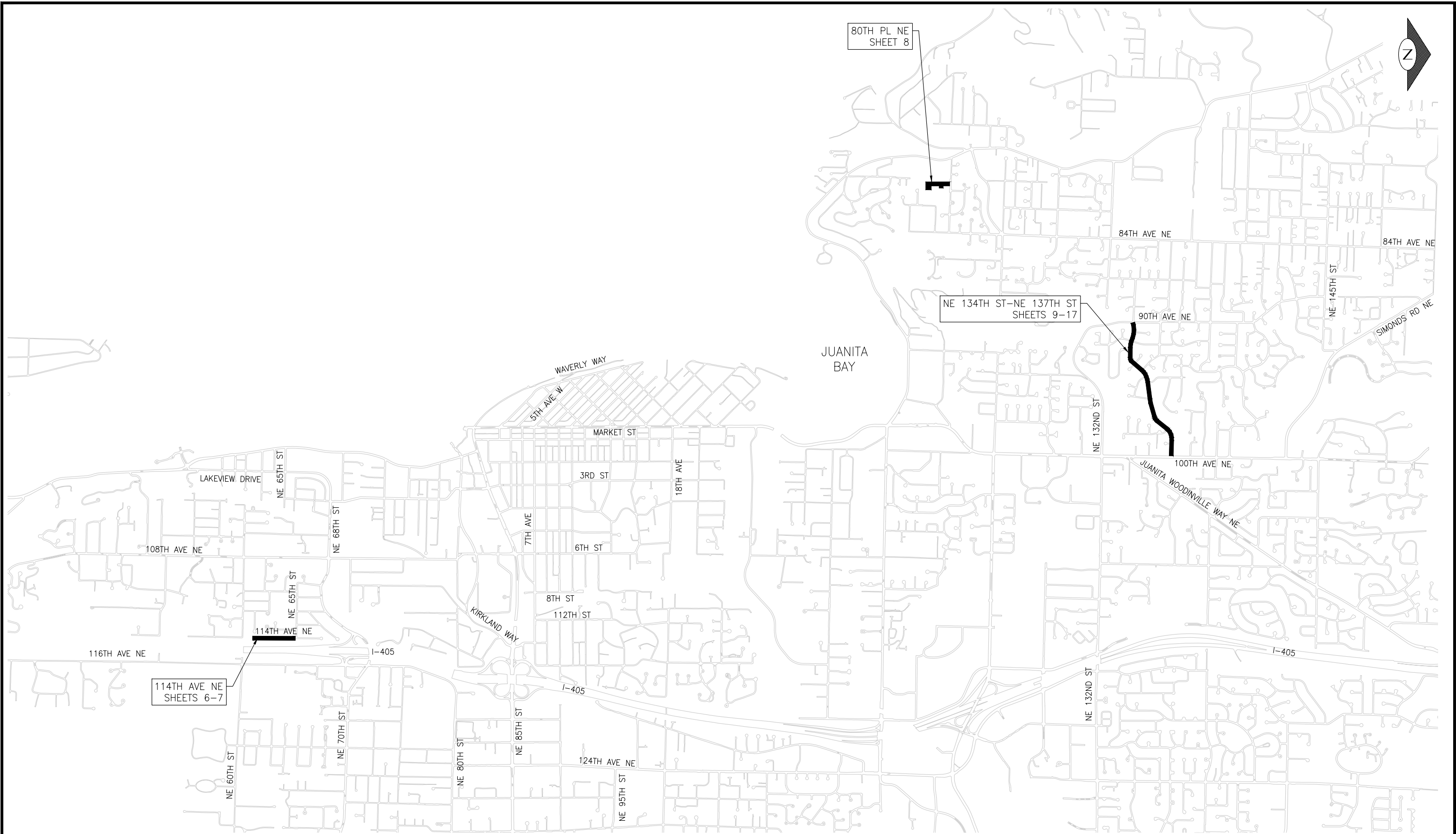

VICINITY MAP

NTS

DATE	NO.	REVISION	BY
5/28/26	0		



UPI NO.:	FED. AID PROJ. NO.:
SURVEY NO.:	FIELD BOOK(S):
HORZ. DATUM:	VERT. DATUM:
DESIGNED BY: WD	DRAWN BY: FGC

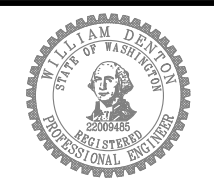

APPROVED BY: \_\_\_\_\_  
DATE: \_\_\_\_\_



CITY OF KIRKLAND  
DEPARTMENT OF PUBLIC WORKS  
123 FIFTH AVENUE KIRKLAND, WA 98033  
(425) 587-3800 www.kirklandwa.gov

**2026 STREET OVERLAY PROJECT**  
**VICINITY MAP**

REFERENCE SHEET NO.	VP01
SHEET OF SHEETS	2 OF 23

## GENERAL NOTES

1. PROVIDE MINIMUM 24 HOURS NOTICE TO ADJACENT PROPERTY OWNERS BEFORE ANY PLANING AND/OR PAVING OPERATIONS. PRE-PRINTED DOOR HANGERS WILL BE PROVIDED TO THE CONTRACTOR IN ADVANCE OF PLANING/PAVING OPERATIONS FOR DISTRIBUTION BY CONTRACTOR (SEE SPECIFICATIONS).
2. SOLID WASTE PICKUP OCCURS:  
114TH AVE NE - MONDAY  
80TH PL SE - TUESDAY  
NE 134TH ST-NE 137TH ST - THURSDAY
3. DIMENSIONS SHOWN IN PAVING PLANS ARE PAVING WIDTHS. DIMENSIONS SHOWN IN CHANNELIZATION PLANS ARE LANE WIDTHS AND INCLUDE GUTTER WIDTH.
4. FOR LIMITATIONS ON LANE CLOSURES AND ALLOWABLE WORK ACTIVITIES DURING DAY AND NIGHT HOURS SEE SPECIAL PROVISIONS INCLUDING 1-08.0(02) HOURS OF WORK.

## LANDSCAPING NOTES

1. MANY LARGE AND VALUABLE TREES ARE LOCATED WITHIN THE RIGHT-OF-WAY. CONTRACTOR SHALL EXERCISE CARE WHEN WORKING NEAR AND WITH THE TREES TO ENSURE THAT THEY ARE NOT DAMAGED DURING CONSTRUCTION.
2. PRIOR TO ANY PLANING ACTIVITIES, CONTRACTOR SHALL TRIM THE TREE CANOPY WHERE NECESSARY TO PROVIDE CLEARANCE ABOVE CONSTRUCTION EQUIPMENT. TRIMMING SHALL BE KEPT TO A MINIMUM AND ONLY BE PERFORMED AS NEEDED.
3. NO MATERIALS OR EQUIPMENT SHALL BE STOCKPILED OR OPERATED ADJACENT TO EXISTING TREES.

## UTILITY NOTES

1. PRIOR TO OVERLAY, ALL UTILITIES SHALL BE LOWERED. CONTRACTOR SHALL COORDINATE SCHEDULE WITH FRANCHISE UTILITIES TO ALLOW FOR SUFFICIENT TIME TO LOWER THESE UTILITIES.
2. ALL WATER VALVE BOXES SHALL BE UNCOVERED AND ACCESSIBLE TO THE WATER DEPARTMENT AT THE END OF EACH WORKING DAY.
3. AFTER ADJUSTING CITY OWNED WATER VALVE BOXES TO THE SURFACE OF THE NEW HMA OVERLAY, ALL WATER VALVE BOX LIDS SHALL BE PAINTED BLUE. SEE CONTRACT SPECIFICATIONS.

## PAVEMENT REPAIR NOTES

1. PAVEMENT REPAIR LIMITS SHOWN ON PLANS ARE BASED ON A VISUAL ASSESSMENT OF THE EXISTING PAVEMENT SURFACE AND PAVEMENT CORES. AFTER THE INITIAL PLANING OF THE ROAD SURFACE IS COMPLETE, THE CITY WILL INSPECT THE PLANED SURFACE AND ADJUST THE LIMITS OF PAVEMENT REPAIR AS NECESSARY BASED ON VISUAL OBSERVATIONS.
2. SAWCUT OR PLANE AT PAVEMENT REPAIR LIMITS AND REMOVE TO DEPTH SHOWN IN DETAILS.
3. AT PAVEMENT REPAIR LOCATIONS, THE CITY WILL INSPECT THE EXPOSED COMPACTED SUBGRADE. AFTER REVIEW OF THE SUBGRADE, THE CITY WILL INFORM THE CONTRACTOR WHETHER ADDITIONAL (DEEPER) EXCAVATION IS REQUIRED FOR PAVEMENT REPAIR. ANY ADDITIONAL EXCAVATION BELOW THE PAVEMENT REPAIR SECTIONS SHALL BE BACKFILLED WITH CRUSHED SURFACING BASE COURSE. IF ADDITIONAL EXCAVATION AND BACKFILL IS REQUIRED, IT SHALL BE PAID FOR UNDER THE "UNSCHEDULED PAVEMENT REPAIR" BID ITEM.
4. COMPACT ALL SUBGRADE AND GRANULAR MATERIALS TO 95% MAX DRY DENSITY AS DETERMINED BY ASTM D1557 (MODIFIED PROCTOR).





## CHANNELIZATION NOTES

1. ALL PAINT STRIPES SHALL CONSIST OF TWO APPLICATIONS OVER NEW ASPHALT.
2. CHANNELIZATION NOTES ON DRAWINGS ARE SPECIFIC TO EACH ROADWAY.

## CONCRETE WORK NOTES

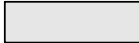
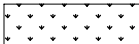
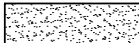
1. SAWCUT 2' FROM FACE OF GUTTER TO REMOVE AND REPLACE ASPH IN FRONT OF ALL CURB AND GUTTER, ROLLED CURB, AND CURB RAMP WORK.
2. SEE DTL 6, SHEET 4 FOR HMA RESTORATION FOR CONCRETE WORK.

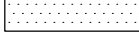
## LEGEND

---	RIGHT-OF-WAY	⊕ MON	MONUMENT
-----	SAWCUT, FULL DEPTH	⊕ SIGN	SIGN
	PLANE BITUMINOUS PAVEMENT AND PLACE HMA OVERLAY, DEPTH PER PAVING PLANS	⊕ SSMH	SANITARY SEWER MANHOLE
====	CEM CONC CURB AND GUTTER	⊕ CB	CATCH BASIN
====	CEM CONC ROLLED CURB	⊕ SDMH	STORM DRAIN MANHOLE
	TURF/SEEDED LAWN	⊕ WV	WATER VALVE
	CRUSHED SURFACING TOP COURSE, DEPTH PER PLANS	⊕ FH	FIRE HYDRANT
	ASPH DRIVEWAY	⊕ WM	WATER METER
	CONC DRIVEWAY	⊕ LP	LIGHT POLE
	HMA LEVELING LIFT (DEPTH VARIES)	⊕ UP	UTILITY POLE
	FULL DEPTH HMA REPAIR PER DTL 5, SHEET 4	⊕ TEL	TELECOMMUNICATIONS MANHOLE
		⊕ MB	MAILBOX
		⊕ GV	GAS VALVE
		⊕ COM	COMMUNICATIONS VAULT

## ABBREVIATIONS

COK	CITY OF KIRKLAND
STD	STANDARD
R/W	RIGHT-OF-WAY
ASPH	ASPHALT
CONC	CONCRETE
HMA	HOT MIX ASPHALT
DWY	DRIVEWAY
STD	STANDARD
RPM	RAISED PAVEMENT MARKER
WSDOT	WASHINGTON STATE DEPARTMENT OF TRANSPORTATION
DTL	DETAIL
C&G	CURB AND GUTTER
CL	CLASS
CEM	CEMENT
TYP	TYPICAL
SW	SIDEWALK
EX	EXISTING
CONT	CONTINUED
NB	NORTH BOUND
SB	SOUTH BOUND
STA	STATION
EOP	EDGE OF PAVEMENT
LF	LINEAR FEET
TYP	TYPICAL

May 28, 2026 - 2:16 PM - FLAVIO - Z:\2025 PROJECTS\25012 - KIRKLAND 2026 OVERLAYS\PLANS\25012\_P-DTL.DWG - Layout Name: NT01

5/28/26	0		
DATE	NO.	REVISION	BY



UPI NO.:	FED. AID PROJ. NO.:
SURVEY NO.:	FIELD BOOK(S):
HORIZ. DATUM:	VERT. DATUM:
DESIGNED BY: WD	DRAWN BY: FGC



APPROVED BY:	
DATE:	



CITY OF KIRKLAND  
DEPARTMENT OF PUBLIC WORKS  
123 FIFTH AVENUE KIRKLAND, WA 98033  
(425) 587-3800 www.kirklandwa.gov

<b>2026 STREET OVERLAY PROJECT</b>
<b>NOTES AND LEGEND</b>

REFERENCE SHEET NO. NT01
SHEET 3 OF 23 SHEETS

May 28, 2026 - 2:17 PM - FLAVIO - Z:\2025 PROJECTS\25012 - KIRKLAND 2026 OVERLAYS\PLANS\25012\_P-DTL.DWG - Layout Name: DT01

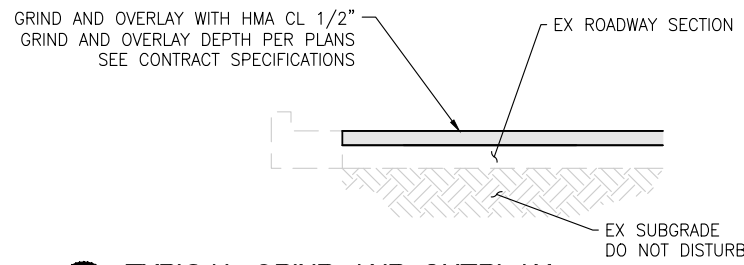

**1 TYPICAL GRIND AND OVERLAY**  
NTS

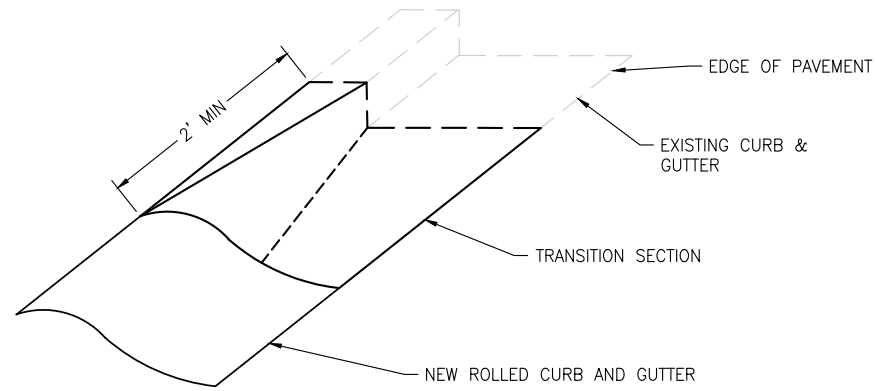

**2 ROLLED CURB TRANSITION**  
NTS

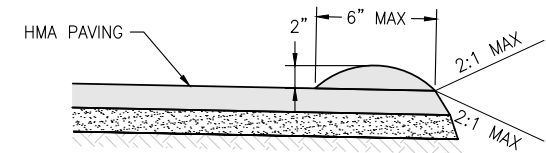

**4 TYPICAL HMA BERM**  
NTS

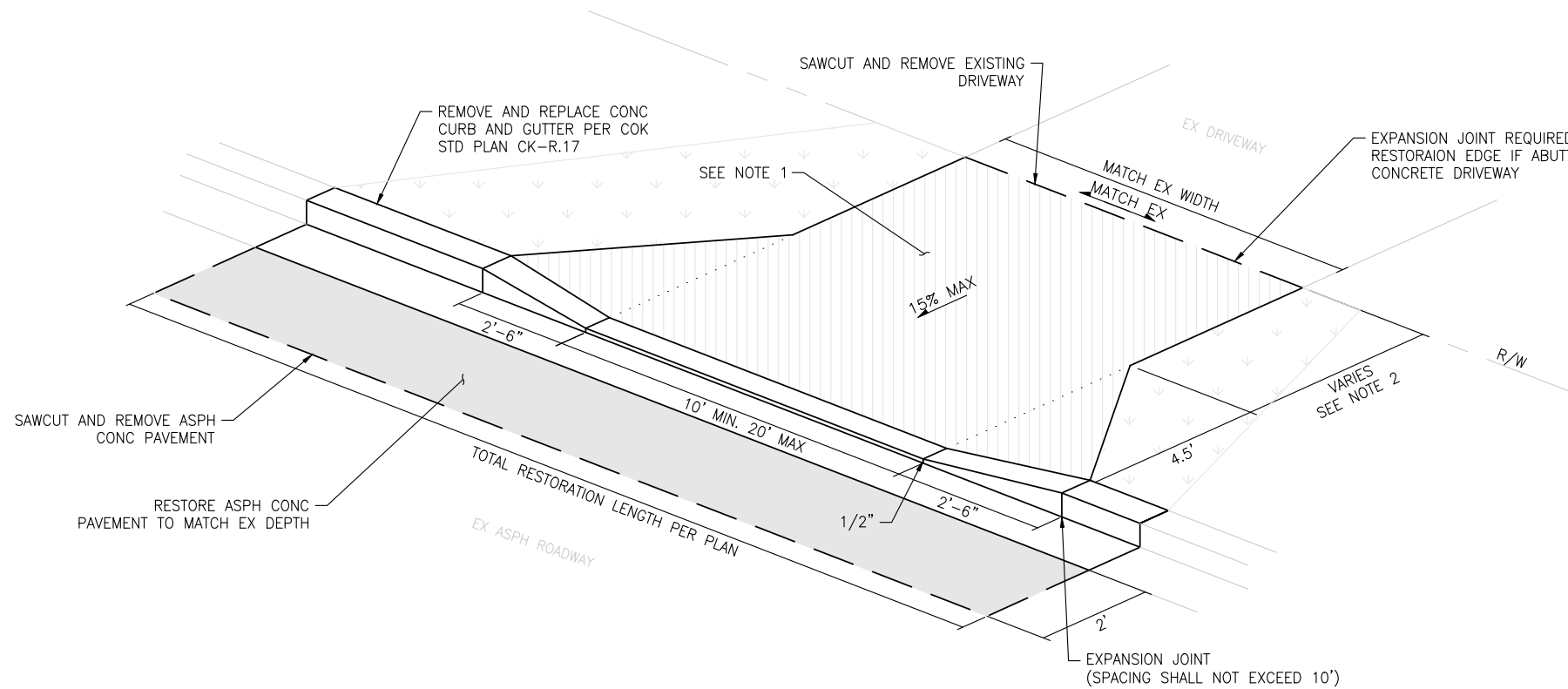

- NOTES**
- RESTORE DRIVEWAY TO MATCH EXISTING DRIVEWAY MATERIAL. (6" CEMENT CONCRETE DRIVEWAY ENTRANCE OR 6" ASPH DRIVEWAY ENTRANCE)
  - DRIVEWAY RESTORATION DOES NOT HAVE TO GO TO THE R/W IF 15% MAX CAN BE ACHIEVED AND THE EXISTING DRIVEWAY MATERIAL TO REMAIN IS IN GOOD CONDITION.

**3 DRIVEWAY ENTRANCE RESTORATION**  
NTS

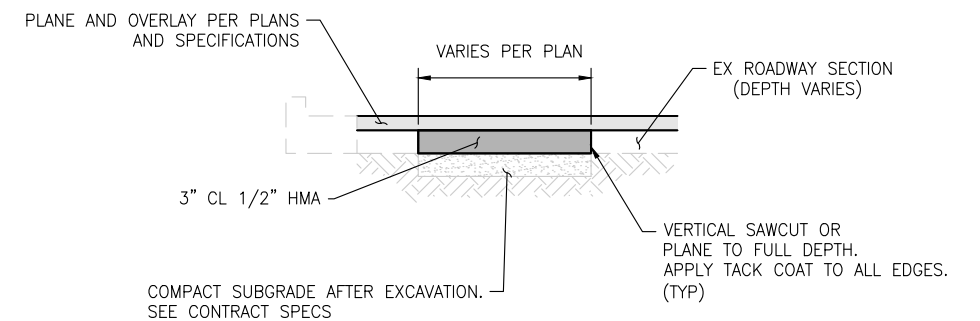

**5 FULL DEPTH HMA PAVEMENT REPAIR DETAIL**  
NTS

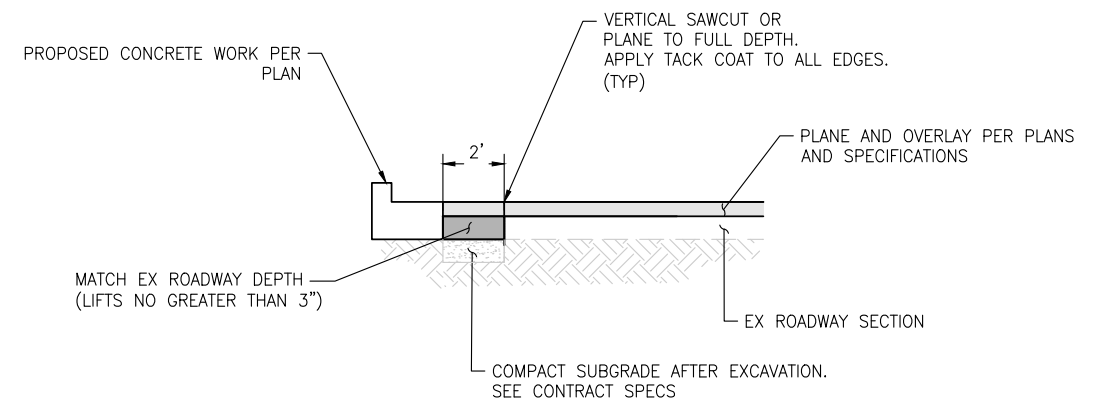

**6 HMA RESTORATION FOR CONCRETE WORK**  
NTS

5/28/26	0			
DATE	NO.	REVISION	BY	



UPI NO.:	FED. AID PROJ. NO.:
SURVEY NO.:	FIELD BOOK(S):
HORZ. DATUM:	VERT. DATUM:
DESIGNED BY: WD	DRAWN BY: FGC



APPROVED BY: \_\_\_\_\_  
DATE: \_\_\_\_\_



CITY OF KIRKLAND  
DEPARTMENT OF PUBLIC WORKS  
123 FIFTH AVENUE KIRKLAND, WA 98033  
(425) 587-3800 www.kirklandwa.gov

**2026 STREET OVERLAY PROJECT DETAILS**

REFERENCE SHEET NO. DT01  
SHEET 4 OF 23 SHEETS

# PAVEMENT REPAIR EXCAVATION APPROXIMATE LOCATIONS

## 114TH AVE NE

	DISTANCE FROM EOP TO NEAREST EDGE OF REPAIR AREA (FT)		DISTANCE FROM EOP TO NEAREST EDGE OF REPAIR AREA (FT)	LENGTH (FT)	WIDTH (FT)	HMA - 3" DEPTH (TON)	AREA (SY)
STA		STA					
17+14	8	17+57	6	43	8	9	38

## NE 134TH ST - NE 137TH ST

	DISTANCE FROM EOP TO NEAREST EDGE OF REPAIR AREA (FT)		DISTANCE FROM EOP TO NEAREST EDGE OF REPAIR AREA (FT)	LENGTH (FT)	WIDTH (FT)	HMA - 3" DEPTH (TON)	AREA (SY)
STA		STA					
10+33	6.5	40+00	6	2967	20	1502	6593
18+91	0	19+52	0	61	6	9	41
34+57	0	35+10	0	53	7	9	41
35+23	0	35+93	0	40	4.5	8	35
40+00	0	45+84	0	584	34.5	510	2239

May 28, 2026 - 2:17 PM - FLAVIO - Z:\2025 PROJECTS\25012 - KIRKLAND 2026 OVERLAYS\PLANS\25012\_P\_DTL.DWG - Layout Name: QT01

DATE	NO.	REVISION	BY
5/28/26	0		



UPI NO.:	FED. AID PROJ. NO.:
SURVEY NO.:	FIELD BOOK(S):
HORZ. DATUM:	VERT. DATUM:
DESIGNED BY: WD	DRAWN BY: EAS

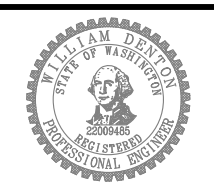

APPROVED BY: \_\_\_\_\_  
DATE: \_\_\_\_\_



CITY OF KIRKLAND  
DEPARTMENT OF PUBLIC WORKS  
123 FIFTH AVENUE KIRKLAND, WA 98033  
(425) 587-3800 www.kirklandwa.gov

**2026 STREET OVERLAY PROJECT**  
PAVEMENT REPAIR LOCATIONS

REFERENCE SHEET NO. QT01  
SHEET 5 OF 23 SHEETS

May 28, 2026 - 2:17 PM - FLAVIO - Z:\2025 PROJECTS\25012 - KIRKLAND 2026 OVERLAY\PLANS\25012\_P\_OVLV - 114TH AVE NE.DWG - Layout Name: PLAN

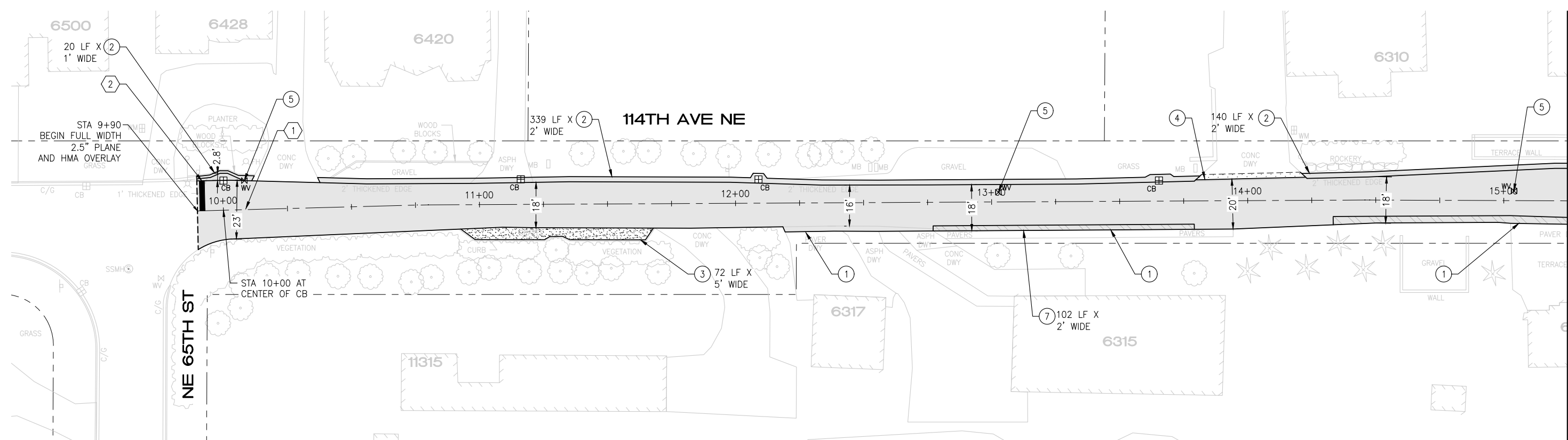
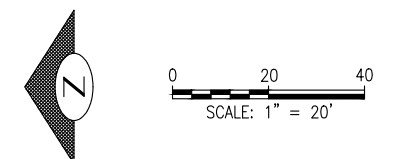

**CONSTRUCTION NOTES**

- ① PAVERS TO BE PROTECTED. DISTURBED PAVERS TO BE RECONSTRUCTED TO MATCH EXISTING CONDITIONS AT THE CONTRACTOR'S EXPENSE
- ② THICKENED EDGE PER COK STD PLAN CK-R.11. MATCH EXISTING WIDTH OR AS NOTED.
- ③ INSTALL 2" CRUSHED SURFACING TOP COURSE
- ④ REMOVE 6" OF CEMENT CONCRETE DRIVE ENTRANCE. PAVE HMA TO NEW EDGE
- ⑤ REPLACE WATER VALVE BOX WITH NEW TOP SECTION AND COVER PER COK STD PLAN CK-W.35
- ⑥ REPLACE WATER METER FRAME AND COVER (OWNER FURNISHED)
- ⑦ APPLY TACK COAT AND PAVE LEVELING LIFT (DEPTH VARIES)
- ⑧ PAVE HMA BERM PER DTL 4, SHEET 4
- ⑨ PAVEMENT REPAIR PER DTL 5, SHEET 4
- ⑩ REPLACE SSMH FRAME AND COVER (OWNER FURNISHED)

**PAVING NOTES**

- PLANE PAVEMENT, 2.5" DEEP, FULL WIDTH
- PAVE LEVELING LIFT IN LOCATIONS PER PLAN (DEPTH VARIES)
- APPLY FABRIC REINFORCEMENT LAYER TO MILLED AND/OR LEVELING LIFT SURFACE
- OVERLAY FULL WIDTH WITH 2.5" HMA CL 1/2"

**CHANNELIZATION NOTES**

- ① BLUE TYPE 2B RPM AT FIRE HYDRANT PER STD PLAN CK-R.29
- ② WHITE THERMOPLASTIC STOP BAR PER COK STD PLAN CK-R.28

DATE	NO	REVISION	BY
5/20/26	0		



UPI NO.:	FED. AID PROJ. NO.:
SURVEY NO.:	FIELD BOOK(S):
HORZ. DATUM:	VERT. DATUM:
DESIGNED BY: WD	DRAWN BY: FGC

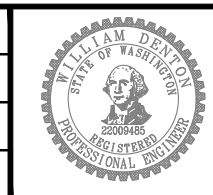

APPROVED BY: \_\_\_\_\_  
DATE: \_\_\_\_\_



CITY OF KIRKLAND  
DEPARTMENT OF PUBLIC WORKS  
123 FIFTH AVENUE KIRKLAND, WA 98033  
(425) 587-3800 www.kirklandwa.gov

**2026 STREET OVERLAY PROJECT**  
**114TH AVE NE**  
**9+90 TO 15+25**

REFERENCE SHEET NO. PV01  
SHEET 6 OF 23 SHEETS

May 28, 2026 - 2:17 PM - FLAVIO - Z:\2025 PROJECTS\25012 - KIRKLAND 2026 OVERLAY\PLANS\25012\_P\_OVLV - 114TH AVE NE.DWG - Layout Name: PLAN (2)

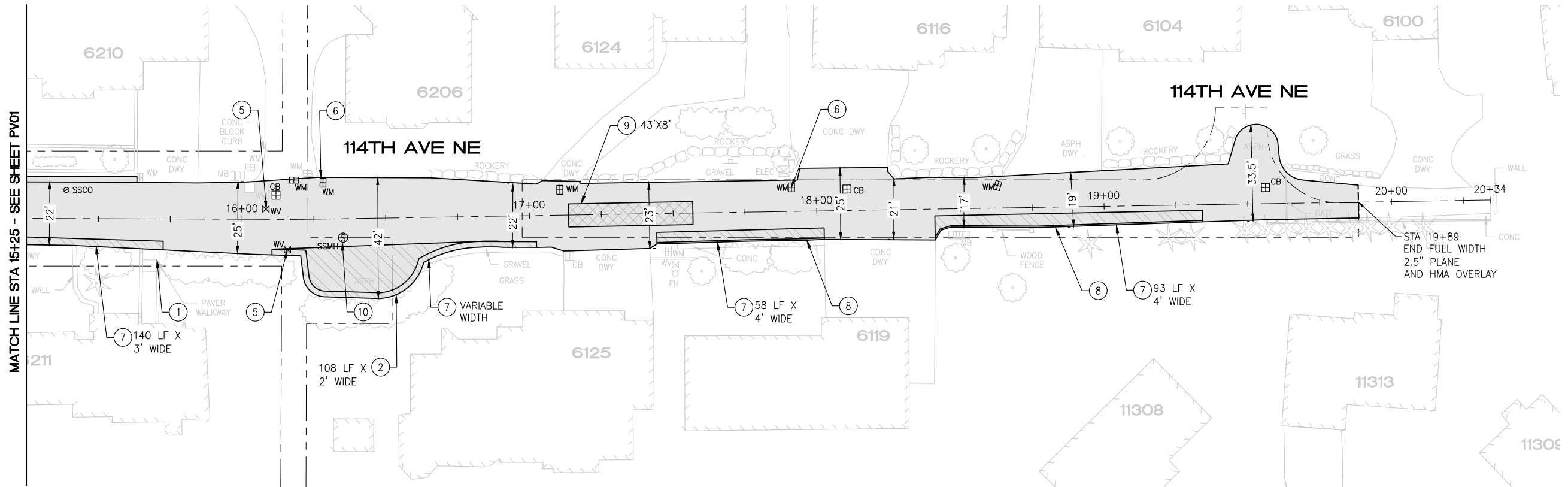
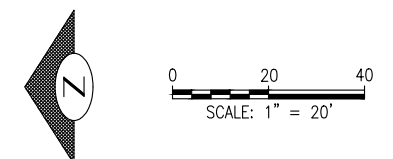

**CONSTRUCTION NOTES**

- ① PAVERS TO BE PROTECTED. DISTURBED PAVERS TO BE RECONSTRUCTED TO MATCH EXISTING CONDITIONS AT THE CONTRACTOR'S EXPENSE
- ② THICKENED EDGE PER COK STD PLAN CK-R.11. MATCH EXISTING WIDTH OR AS NOTED.
- ③ INSTALL 2" CRUSHED SURFACING TOP COURSE
- ④ REMOVE 6" OF CEMENT CONCRETE DRIVE ENTRANCE. PAVE HMA TO NEW EDGE
- ⑤ REPLACE WATER VALVE BOX WITH NEW TOP SECTION AND COVER PER COK STD PLAN CK-W.35
- ⑥ REPLACE WATER METER FRAME AND COVER (OWNER FURNISHED)
- ⑦ APPLY TACK COAT AND PAVE LEVELING LIFT (DEPTH VARIES)
- ⑧ PAVE HMA BERM PER DTL 4, SHEET 4
- ⑨ PAVEMENT REPAIR PER DTL 5, SHEET 4
- ⑩ REPLACE SSMH FRAME AND COVER (OWNER FURNISHED)

**PAVING NOTES**

- PLANE PAVEMENT, 2.5" DEEP, FULL WIDTH
- PAVE LEVELING LIFT IN LOCATIONS PER PLAN (DEPTH VARIES)
- APPLY FABRIC REINFORCEMENT LAYER TO MILLED AND/OR LEVELING LIFT SURFACE
- OVERLAY FULL WIDTH WITH 2.5" HMA CL 1/2"

**CHANNELIZATION NOTES**

- ① BLUE TYPE 2B RPM AT FIRE HYDRANT PER STD PLAN CK-R.29

5/20/26	0			
DATE	NO	REVISION	BY	



UPI NO.:	FED. AID PROJ. NO.:
SURVEY NO.:	FIELD BOOK(S):
HORZ. DATUM:	VERT. DATUM:
DESIGNED BY: WD	DRAWN BY: FGC

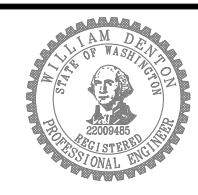

APPROVED BY: \_\_\_\_\_  
DATE: \_\_\_\_\_



CITY OF KIRKLAND  
DEPARTMENT OF PUBLIC WORKS  
123 FIFTH AVENUE KIRKLAND, WA 98033  
(425) 587-3800 www.kirklandwa.gov

**2026 STREET OVERLAY PROJECT**  
**114TH AVE NE**  
**15+25 TO 20+34**

REFERENCE SHEET NO. PV02  
SHEET 7 OF 23 SHEETS



May 28, 2026 - 2:16 PM - FLAVIO - Z:\2025 PROJECTS\25012 - KIRKLAND 2026 OVERLAYS\PLANS\25012\_P-OVLY-NE 134TH ST.DWG - Layout Name: PV (2)

90TH AVE NE

90TH PL NE

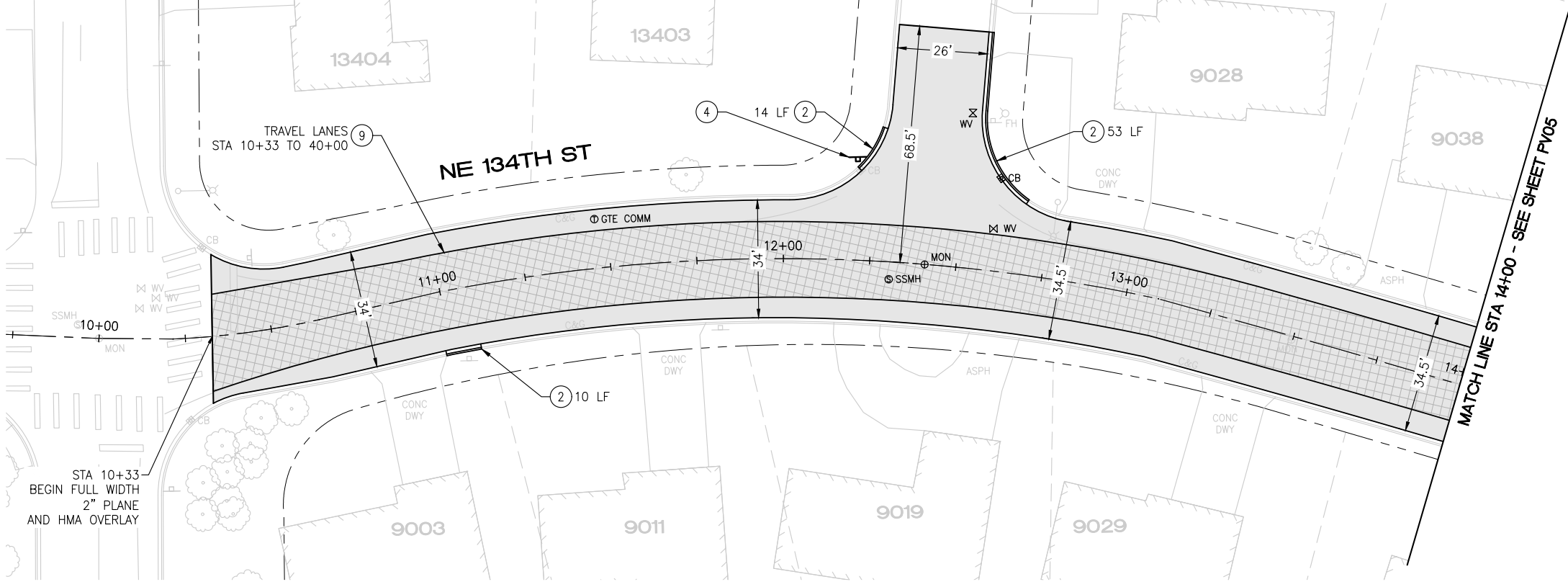

PAVING PLAN

90TH AVE NE

90TH PL NE

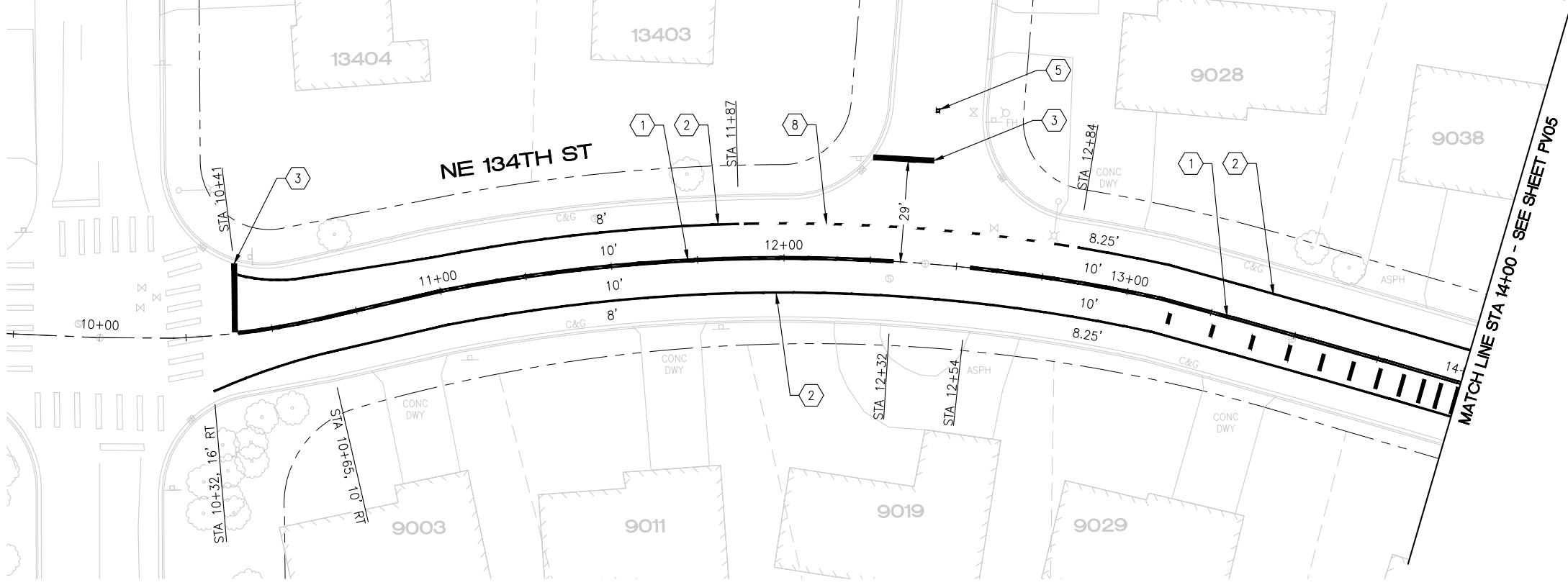

CHANNELIZATION PLAN

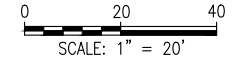

**CONSTRUCTION NOTES**

- ① CURB AND GUTTER ALONG 76 GAS STATION PROPERTY SHALL BE REPLACED IN A MANNER THAT PROVIDES FOR CONTINUOUS AND UNFETTERED USE OF ONE OF THE TWO DRIVEWAY ENTRANCES
- ② REMOVE AND REPLACE CONC CURB AND GUTTER PER COK STD PLAN CK-R.17. SEE DTL 6, SHEET 4 FOR HMA RESTORATION
- ③ INSTALL 6' INDUCTION LOOP TYPE 3 PER WSDOT STD PLANS J-50.12-02 AND J-50.15.01
- ④ REMOVE EXISTING STOP SIGN AND POLE. REPLACE WITH NEW POLE, STREET NAME SIGNS, AND STOP SIGN PER COK STD PLANS CK-R.01 AND CK-R.44.
- ⑤ REMOVE AND REPLACE CONC SIDEWALK PER COK STD PLAN CK-R.23
- ⑥ SAWCUT AND REMOVE 2' ASPH CONC PAVEMENT BEHIND CURB. RESTORE ASPH CONC PAVEMENT TO MATCH EXISTING DEPTH.
- ⑦ RESTORE DRIVEWAY ENTRANCE PER DTL 3, SHEET 4
- ⑧ EXPOSE 4 LF OF YARD DRAIN PIPING AND REPLACE WITH 4 LF 4" PVC SCH 40 PIPE. TIE INTO EXISTING PIPE, AND CAST OUTLET INTO NEW CURB FACE. COST SHALL BE INCIDENTAL TO CURB REPLACEMENT COST.
- ⑨ PAVEMENT REPAIR PER DTL 5, SHEET 4
- ⑩ REMOVAL AND REPLACEMENT OF CURB AND DRIVEWAY ENTRANCE SHALL BE PERFORMED IN TWO PHASES, SPLIT BETWEEN THE EAST AND WEST HALVES, TO MAINTAIN CONTINUOUS INGRESS AND EGRESS TO THE PROPERTY.

**PAVING NOTES**

- PLANE PAVEMENT, 2" DEEP, FULL WIDTH
- EXCAVATE PAVEMENT REPAIR AREAS ADDITIONAL 3" DEEP
- REPLACE PAVEMENT REPAIR AREAS WITH 3" HMA CL 1/2"
- PAVE 2" HMA CL 1/2" WEARING COURSE (FIBER REINFORCED), FULL WIDTH

**CHANNELIZATION NOTES**

- ① PAINTED DOUBLE YELLOW CENTER LINE WITH TYPE 2YY RPMS PER COK STD PLAN CK-R.31
- ② PAINTED 6" WHITE EDGE LINE PER COK PLAN CK-R.35
- ③ WHITE THERMOPLASTIC STOP BAR PER COK STD PLAN CK-R.28
- ④ WHITE THERMOPLASTIC CROSSWALK PER COK STD PLAN CK-R.28
- ⑤ BLUE TYPE 2B RPM AT FIRE HYDRANT PER STD PLAN CK-R.29
- ⑥ THERMOPLASTIC TRANSVERSE BAR PAVEMENT MARKING PATTERN PER COK STD PLAN CK-R.38
- ⑦ RED PAINT ON TOP AND FACE OF CURB
- ⑧ PAINTED 6" WHITE BROKEN LINE CONSISTING OF 2' STRIPE SEGMENTS AND 6' SPACES
- ⑨ TYPE 3SR TRAFFIC ARROW PER WSDOT STD PLAN M-24.40-02
- ⑩ TYPE 2SL TRAFFIC ARROW PER WSDOT STD PLAN M-24.40-02
- ⑪ 8" WHITE THERMOPLASTIC GORE STRIPE PER COK STD PLAN CK-R.29

5/28/26	0		
DATE	NO.	REVISION	BY



UPI NO.:	FED. AID PROJ. NO.:
SURVEY NO.:	FIELD BOOK(S):
HORZ. DATUM:	VERT. DATUM:
DESIGNED BY: WD	DRAWN BY: FGC

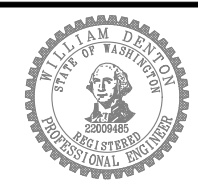

APPROVED BY: \_\_\_\_\_  
DATE: \_\_\_\_\_



CITY OF KIRKLAND  
DEPARTMENT OF PUBLIC WORKS  
123 FIFTH AVENUE, KIRKLAND, WA 98033  
(425) 587-3800 www.kirklandwa.gov

**2026 STREET OVERLAY PROJECT**  
**NE 134TH ST**  
**10+00 TO 14+00**

REFERENCE SHEET NO. PV04  
SHEET 9 OF 23 SHEETS



May 28, 2026 - 2:18 PM - FLAVIO - Z:\2025 PROJECTS\25012 - KIRKLAND 2026 OVERLAYS\PLANS\25012\_P-OVLY-NE 134TH ST.DWG - Layout Name: PV (4)

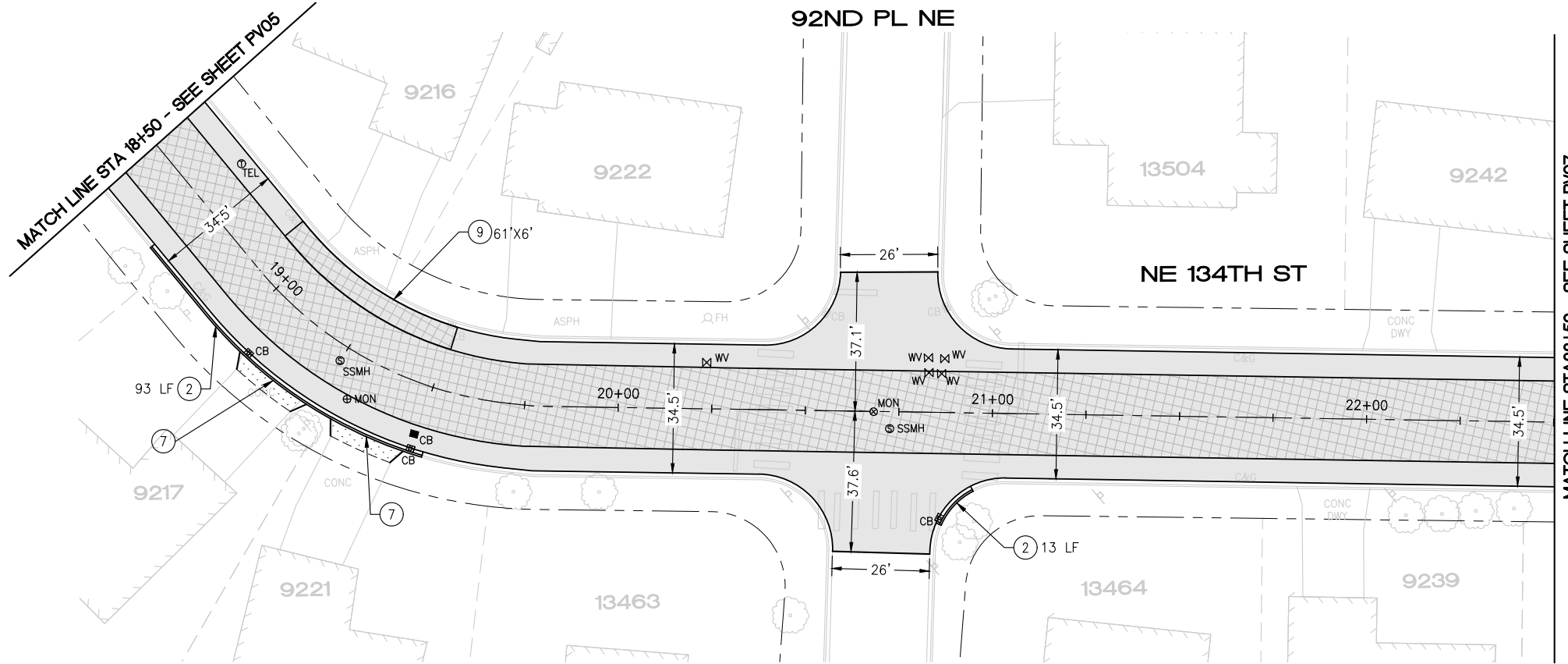

**PAVING PLAN**  
92ND PL NE

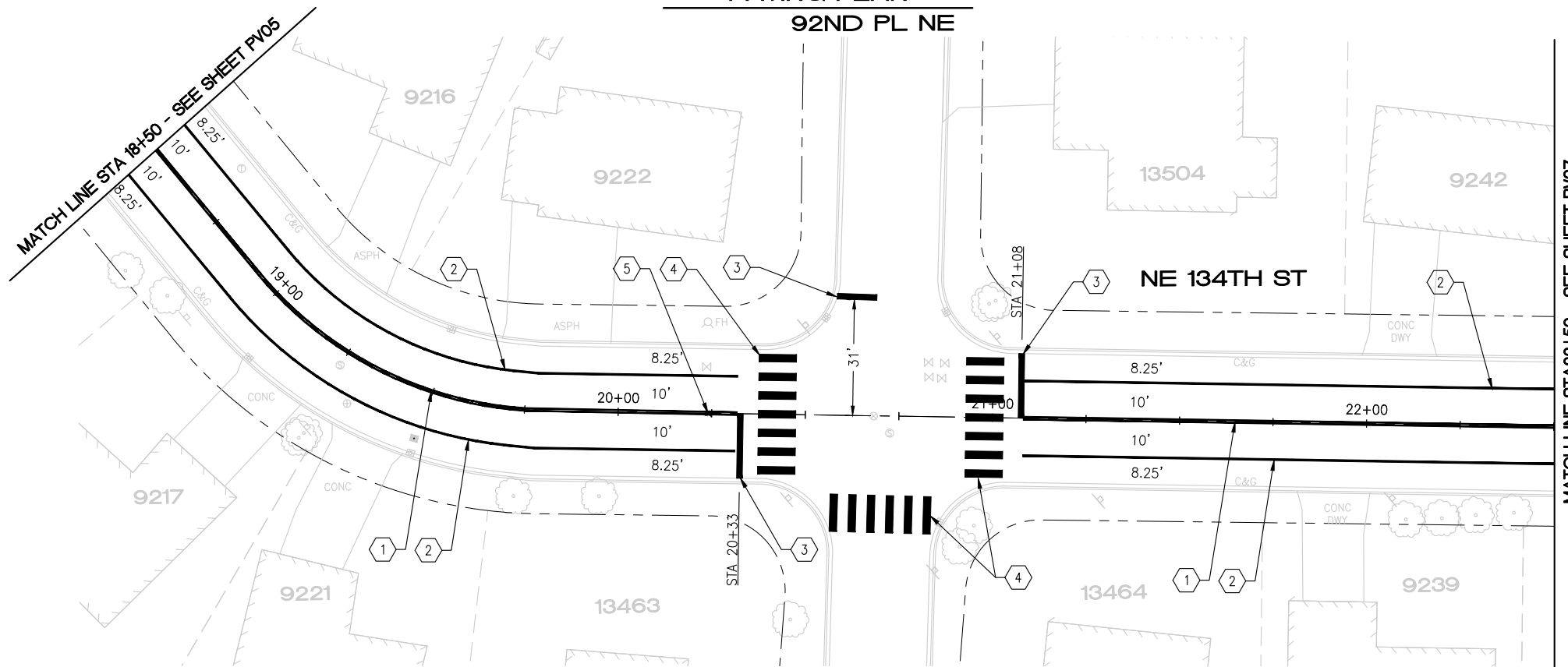

**CHANNELIZATION PLAN**



0 20 40  
SCALE: 1" = 20'

**CONSTRUCTION NOTES**

- ① CURB AND GUTTER ALONG 76 GAS STATION PROPERTY SHALL BE REPLACED IN A MANNER THAT PROVIDES FOR CONTINUOUS AND UNFETTERED USE OF ONE OF THE TWO DRIVEWAY ENTRANCES
- ② REMOVE AND REPLACE CONC CURB AND GUTTER PER COK STD PLAN CK-R.17. SEE DTL 6, SHEET 4 FOR HMA RESTORATION
- ③ INSTALL 6' INDUCTION LOOP TYPE 3 PER WSDOT STD PLANS J-50.12-02 AND J-50.15.01
- ④ REMOVE EXISTING STOP SIGN AND POLE. REPLACE WITH NEW POLE, STREET NAME SIGNS, AND STOP SIGN PER COK STD PLANS CK-R.01 AND CK-R.44.
- ⑤ REMOVE AND REPLACE CONC SIDEWALK PER COK STD PLAN CK-R.23
- ⑥ SAWCUT AND REMOVE 2' ASPH CONC PAVEMENT BEHIND CURB. RESTORE ASPH CONC PAVEMENT TO MATCH EXISTING DEPTH.
- ⑦ RESTORE DRIVEWAY ENTRANCE PER DTL 3, SHEET 4
- ⑧ EXPOSE 4 LF OF YARD DRAIN PIPING AND REPLACE WITH 4 LF 4" PVC SCH 40 PIPE. TIE INTO EXISTING PIPE, AND CAST OUTLET INTO NEW CURB FACE. COST SHALL BE INCIDENTAL TO CURB REPLACEMENT COST.
- ⑨ PAVEMENT REPAIR PER DTL 5, SHEET 4
- ⑩ REMOVAL AND REPLACEMENT OF CURB AND DRIVEWAY ENTRANCE SHALL BE PERFORMED IN TWO PHASES, SPLIT BETWEEN THE EAST AND WEST HALVES, TO MAINTAIN CONTINUOUS INGRESS AND EGRESS TO THE PROPERTY.

**PAVING NOTES**

- PLANE PAVEMENT, 2" DEEP, FULL WIDTH
- EXCAVATE PAVEMENT REPAIR AREAS ADDITIONAL 3" DEEP
- REPLACE PAVEMENT REPAIR AREAS WITH 3" HMA CL 1/2"
- PAVE 2" HMA CL 1/2" WEARING COURSE (FIBER REINFORCED), FULL WIDTH

**CHANNELIZATION NOTES**

- ① PAINTED DOUBLE YELLOW CENTER LINE WITH TYPE 2YY RPMS PER COK STD PLAN CK-R.31
- ② PAINTED 6" WHITE EDGE LINE PER COK PLAN CK-R.35
- ③ WHITE THERMOPLASTIC STOP BAR PER COK STD PLAN CK-R.28
- ④ WHITE THERMOPLASTIC CROSSWALK PER COK STD PLAN CK-R.28
- ⑤ BLUE TYPE 2B RPM AT FIRE HYDRANT PER STD PLAN CK-R.29
- ⑥ THERMOPLASTIC TRANSVERSE BAR PAVEMENT MARKING PATTERN PER COK STD PLAN CK-R.38
- ⑦ RED PAINT ON TOP AND FACE OF CURB
- ⑧ PAINTED 6" WHITE BROKEN LINE CONSISTING OF 2' STRIPE SEGMENTS AND 6' SPACES
- ⑨ TYPE 3SR TRAFFIC ARROW PER WSDOT STD PLAN M-24.40-02
- ⑩ TYPE 2SL TRAFFIC ARROW PER WSDOT STD PLAN M-24.40-02
- ⑪ 8" WHITE THERMOPLASTIC GORE STRIPE PER COK STD PLAN CK-R.29

5/28/26	0		
DATE	NO.	REVISION	BY



UPI NO.:	FED. AID PROJ. NO.:
SURVEY NO.:	FIELD BOOK(S):
HORZ. DATUM:	VERT. DATUM:
DESIGNED BY: WD	DRAWN BY: FGC

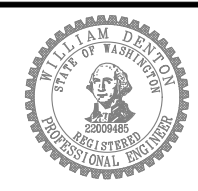

APPROVED BY: \_\_\_\_\_  
DATE: \_\_\_\_\_



CITY OF KIRKLAND  
DEPARTMENT OF PUBLIC WORKS  
123 FIFTH AVENUE, KIRKLAND, WA 98033  
(425) 587-3800 www.kirklandwa.gov

**2026 STREET OVERLAY PROJECT**  
**NE 134TH ST**  
**18+50 TO 22+50**

REFERENCE SHEET NO. PV06  
SHEET 11 OF 23 SHEETS





May 28, 2026 - 2:19 PM - FLAVIO - Z:\2025 PROJECTS\25012 - KIRKLAND 2026 OVERLAYS\PLANS\25012\_P-OVLY-NE 134TH ST.DWG - Layout Name: PV (7)

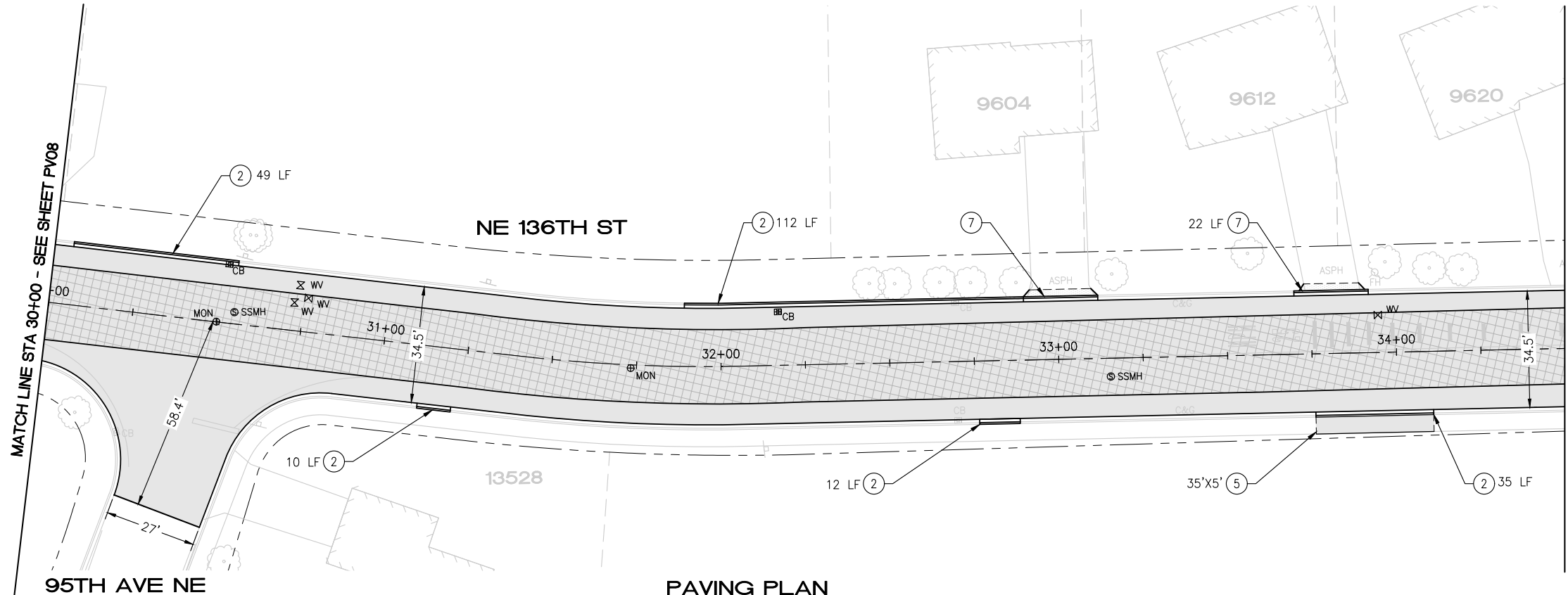

**PAVING PLAN**

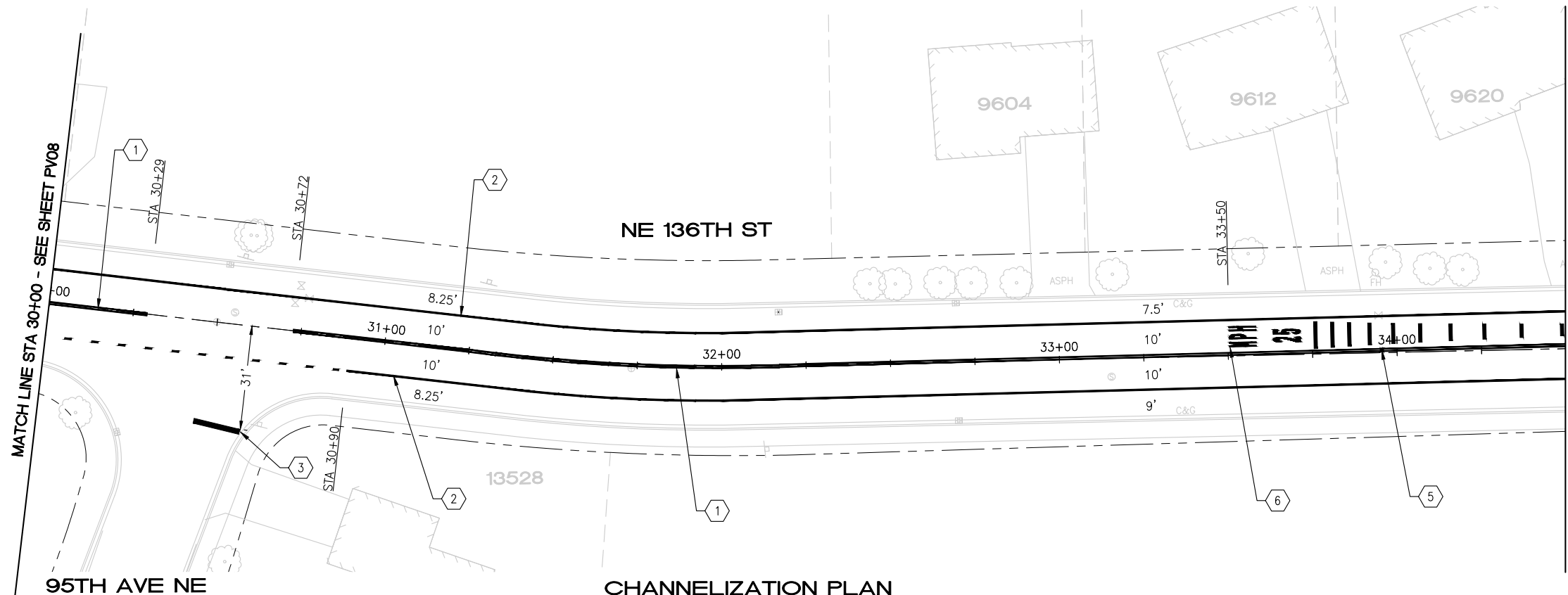

**CHANNELIZATION PLAN**

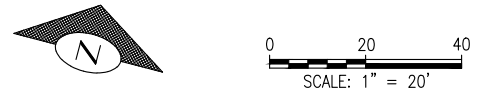

**CONSTRUCTION NOTES**

- ① CURB AND GUTTER ALONG 76 GAS STATION PROPERTY SHALL BE REPLACED IN A MANNER THAT PROVIDES FOR CONTINUOUS AND UNFETTERED USE OF ONE OF THE TWO DRIVEWAY ENTRANCES
- ② REMOVE AND REPLACE CONC CURB AND GUTTER PER COK STD PLAN CK-R.17. SEE DTL 6, SHEET 4 FOR HMA RESTORATION
- ③ INSTALL 6' INDUCTION LOOP TYPE 3 PER WSDOT STD PLANS J-50.12-02 AND J-50.15.01
- ④ REMOVE EXISTING STOP SIGN AND POLE. REPLACE WITH NEW POLE, STREET NAME SIGNS, AND STOP SIGN PER COK STD PLANS CK-R.01 AND CK-R.44.
- ⑤ REMOVE AND REPLACE CONC SIDEWALK PER COK STD PLAN CK-R.23
- ⑥ SAWCUT AND REMOVE 2' ASPH CONC PAVEMENT BEHIND CURB. RESTORE ASPH CONC PAVEMENT TO MATCH EXISTING DEPTH.
- ⑦ RESTORE DRIVEWAY ENTRANCE PER DTL 3, SHEET 4
- ⑧ EXPOSE 4 LF OF YARD DRAIN PIPING AND REPLACE WITH 4 LF 4" PVC SCH 40 PIPE. TIE INTO EXISTING PIPE, AND CAST OUTLET INTO NEW CURB FACE. COST SHALL BE INCIDENTAL TO CURB REPLACEMENT COST.
- ⑨ PAVEMENT REPAIR PER DTL 5, SHEET 4
- ⑩ REMOVAL AND REPLACEMENT OF CURB AND DRIVEWAY ENTRANCE SHALL BE PERFORMED IN TWO PHASES, SPLIT BETWEEN THE EAST AND WEST HALVES, TO MAINTAIN CONTINUOUS INGRESS AND EGRESS TO THE PROPERTY.

**PAVING NOTES**

- PLANE PAVEMENT, 2" DEEP, FULL WIDTH
- EXCAVATE PAVEMENT REPAIR AREAS ADDITIONAL 3" DEEP
- REPLACE PAVEMENT REPAIR AREAS WITH 3" HMA CL 1/2"
- PAVE 2" HMA CL 1/2" WEARING COURSE (FIBER REINFORCED), FULL WIDTH

**CHANNELIZATION NOTES**

- ① PAINTED DOUBLE YELLOW CENTER LINE WITH TYPE 2YY RPMS PER COK STD PLAN CK-R.31
- ② PAINTED 6" WHITE EDGE LINE PER COK PLAN CK-R.35
- ③ WHITE THERMOPLASTIC STOP BAR PER COK STD PLAN CK-R.28
- ④ WHITE THERMOPLASTIC CROSSWALK PER COK STD PLAN CK-R.28
- ⑤ BLUE TYPE 2B RPM AT FIRE HYDRANT PER STD PLAN CK-R.29
- ⑥ THERMOPLASTIC TRANSVERSE BAR PAVEMENT MARKING PATTERN PER COK STD PLAN CK-R.38
- ⑦ RED PAINT ON TOP AND FACE OF CURB
- ⑧ PAINTED 6" WHITE BROKEN LINE CONSISTING OF 2' STRIPE SEGMENTS AND 6' SPACES
- ⑨ TYPE 3SR TRAFFIC ARROW PER WSDOT STD PLAN M-24.40-02
- ⑩ TYPE 2SL TRAFFIC ARROW PER WSDOT STD PLAN M-24.40-02
- ⑪ 8" WHITE THERMOPLASTIC GORE STRIPE PER COK STD PLAN CK-R.29

DATE	NO.	REVISION	BY
5/28/26	0		



UPI NO.:	FED. AID PROJ. NO.:
SURVEY NO.:	FIELD BOOK(S):
HORZ. DATUM:	VERT. DATUM:
DESIGNED BY: WD	DRAWN BY: FGC

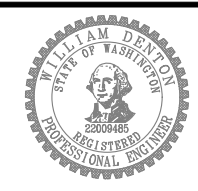

APPROVED BY: \_\_\_\_\_  
DATE: \_\_\_\_\_



CITY OF KIRKLAND  
DEPARTMENT OF PUBLIC WORKS  
123 FIFTH AVENUE, KIRKLAND, WA 98033  
(425) 587-3800 www.kirklandwa.gov

**2026 STREET OVERLAY PROJECT**  
**NE 136TH ST**  
**30+00 TO 34+50**

REFERENCE SHEET NO. PV09  
SHEET 14 OF 23 SHEETS





May 28, 2026 - 2:19 PM - FLAVIO - Z:\2025 PROJECTS\25012 - KIRKLAND 2026 OVERLAY\PLANS\25012\_P-OVLY-NE 134TH ST.DWG - Layout Name: PV (10)

100TH AVE NE

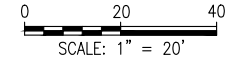

**CONSTRUCTION NOTES**

- ① CURB AND GUTTER ALONG 76 GAS STATION PROPERTY SHALL BE REPLACED IN A MANNER THAT PROVIDES FOR CONTINUOUS AND UNFETTERED USE OF ONE OF THE TWO DRIVEWAY ENTRANCES
- ② REMOVE AND REPLACE CONC CURB AND GUTTER PER COK STD PLAN CK-R.17. SEE DTL 6, SHEET 4 FOR HMA RESTORATION
- ③ INSTALL 6' INDUCTION LOOP TYPE 3 PER WSDOT STD PLANS J-50.12-02 AND J-50.15.01
- ④ REMOVE EXISTING STOP SIGN AND POLE. REPLACE WITH NEW POLE, STREET NAME SIGNS, AND STOP SIGN PER COK STD PLANS CK-R.01 AND CK-R.44.
- ⑤ REMOVE AND REPLACE CONC SIDEWALK PER COK STD PLAN CK-R.23
- ⑥ SAWCUT AND REMOVE 2' ASPH CONC PAVEMENT BEHIND CURB. RESTORE ASPH CONC PAVEMENT TO MATCH EXISTING DEPTH.
- ⑦ RESTORE DRIVEWAY ENTRANCE PER DTL 3, SHEET 4
- ⑧ EXPOSE 4 LF OF YARD DRAIN PIPING AND REPLACE WITH 4 LF 4" PVC SCH 40 PIPE. TIE INTO EXISTING PIPE, AND CAST OUTLET INTO NEW CURB FACE. COST SHALL BE INCIDENTAL TO CURB REPLACEMENT COST.
- ⑨ PAVEMENT REPAIR PER DTL 5, SHEET 4
- ⑩ REMOVAL AND REPLACEMENT OF CURB AND DRIVEWAY ENTRANCE SHALL BE PERFORMED IN TWO PHASES, SPLIT BETWEEN THE EAST AND WEST HALVES, TO MAINTAIN CONTINUOUS INGRESS AND EGRESS TO THE PROPERTY.

**PAVING NOTES**

- PLANE PAVEMENT, 2" DEEP, FULL WIDTH
- EXCAVATE PAVEMENT REPAIR AREAS ADDITIONAL 3" DEEP
- REPLACE PAVEMENT REPAIR AREAS WITH 3" HMA CL 1/2"
- PAVE 2" HMA CL 1/2" WEARING COURSE (FIBER REINFORCED), FULL WIDTH

**CHANNELIZATION NOTES**

- ① PAINTED DOUBLE YELLOW CENTER LINE WITH TYPE 2YY RPMS PER COK STD PLAN CK-R.31
- ② PAINTED 6" WHITE EDGE LINE PER COK PLAN CK-R.35
- ③ WHITE THERMOPLASTIC STOP BAR PER COK STD PLAN CK-R.28
- ④ WHITE THERMOPLASTIC CROSSWALK PER COK STD PLAN CK-R.28
- ⑤ BLUE TYPE 2B RPM AT FIRE HYDRANT PER STD PLAN CK-R.29
- ⑥ THERMOPLASTIC TRANSVERSE BAR PAVEMENT MARKING PATTERN PER COK STD PLAN CK-R.38
- ⑦ RED PAINT ON TOP AND FACE OF CURB
- ⑧ PAINTED 6" WHITE BROKEN LINE CONSISTING OF 2' STRIPE SEGMENTS AND 6' SPACES
- ⑨ TYPE 3SR TRAFFIC ARROW PER WSDOT STD PLAN M-24.40-02
- ⑩ TYPE 2SL TRAFFIC ARROW PER WSDOT STD PLAN M-24.40-02
- ⑪ 8" WHITE THERMOPLASTIC GORE STRIPE PER COK STD PLAN CK-R.29

MATCH LINE STA 42+75 - SEE SHEET PV11

MATCH LINE STA 42+75 - SEE SHEET PV11

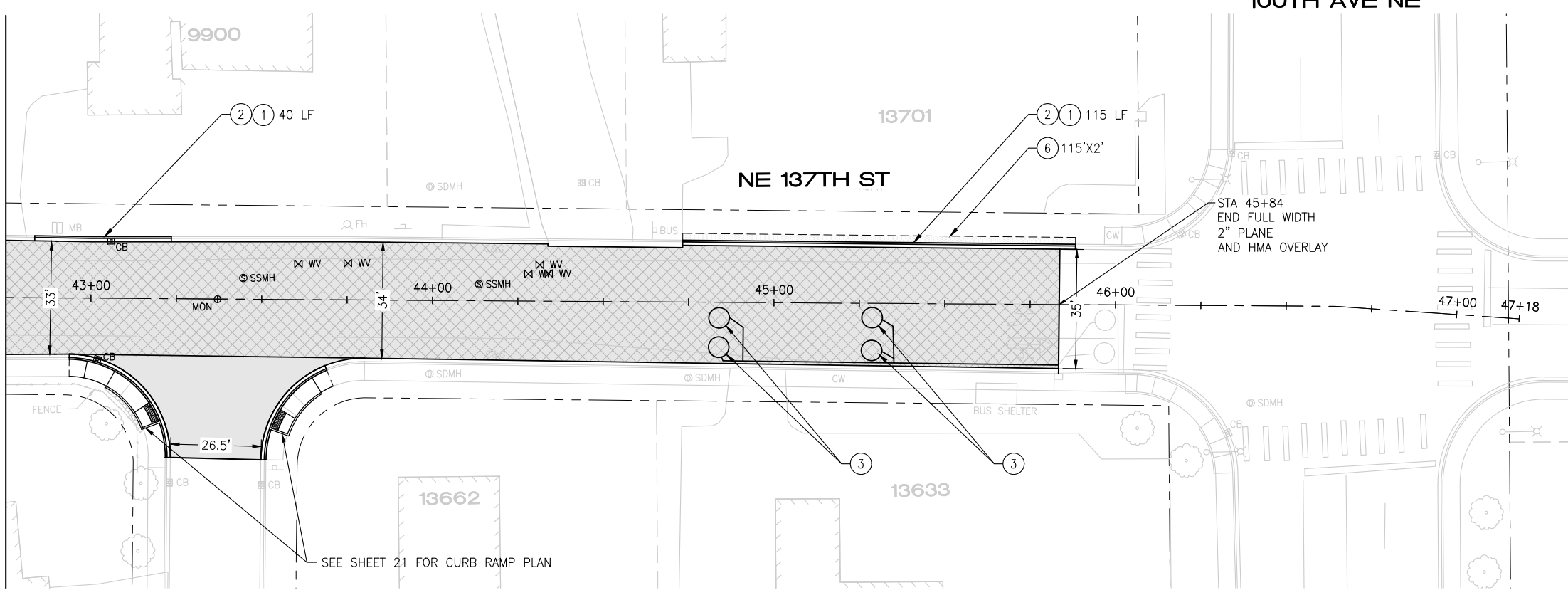

**PAVING PLAN**

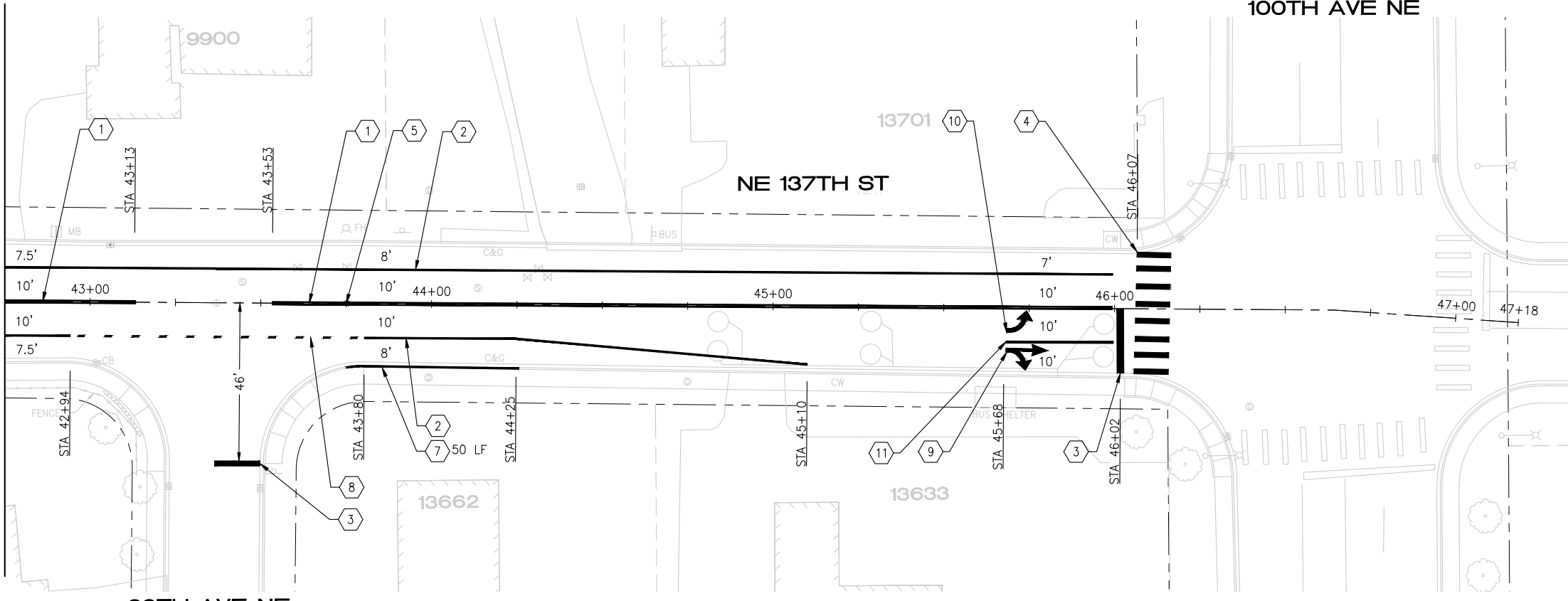

**CHANNELIZATION PLAN**

DATE	NO.	REVISION	BY
5/28/26	0		



UPI NO.:	FED. AID PROJ. NO.:
SURVEY NO.:	FIELD BOOK(S):
HORZ. DATUM:	VERT. DATUM:
DESIGNED BY: WD	DRAWN BY: FGC

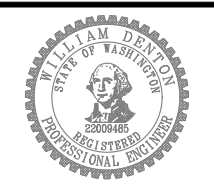

APPROVED BY: \_\_\_\_\_  
DATE: \_\_\_\_\_



CITY OF KIRKLAND  
DEPARTMENT OF PUBLIC WORKS  
123 FIFTH AVENUE, KIRKLAND, WA 98033  
(425) 587-3800 www.kirklandwa.gov

**2026 STREET OVERLAY PROJECT**  
**NE 137TH ST**  
**42+75 TO END**

REFERENCE SHEET NO. PV12  
SHEET 17 OF 23 SHEETS



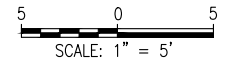

80TH PL NE

15+00

MON

15+83

5 PARALLEL TYPE A

WV X3

WV  
WV

2 6

1 11 12

CONC DWY

CB

11952

NE 120TH ST

**CURB RAMP NOTES**

1. LENGTHS OF FLARES ARE MEASURED FROM INSIDE OF ARC.
2. ALL GRADE BREAKS ARE TO BE RADIAL TO THE ARC FROM WHICH IT EXTENDS AND ARE NOTED "GB" ON THE PLANS.
3. ORIENT CENTERLINE OF ADA DOMES WITH THE CENTER OF THE INTERSECTION WHERE POSSIBLE, UNLESS OTHERWISE DIRECTED BY ENGINEER.
4. RUNNING AND CROSS SLOPES OF ALL RAMP FLARES SHALL MEET ADA REQUIREMENTS.
5. RAMP FLARES LONGER THAN 10LF SHALL HAVE TOOL JOINT AT THE MIDPOINT OF THE FLARE.
6. FLARES AT CURB AND GUTTER LONGER THAN 10LF SHALL HAVE FULL DEPTH EXPANSION JOINT AT MIDPOINT OF LENGTH.
7. DETECTABLE WARNING SURFACE SHALL SPAN THE FULL WIDTH OF THE LANDING AT BACK OF CURB.
8. CUTTING OF THE DETECTABLE WARNING SURFACE MAY BE REQUIRED.
9. SEE CONTRACT SPECIFICATIONS FOR LANDSCAPE AREAS.

**CURB RAMP CONSTRUCTION NOTES**

- 1 REMOVE CURB AND GUTTER
- 2 REMOVE CEM CONC SIDEWALK
- 3 NOT USED
- 4 CONC CURB AND GUTTER PER COK STD PLAN CK-R.17
- 5 CONSTRUCT CEM CONC PARALLEL CURB RAMP PER WSDOT STD PLAN F-40.12-03. USE DEPRESSED CONC CURB AND GUTTER WSDOT STD PLAN F-10.12-04
- 6 CEM CONC SIDEWALK PER COK STD PLAN CK-R.23
- 7 REMOVE/RELOCATE SIGN POST AND BASE PER COK STD PLAN CK-R.43
- 8 CONSTRUCT CEM CONC PEDESTRIAN CURB, PER WSDOT STD PLAN F-40.12-03, 1' HEIGHT
- 9 REMOVE ROCKS
- 10 REMOVE TREE AND GRIND STUMP
- 11 CONSTRUCT ROLLED CURB TRANSITION PER DTL 2, SHEET 4
- 12 CONC ROLLED CURB PER COK STD PLAN CK-R.17D
- 13 EXISTING SIGN TO REMAIN

**CURB RAMP LEGEND**

- CEM CONC WORK
- SAWCUT, FULL DEPTH
- DETECTABLE WARNING SURFACE PER WSDOT STD PLAN F-45.10
- TURF/SEEDED LAWN

**80TH PL NE AND NE 120TH ST (SE CORNER) CURB RAMP PLAN**

SCALE: 1"=5'

May 28, 2026 - 2:20 PM - FLAVIO - Z:\2025 PROJECTS\25012 - KIRKLAND 2026 OVERLAY\PLANS\25012\_P-RAMP.DWG - Layout Name: PLAN (2)

DATE	NO.	REVISION	BY
4/17/26	0		



UPI NO.:	FED. AID PROJ. NO.:
SURVEY NO.:	FIELD BOOK(S):
HORZ. DATUM:	VERT. DATUM:
DESIGNED BY: WD	DRAWN BY: FGC



APPROVED BY: \_\_\_\_\_  
DATE: \_\_\_\_\_



CITY OF KIRKLAND  
DEPARTMENT OF PUBLIC WORKS  
123 FIFTH AVENUE KIRKLAND, WA 98033  
(425) 587-3800 www.kirklandwa.gov

**2026 STREET OVERLAY PROJECT**

**80TH PL NE AND NE 120TH ST CURB RAMP**

REFERENCE SHEET NO.	CR02
SHEET OF SHEETS	19 OF 23



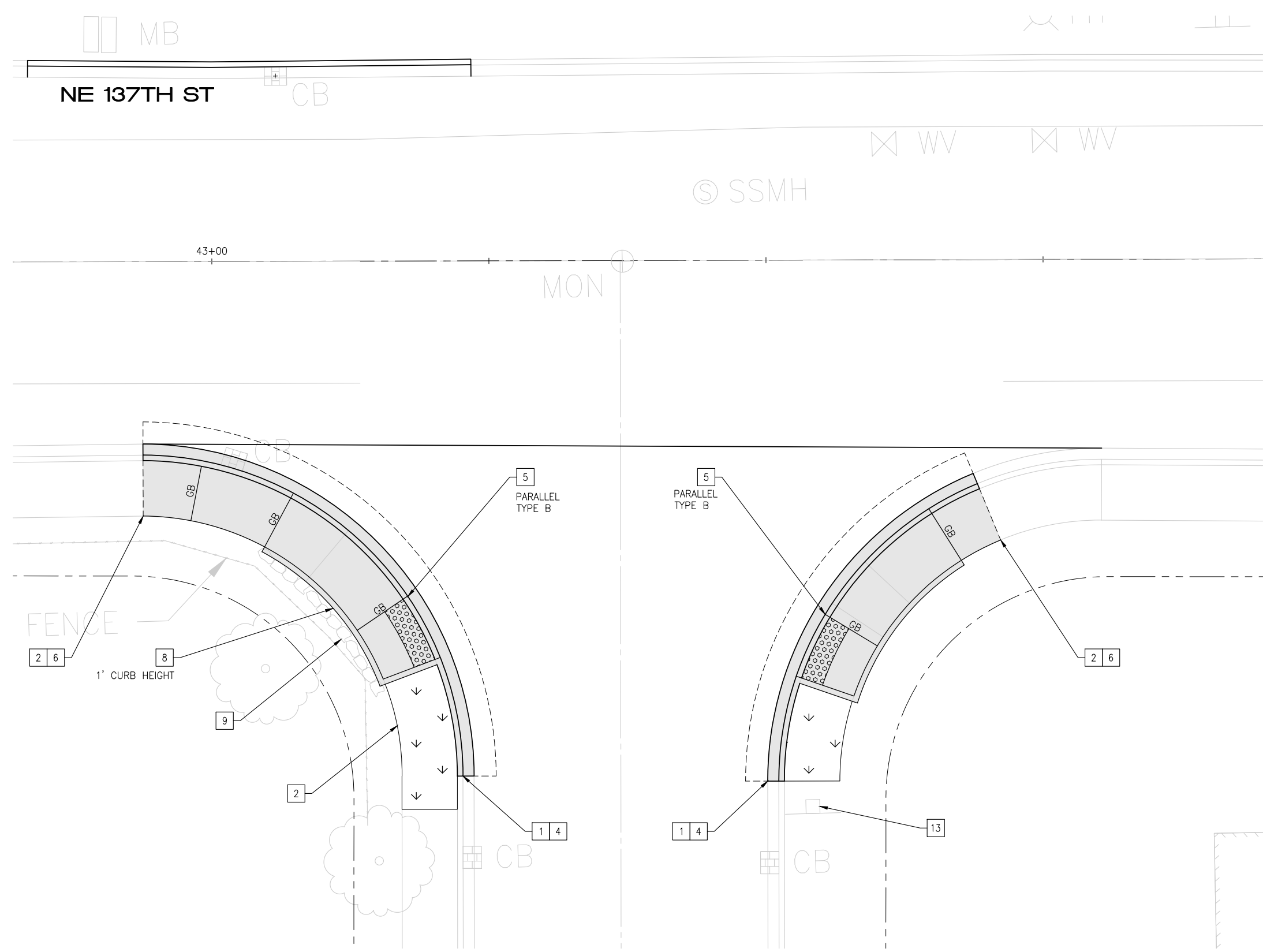

**CURB RAMP NOTES**

1. LENGTHS OF FLARES ARE MEASURED FROM INSIDE OF ARC.
2. ALL GRADE BREAKS ARE TO BE RADIAL TO THE ARC FROM WHICH IT EXTENDS AND ARE NOTED "GB" ON THE PLANS.
3. ORIENT CENTERLINE OF ADA DOMES WITH THE CENTER OF THE INTERSECTION WHERE POSSIBLE, UNLESS OTHERWISE DIRECTED BY ENGINEER.
4. RUNNING AND CROSS SLOPES OF ALL RAMP FLARES SHALL MEET ADA REQUIREMENTS.
5. RAMP FLARES LONGER THAN 10LF SHALL HAVE TOOL JOINT AT THE MIDPOINT OF THE FLARE.
6. FLARES AT CURB AND GUTTER LONGER THAN 10LF SHALL HAVE FULL DEPTH EXPANSION JOINT AT MIDPOINT OF LENGTH.
7. DETECTABLE WARNING SURFACE SHALL SPAN THE FULL WIDTH OF THE LANDING AT BACK OF CURB.
8. CUTTING OF THE DETECTABLE WARNING SURFACE MAY BE REQUIRED.
9. SEE CONTRACT SPECIFICATIONS FOR LANDSCAPE AREAS.

**CURB RAMP CONSTRUCTION NOTES**

- 1 REMOVE CURB AND GUTTER
- 2 REMOVE CEM CONC SIDEWALK
- 3 NOT USED
- 4 CONC CURB AND GUTTER PER COK STD PLAN CK-R.17
- 5 CONSTRUCT CEM CONC PARALLEL CURB RAMP PER WSDOT STD PLAN F-40.12-03. USE DEPRESSED CONC CURB AND GUTTER WSDOT STD PLAN F-10.12-04
- 6 CEM CONC SIDEWALK PER COK STD PLAN CK-R.23
- 7 REMOVE/RELOCATE SIGN POST AND BASE PER COK STD PLAN CK-R.43
- 8 CONSTRUCT CEM CONC PEDESTRIAN CURB, PER WSDOT STD PLAN F-40.12-03, 1' HEIGHT
- 9 REMOVE ROCKS
- 10 REMOVE TREE AND GRIND STUMP
- 11 CONSTRUCT ROLLED CURB TRANSITION PER DTL 2, SHEET 4
- 12 CONC ROLLED CURB PER COK STD PLAN CK-R.17D
- 13 EXISTING SIGN TO REMAIN

**CURB RAMP LEGEND**

- CEM CONC WORK
- SAWCUT, FULL DEPTH
- DETECTABLE WARNING SURFACE PER WSDOT STD PLAN F-45.10
- TURF/SEEDED LAWN

**NE 137TH ST AND 99TH AVE NE CURB RAMP PLAN**

SCALE: 1"=5'

May 28, 2026 - 2:20 PM - FLAVIO - Z:\2025 PROJECTS\25012 - KIRKLAND 2026 OVERLAY\PLANS\25012\_P-RAMP.DWG - Layout Name: PLAN (3)

DATE	NO.	REVISION	BY
4/17/26	0		



UPI NO.:	FED. AID PROJ. NO.:
SURVEY NO.:	FIELD BOOK(S):
HORZ. DATUM:	VERT. DATUM:
DESIGNED BY: WD	DRAWN BY: FGC

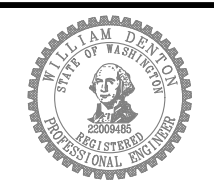

APPROVED BY: \_\_\_\_\_  
DATE: \_\_\_\_\_



CITY OF KIRKLAND  
DEPARTMENT OF PUBLIC WORKS  
123 FIFTH AVENUE KIRKLAND, WA 98033  
(425) 587-3800 www.kirklandwa.gov

**2026 STREET OVERLAY PROJECT**

**NE 137TH ST AND 99TH AVE NE CURB RAMPS**

REFERENCE SHEET NO.	CR04
SHEET OF SHEETS	21 OF 23

May 28, 2026 - 2:20 PM - FLAVIO - Z:\2025 PROJECTS\25012 - KIRKLAND 2026 OVERLAY\PLANS\25012\_P\_TCP-NE 134TH ST.DWG - Layout Name: 23 TC03

BUFFER DATA											
LONGITUDINAL BUFFER SPACE = B											
SPEED (MPH)	25	30	35	40	45	50	55	60	65	70	
LENGTH (feet)	155	200	250	305	360	425	495	570	645	730	
TRANSPORTABLE ATTENUATOR ROLL AHEAD DISTANCE = R											
HOST VEHICLE WEIGHT 9,900 TO 22,000 lbs.			HOST VEHICLE WEIGHT > 22,000 lbs.								
< 45 MPH	45-55 MPH	> 55 MPH	< 45 MPH	45-55 MPH	> 55 MPH	< 45 MPH	45-55 MPH	> 55 MPH	< 45 MPH	45-55 MPH	> 55 MPH
100'	123'	172'	74'	100'	150'						
PROTECTIVE VEHICLE (WORK VEHICLE) = R											
NO SPECIFIED DISTANCE REQUIRED											

SIGN SPACING = X (1)		
RURAL HIGHWAYS	60 / 65 MPH	800'
RURAL ROADS	45 / 55 MPH	500'
RURAL ROADS & URBAN ARTERIALS	35 / 40 MPH	350'
RURAL ROADS & URBAN ARTERIALS RESIDENTIAL & BUSINESS DISTRICTS	25 / 30 MPH	200' (2)
URBAN STREETS	25 MPH OR LESS	100' (2)

(1) ALL SPACING MAY BE ADJUSTED TO ACCOMMODATE INTERCHANGE RAMP, AT-GRADE INTERSECTIONS AND DRIVEWAYS.  
(2) THIS SPACING MAY BE REDUCED IN URBAN AREAS TO FIT ROADWAY CONDITIONS.

MINIMUM TAPER LENGTH = L (feet)										
LANE WIDTH (feet)	Posted Speed (mph)									
	25	30	35	40	45	50	55	60	65	70
10	105	150	205	270	450	500	550	-	-	-
11	115	165	225	295	495	550	605	660	-	-
12	125	180	245	320	540	600	660	720	780	-

CHANNELIZATION DEVICE SPACING (feet)		
MPH	TAPER	TANGENT
50/60	40	80
35/45	30	60
25/30	20	40

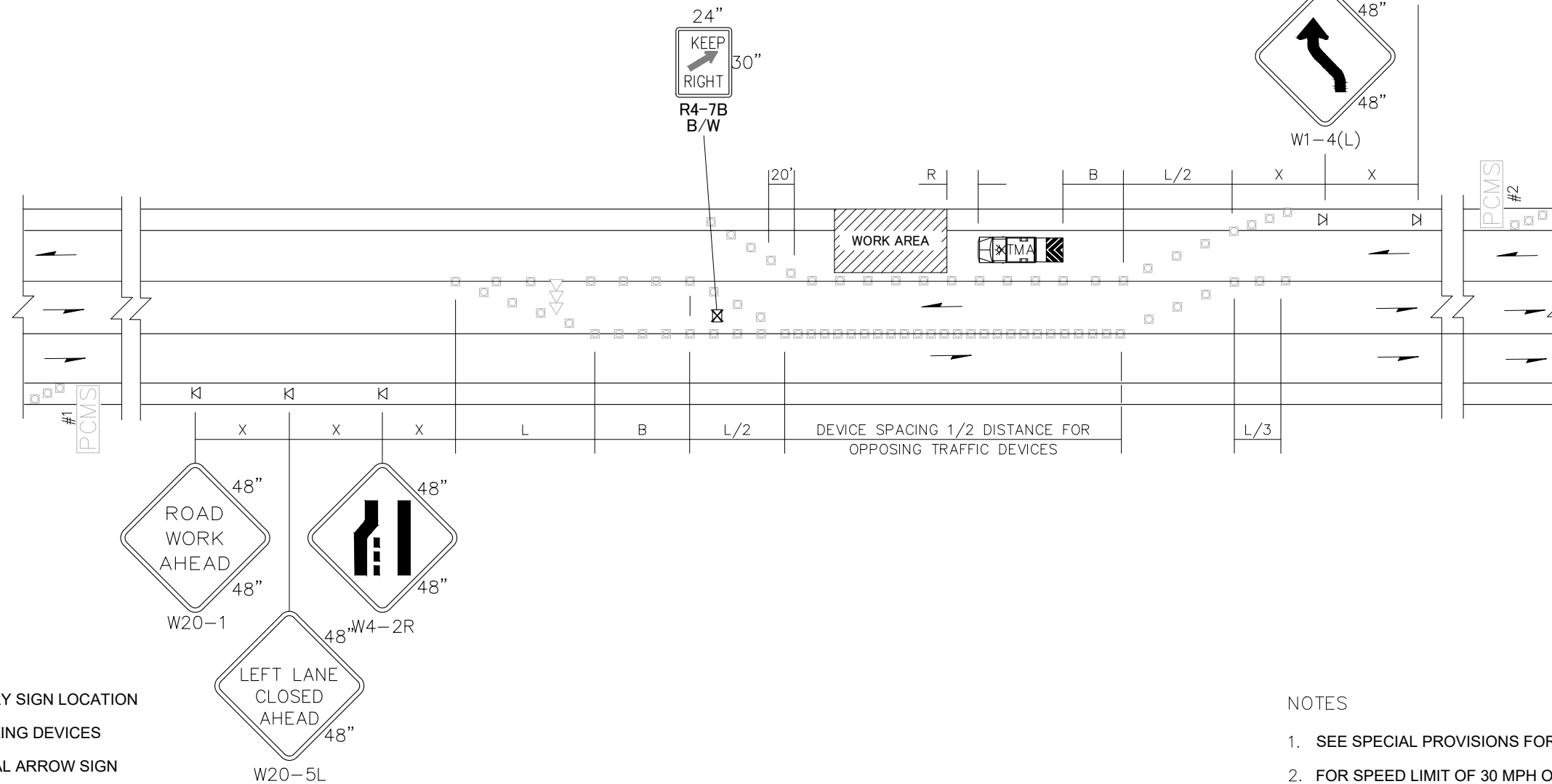

PCMS #1	
1	2
LEFT LANE CLOSURE	1 MILE AHEAD
2.0 SEC	2.0 SEC

FIELD LOCATE IN ADVANCE OF TEMPORARY SIGNS.

PCMS #2	
1	2
LANE SHIFTS LEFT	1 MILE AHEAD
2.0 SEC	2.0 SEC

FIELD LOCATE IN ADVANCE OF TEMPORARY SIGNS.

### LANE SHIFT - THREE LANE ROADWAY

NOT TO SCALE

#### NOTES

- SEE SPECIAL PROVISIONS FOR WORK HOUR RESTRICTIONS.
- FOR SPEED LIMIT OF 30 MPH OR LESS, USE SIGN W1-3 IN LIEU OF SIGN W1-4.
- RECOMMENDED EXTENDING DEVICE TAPER (L/3) ACROSS SHOULDER.
- ALL SIGNS ARE BLACK ON ORANGE UNLESS OTHERWISE DESIGNATED.

DATE	NO.	REVISION	BY
5/28/26	0		



UPI NO.:	FED. AID PROJ. NO.:
SURVEY NO.:	FIELD BOOK(S):
HORZ. DATUM:	VERT. DATUM:
DESIGNED BY: WD	DRAWN BY: EAS

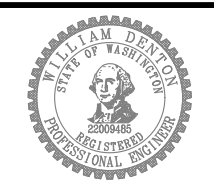

APPROVED BY: \_\_\_\_\_  
DATE: \_\_\_\_\_



**2026 STREET OVERLAY PROJECT**  
**TRAFFIC CONTROL DETAILS**

REFERENCE SHEET NO. TC01  
SHEET 22 OF 23 SHEETS

NOTES:

- 9. FOR LEGEND, TABLES, AND ADDITIONAL NOTES: SEE TC420, SHEET 1.
- 10. WORK MAY BRIEFLY OCCUR WITHIN LANE CLOSURE ACROSS INTERSECTING ROADWAY APPROACHES, BUSINESS ACCESSES, OR DRIVEWAYS. MAY HOLD APPROACH OR ACCESS TRAFFIC FOR 5 MINUTES OR LESS (ENGINEER MAY ACCEPT HOLDS UP TO 10 MINUTES) WHILE RESTRICTING TURNS FROM MAINLINE. CHANNELIZATION DEVICES DELINEATING APPROACH OR ACCESS MAY BE REMOVED OR RELOCATED AS NEEDED.
- 11. SINGLE FLAGGER (WITH RED FLAG/ RED GLOW CONE FLASHLIGHT) MAY BE ADDED TO THE INTERSECTING ROADWAY APPROACH TO HELP GUIDE ALTERNATING & TURNING TRAFFIC.

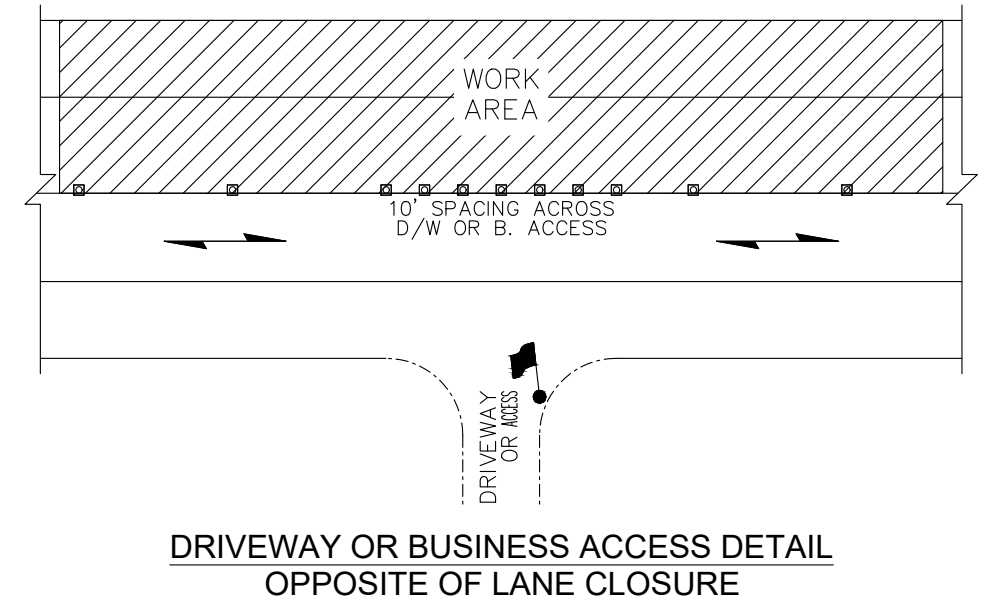
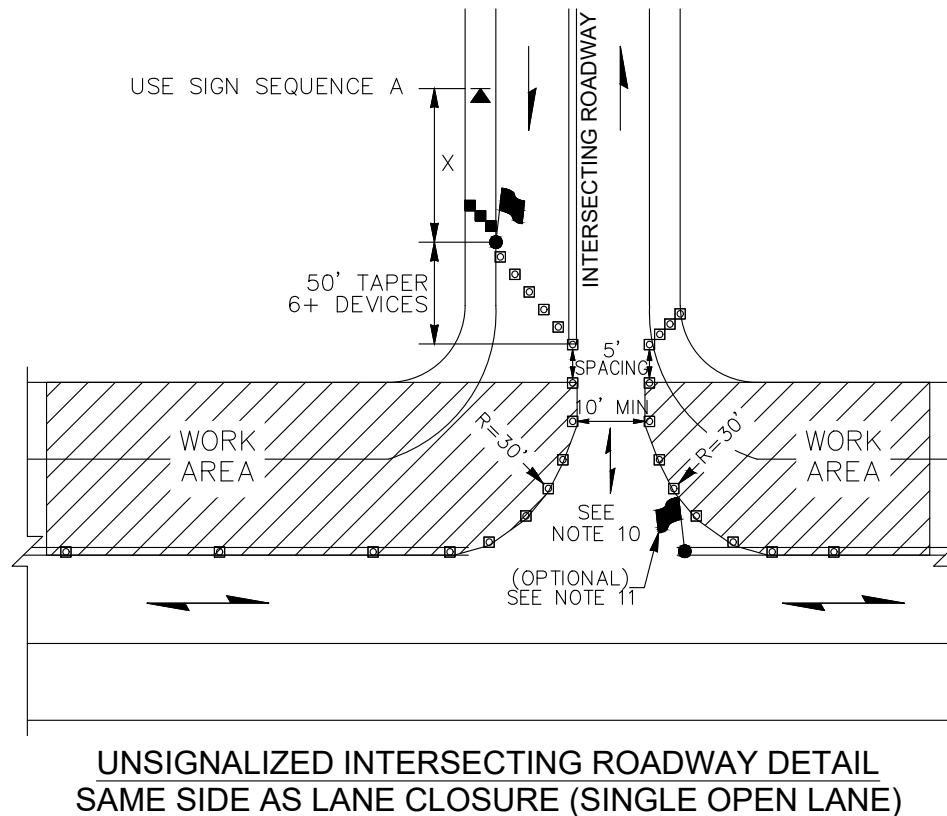
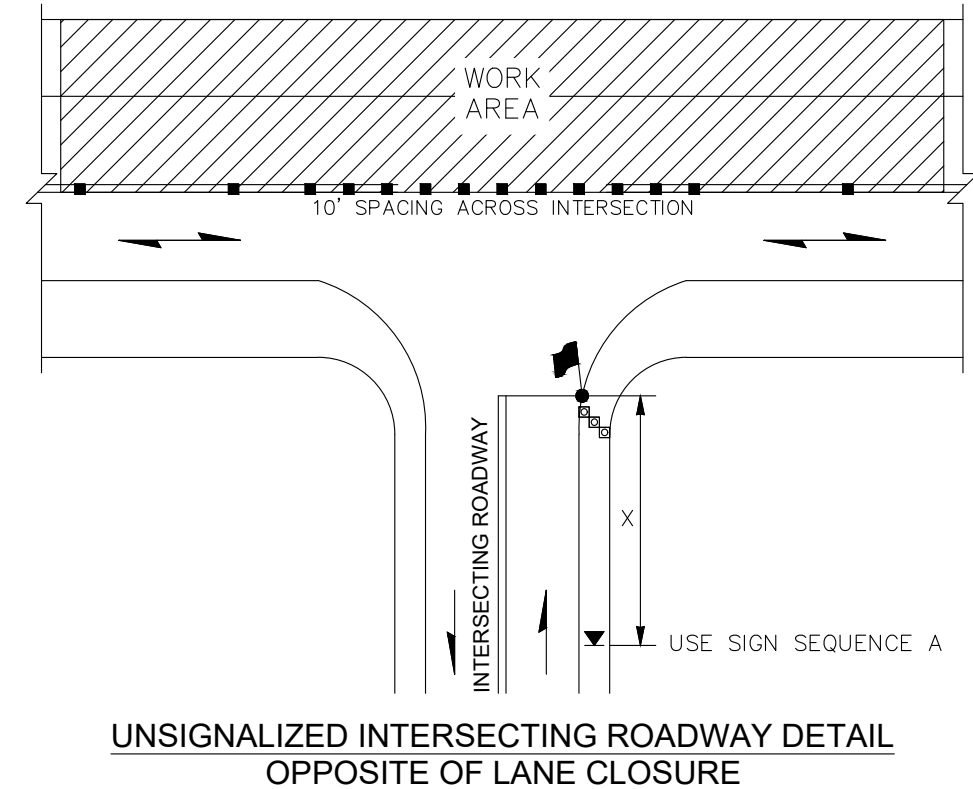
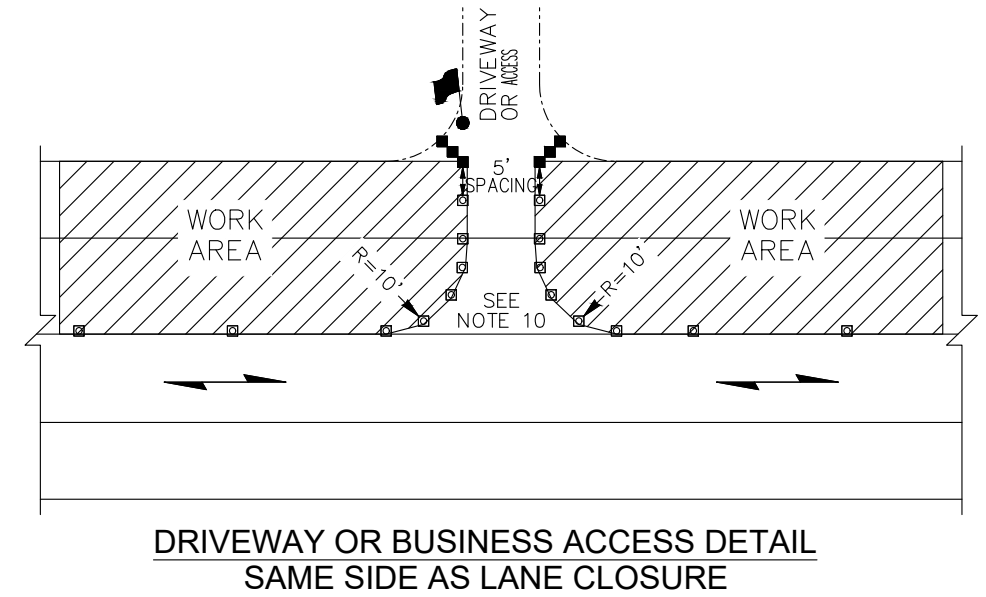
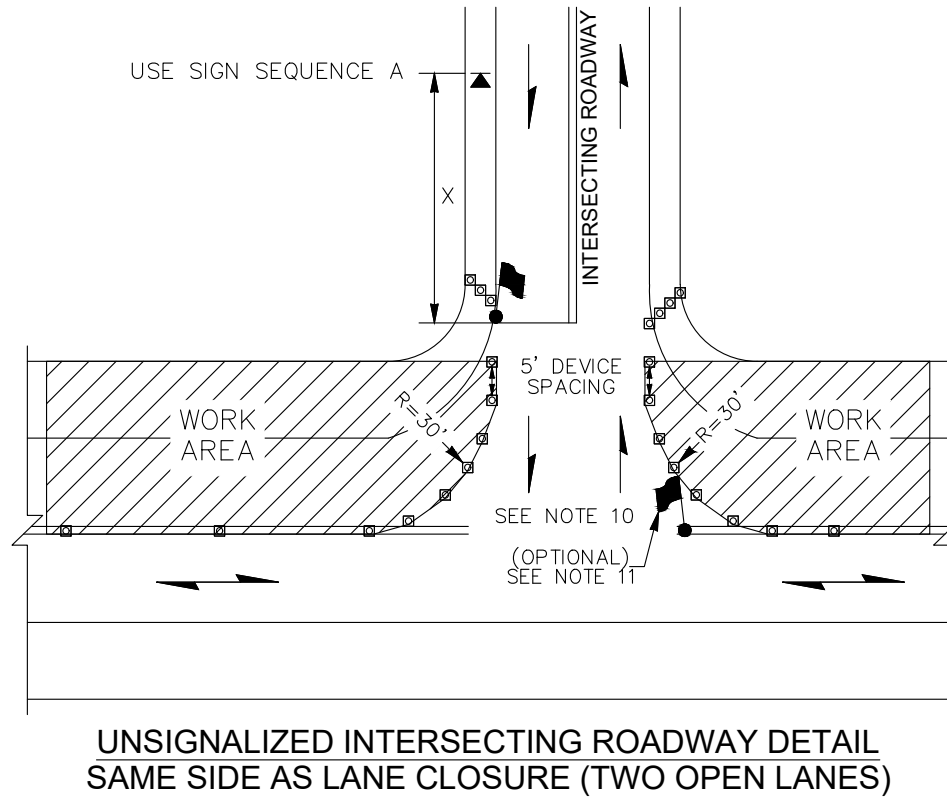
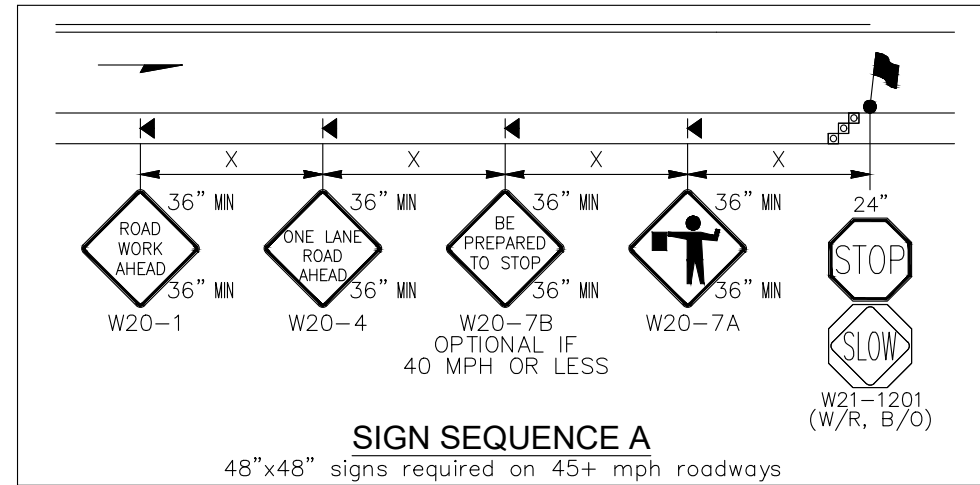

**ALTERNATING 1-LANE, 2-WAY TRAFFIC: FLAGGER-CONTROLLED (HIGHWAYS, 40 MPH OR LESS)**

May 28, 2026 - 2:20 PM - FLAVIO - Z:\2025 PROJECTS\25012 - KIRKLAND 2026 OVERLAY\PLANS\25012\_P-TCP-NE 134TH ST.DWG - Layout Name: 25 TC05

5/28/26	0		
DATE	NO.	REVISION	BY



UPI NO.:	FED. AID PROJ. NO.:
SURVEY NO.:	FIELD BOOK(S):
HORZ. DATUM:	VERT. DATUM:
DESIGNED BY: WD	DRAWN BY: EAS

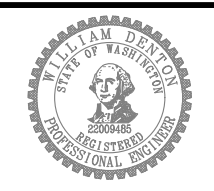

APPROVED BY:
DATE:



**2026 STREET OVERLAY PROJECT**  
**TRAFFIC CONTROL DETAILS**

REFERENCE SHEET NO. TC02
SHEET 23 OF 23 SHEETS