

PLAN

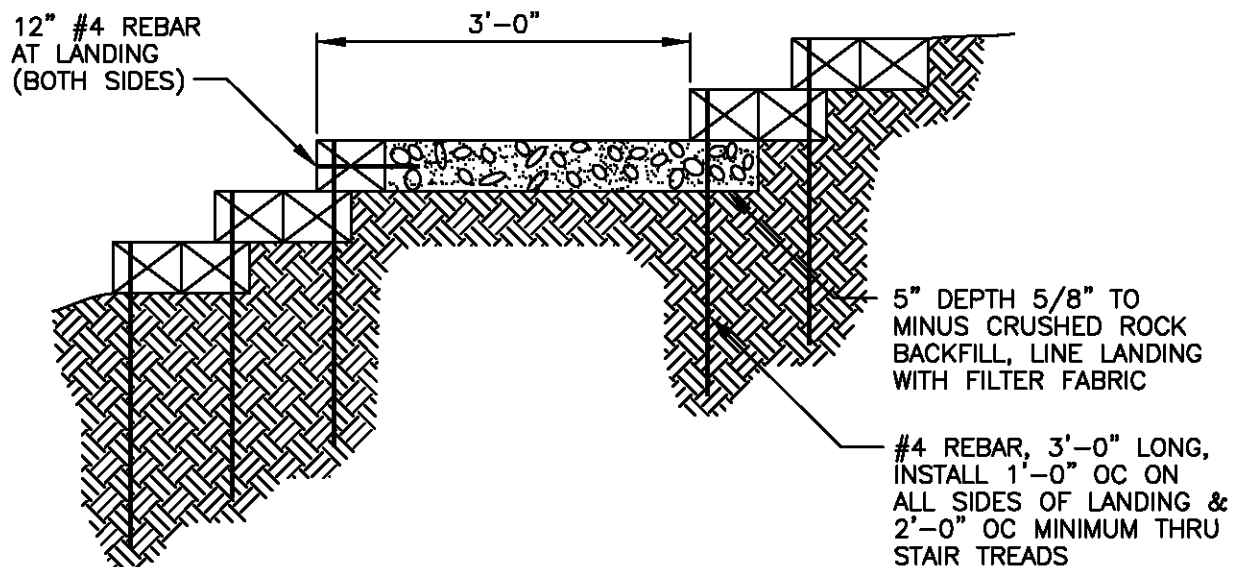

SECTION A-A

NOTES

1. ALL WOOD SHALL BE 'HEM-FIR', #2 OR BETTER (WITH ROUGH-SAWN WALKING SURFACE).
2. ALL WOOD ACZA PRESSURE-TREATED PER LP-22, 0.6 RETENTION OR AS APPROVED BY CITY.

CITY OF KIRKLAND

PLAN NO. CK-R.59



TIMBER STAIRS
LANDING