

APPLICANT: MALENE MCRESIDENT
 123 5TH AVENUE
 KIRKLAND, WA 98033
 (425) 587-3900

LAST REVISED: 01/2020

PROJECT PARCEL NO.= 8203910999
 PROJECT ADDRESS= 123 5TH AVENUE
 KIRKLAND, WA 98033
 SECTION/TOWNSHIP/RANGE: 32-27-08

LOT AREA: ___ S.F.
 TOTAL AREA DISTURBED: ___ S.F.

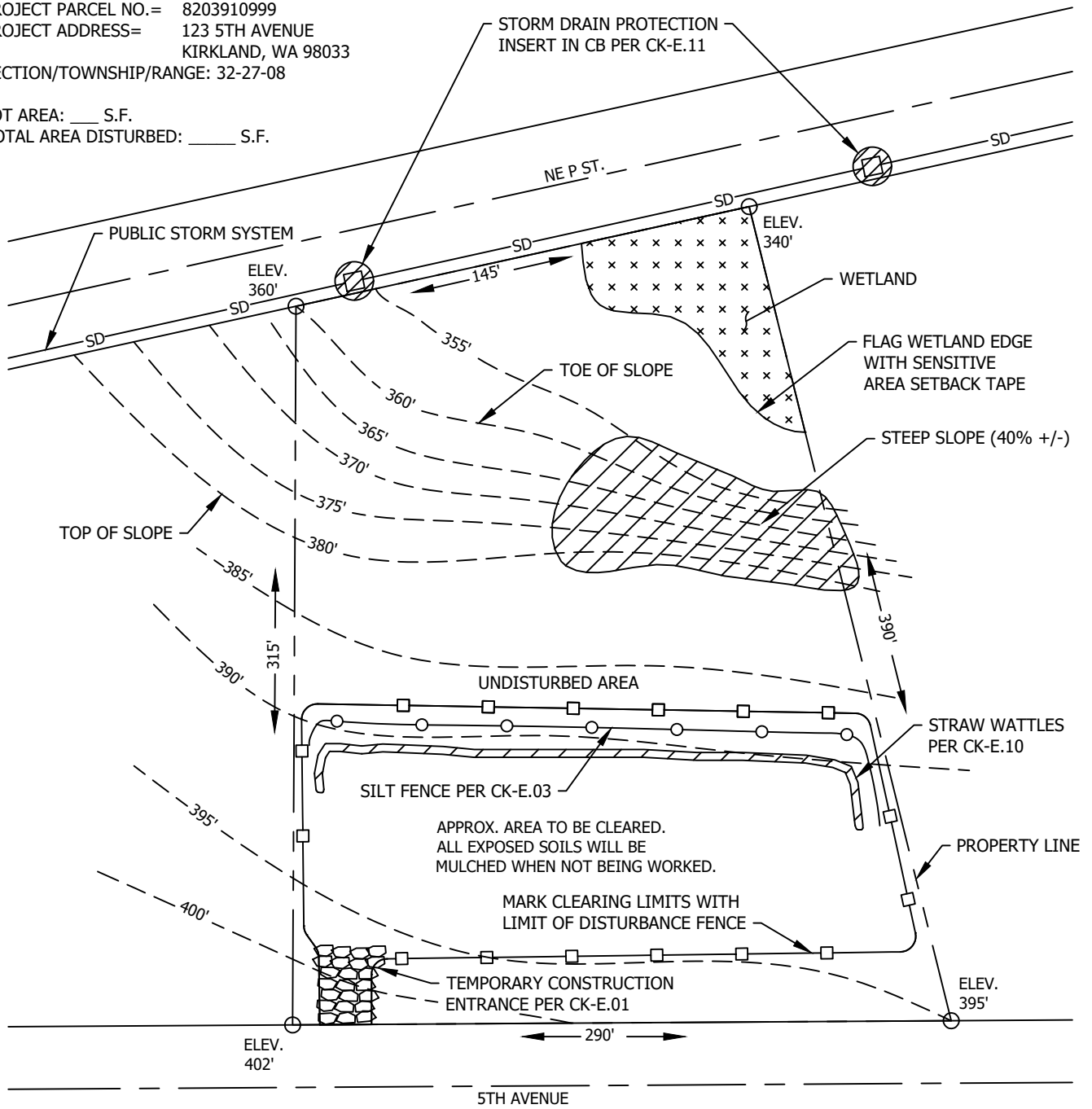

EXAMPLE TESC PLAN FOR A SMALL SINGLE FAMILY RESIDENCE PROJECT ONLY

NOTES

1. IDENTIFY ALL SENSITIVE AREAS (EROSION AREAS, STEEP SLOPES, LANDSLIDE HAZARD AREAS, LAKES, STREAMS, WETLANDS).
2. REFER TO THE CURRENT VERSION OF KING COUNTY SURFACE WATER DESIGN MANUAL, CORE REQUIREMENT #5 FOR ESC STANDARDS ADOPTED BY THE CITY OF KIRKLAND. REFER TO CITY OF KIRKLAND POLICIES FOUND WITHIN THE EROSION AND SEDIMENT CONTROL PRE-APPROVED PLANS.

CITY OF KIRKLAND	
PLAN NO. CK-E.04	
	EXAMPLE TEMP. EROSION & SEDIMENT CONTROL PLAN